



## Shared components: Actuator 16A+current and RCBO-sensor

---

### 01456

Smart systems&products / By-me Plus / Shared components / DIN devices

#### Actuator 16A+current and RCBO-sensor

Actuator with relay output 16 A 120-230 V~ 50/60 Hz with incorporated current sensor, 1 input channel for toroidal differential current sensor, installation on DIN rail (60715 TH35), occupies 1 x 17.5 mm module. Supplied without toroidal differential current sensor.



#### Product Status

3 - Active

#### Minimum order quantity

1 NR

#### Sheets, Manuals, Documentation

- [Multilanguage instructions sheet \(1910 kb\)](#)
- [By-me automation-fw Compatibility \(206 kb\)](#)

#### Video

- [Three-phase load control system with pho](#)
- [Single-phase load control system with ph](#)
- [Energy control](#)

## Drawings

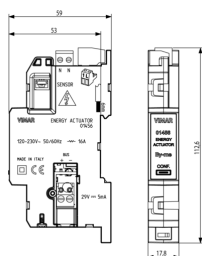

Space view

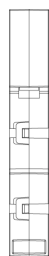

Backside view

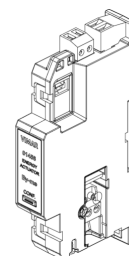

3D View

## Gallery



## Technical data

- **Class group:** Installation bus systems
- **Class:** Switch actuator for bus system
- **Bus system KNX:** No
- **Bus system KNX-RF (Radio Frequent):** No
- **Bus system radio frequent:** No
- **Bus system LON:** No
- **Bus system Powernet:** No
- **Other bus systems:** Other
- **Radio frequent bidirectional:** No
- **Mounting method:** Other
- **Width in number of modular spacings:** 1
- **Local operation/hand operation:** No
- **With LED indication:** Yes
- **Max. switching power:** 0 W
- **Suitable for C-load:** No
- **Max. number of switching contacts:** 1
- **Rated current:** 16 A
- **Rated operating voltage:** 120,00 - 230,00 V
- **Different phases connectable:** No
- **With bus connection:** Yes
- **Bus module detachable:** Yes
- **Modular expandability:** No
- **Degree of protection (IP):** IP20

## Certifications

- 00. CE Marking - EU
- 37. Marking - Morocco
- 43. UKCA mark - Great Britain
- 96. Electrotechnical expert ([download](#))
- 99. WEEE Directive ([download](#))

# Packaging



**Code** 8007352493612  
**Quantity** 1 NR  
**Dim.** 14.2x6.7x5.9 [cm]  
**Weight** 107.8 [g]

# Legal

Vimar reserves the right to change at any time and without notice the characteristics of the products reported. Installation should be carried out by qualified staff in compliance with the current regulations regarding the installation of electrical equipment in the country where the products are installed. For the terms of use of the information on the product info sheet see [Conditions of Use](#).