



## Shared components: Domotic logic unit

---

### 01468

Smart systems&products / By-me Plus / Shared components / DIN devices

### Domotic logic unit

Unit for implementing logic, mathematical, timing and messaging functions, installation on DIN rails (60715 TH35), for By-me home automation, configurable only with EasyTool Professional, occupies 1 module size 17.5 mm

### Product Status

3 - Active

### Minimum order quantity

1 NR

### Sheets, Manuals, Documentation

- [Multilanguage instructions sheet \(487 kb\)](#)
- [Manuale installatore \(17947 kb\)](#)
- [Installer manual \(15305 kb\)](#)
- [By-me automation-fw Compatibility \(206 kb\)](#)

### Video

- [Clima2 01468](#)
- [Clima1 01468](#)



## Drawings

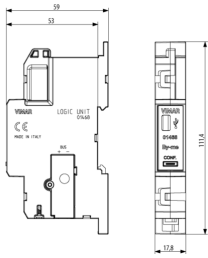

Space view



Backside view

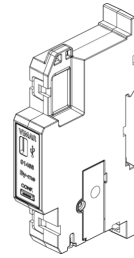

3D View

## Gallery



## Technical data

- **Class group:** Installation bus systems
- **Class:** Logic component for bus system
- **Bus system KNX:** No
- **Bus system KNX-RF (Radio Frequent):** No
- **Bus system radio frequent:** No
- **Bus system LON:** No
- **Bus system Powernet:** No
- **Other bus systems:** Other
- **Mounting method:** Other
- **Width in number of modular spacings:** 1
- **With bus connection:** Yes
- **Logic object:** Yes

## Certifications

- 00. CE Marking - EU
- 19. NOM - Mexico
- 37. Marking - Morocco
- 43. UKCA mark - Great Britain
- 92. RoHS UAE
- 96. Electrotechnical expert ([download](#))
- 99. WEEE Directive ([download](#))

# Packaging



**Code** 8007352512115  
**Quantity** 1 NR  
**Dim.** 14.2x6.7x5.9 [cm]  
**Weight** 86.8 [g]

# Legal

Vimar reserves the right to change at any time and without notice the characteristics of the products reported. Installation should be carried out by qualified staff in compliance with the current regulations regarding the installation of electrical equipment in the country where the products are installed. For the terms of use of the information on the product info sheet see [Conditions of Use](#).