



NEVE UP: Vertical frame 2centralM+screws

09607

Wiring devices / Traditional wiring devices / NEVE UP / Mounting frames

Vertical frame 2centralM+screws

2-central-module frame for vertical mounting, with screws, for 3-module mounting boxes or boxes with 60 mm fixing centres

Product Status

3 - Active

Minimum order quantity

10 NR



You may also be interested in



07935.1 - Screw for frame
fixing - 24mm



07937 - Screw for frame
fixing - 35mm



07939 - Screw for frame
fixing - 50 mm



09613 - Frame 3M +screws

Drawings

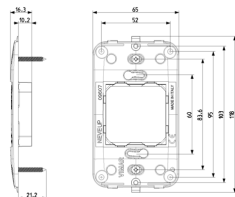

Space view

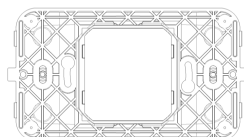

Backside view



3D View



Technical data

- **Class group:** Domestic switching devices
- **Class:** Holder for modular domestic switching devices
- **Model:** Flush-mounted
- **Mounting method:** Mounting with screw
- **Mounting method of the module inserts:** Front side
- **Mounting direction:** Horizontal and vertical
- **Number of modules horizontal (module system):** 2
- **Number of modules vertical (module system):** 1
- **With built-in installation box:** No
- **With screws:** Yes
- **Suitable for mounting in round junction box 60 mm:** No
- **Flush-mounted installation:** Yes
- **Suitable for subfloor installation duct box:** No
- **Suitable for wall duct:** No
- **Suitable for mounting on DIN-rail 35 mm:** No
- **Material:** Plastic
- **Material quality:** Thermoplastic

Certifications

- 00. CE Marking - EU
- 29. QCERT - Colombia
- 43. UKCA mark - Great Britain
- 96. Electrotechnical expert ([download](#))

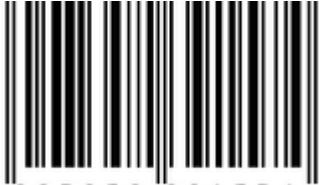
Packaging

		
8 007352 391574	8 007352 391581	8 007352 391598
Code 8007352391574	Code 8007352391581	Code 8007352391598
Quantity 1 NR	Quantity 10 NR	Quantity 200 NR
Dim. 11.8x6.5x1.7 [cm]	Dim. 11.8x6.5x17 [cm]	Dim. 35x33.5x24.5 [cm]
Weight 23.31 [g]	Weight 233.1 [g]	Weight 4,662 [g]

Legal

Vimar reserves the right to change at any time and without notice the characteristics of the products reported. Installation should be carried out by qualified staff in compliance with the current regulations regarding the installation of electrical equipment in the country where the products are installed. For the terms of use of the information on the product info sheet see [Conditions of Use](#).