



PLANA: Frame 2M for RF device white

14507

Smart systems&products / Smart switch&sound / PLANA / Mounting frames

Frame 2M for RF device white

Frame 2M for RF device white

Product Status

3 - Active

Minimum order quantity

10 NR

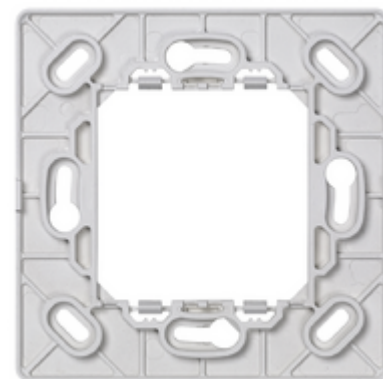

Drawings

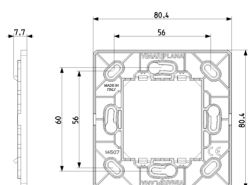

Space view

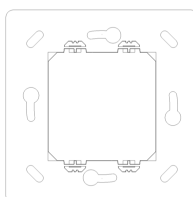

Backside view

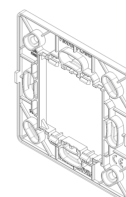

3D View

Technical data

- **Class group:** Domestic switching devices
- **Class:** Holder for modular domestic switching devices
- **Model:** Flush-mounted
- **Mounting method:** Mounting with screw
- **Mounting method of the module inserts:** Front side
- **Mounting direction:** Horizontal and vertical
- **Number of modules horizontal (module system):** 2
- **Number of modules vertical (module system):** 1
- **With built-in installation box:** No
- **With screws:** No
- **Suitable for mounting in round junction box 60 mm:** Yes
- **Flush-mounted installation:** Yes
- **Suitable for subfloor installation duct box:** No
- **Suitable for wall duct:** No
- **Suitable for mounting on DIN-rail 35 mm:** No
- **Material:** Plastic
- **Material quality:** Thermoplastic

Certifications

- 00. CE Marking - EU ([download](#))
- 29. QCERT - Colombia
- 43. UKCA mark - Great Britain

Packaging



Code 8007352620377
Quantity 1 NR
Dim. 8.8x8.8x0.5 [cm]
Weight 18.2 [g]

Code 8007352624238
Quantity 10 NR
Dim. 19x14.3x9.5 [cm]
Weight 253 [g]

Legal

Vimar reserves the right to change at any time and without notice the characteristics of the products reported. Installation should be carried out by qualified staff in compliance with the current regulations regarding the installation of electrical equipment in the country where the products are installed. For the terms of use of the information on the product info sheet see [Conditions of Use](#).