



PLANA: Power supply 32Vdc 100mA 1M white

14580

Smart systems&products / By-me Plus / PLANA / Devices

Power supply 32Vdc 100mA 1M white

Supply unit with 32 V d.c. 100 mA output, supply voltage 110-230 V~ 50-60 Hz, white - 1 module

Product Status

3 - Active

Minimum order quantity

1 NR

Sheets, Manuals, Documentation

- [Sound System technical catalogue - IT \(32460 kb\)](#)
- [Multilanguage instructions sheet \(464 kb\)](#)



Drawings

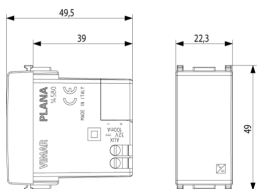

Space view



Backside view

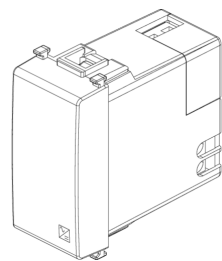

3D View

Technical data

- **Class group:** Installation bus systems
- **Class:** Power supply for bus system
- **Bus system KNX:** No
- **Bus system KNX-RF (Radio Frequent):** No
- **Bus system radio frequent:** Yes
- **Bus system LON:** No
- **Bus system Powernet:** No
- **Other bus systems:** None
- **Mounting method:** Flush-mounted
- **Width in number of modular spacings:** 1
- **With LED indication:** No
- **Bus voltage stockable:** No
- **Number of lines to feed:** 1
- **Max. output current:** 100,00 mA

Certifications

- 00. CE Marking - EU
- 37. Marking - Morocco
- 43. UKCA mark - Great Britain
- 96. Electrotechnical expert ([download](#))
- 99. WEEE Directive ([download](#))

Packaging



8 007352 400252

Code 8007352400252
Quantity 1 NR
Dim. 5.1x4.3x5.3 [cm]
Weight 49 [g]



8 007352 400269

Code 8007352400269
Quantity 5 NR
Dim. 14.4x11.6x6 [cm]
Weight 291.8 [g]

Legal

Vimar reserves the right to change at any time and without notice the characteristics of the products reported. Installation should be carried out by qualified staff in compliance with the current regulations regarding the installation of electrical equipment in the country where the products are installed. For the terms of use of the information on the product info sheet see [Conditions of Use](#).