



PLANA: Plate 2centrM techn. matt champagne

14652.22

Wiring devices / Traditional wiring devices / PLANA / Cover plates

Plate 2centrM techn. matt champagne

2-central-module cover plate, technopolymer, matt champagne

Product Status

3 - Active

Minimum order quantity

10 NR



You may also be interested in



14612 - Frame 2centralM
+screws

Drawings

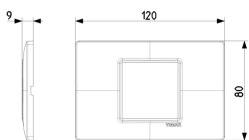

Space view

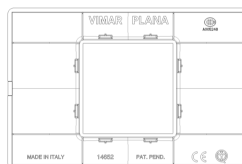

Backside view

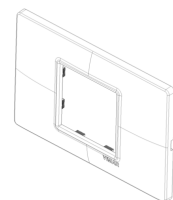

3D View

Technical data

- **Class group:** Domestic switching devices
- **Class:** Cover frame for domestic switching devices
- **Number of units:** 2
- **Mounting direction:** Horizontal and vertical
- **Number of units horizontal:** 2
- **Number of units vertical:** 1
- **Number of modules horizontal (module system):** 2
- **Number of modules vertical (module system):** 1
- **With mounting grid:** Yes
- **Suitable for subfloor installation duct box:** Yes
- **Suitable for wall duct:** Yes
- **Suitable for built-in installation:** Yes
- **Label space/information surface:** Yes
- **Material:** Plastic
- **Material quality:** Thermoplastic
- **Halogen free:** Yes
- **Surface protection:** Lacquered
- **Surface finishing:** Glossy
- **Colour:** Beige
- **RAL-number (similar):** 1035
- **Transparent:** No
- **With hinged lid:** No
- **Degree of protection (IP):** IP00
- **Type of fastening:** Clamp mounting
- **Width:** 120,00 mm
- **Height:** 80,00 mm
- **Depth:** 9,00 mm
- **Built-in width:** 120,00 mm
- **Built-in height:** 80,00 mm
- **Diameter bore hole (opening):** 0 mm

Certifications

- 00. CE Marking - EU
- 01. IMQ - Italy ([download](#))
- 29. QCERT - Colombia
- 43. UKCA mark - Great Britain

Packaging



Code 8007352120297
Quantity 1 NR
Dim. 17x8x0.9 [cm]
Weight 19.6 [g]



Code 8007352120303
Quantity 10 NR
Dim. 14.1x9.8x9.9 [cm]
Weight 242.8 [g]



Code 8007352639874
Quantity 480 NR
Dim. 59x39x31.5 [cm]
Weight 12,454 [g]

Legal

Vimar reserves the right to change at any time and without notice the characteristics of the products reported. Installation should be carried out by qualified staff in compliance with the current regulations regarding the installation of electrical equipment in the country where the products are installed. For the terms of use of the information on the product info sheet see [Conditions of Use](#).