



IDEA: Four half-buttons 1M arrow symbol grey

16841.3

Smart systems&products / KNX / IDEA / Buttons

Four half-buttons 1M arrow symbol grey

Four interchangeable half-buttons, 1 module, directional arrows symbol, grey

Product Status

3 - Active

Minimum order quantity

1 NR

Drawings

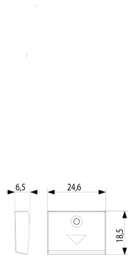

Space view

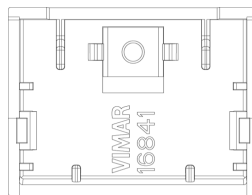

Backside view

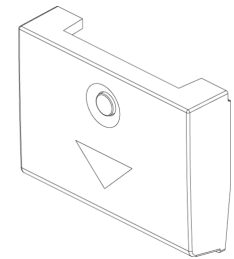

3D View

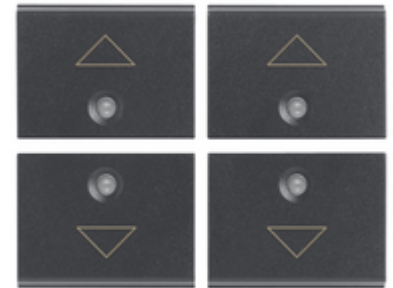

Technical data

- **Class group:** Domestic switching devices
- **Class:** Control element/cover plate for domestic switching devices
- **Model:** Other
- **Imprint/indication:** Symbol arrows
- **Utilization:** Switch/push button
- **Suitable for touch sensor connector for bus system:** No
- **Type of fastening:** Clamp mounting
- **Monitoring window/light outlet:** Yes
- **Material:** Plastic
- **Material quality:** Thermoplastic
- **Halogen free:** Yes
- **Surface protection:** Untreated
- **Surface finishing:** Matt
- **Colour:** Grey
- **RAL-number (similar):** 7015
- **With label area:** No
- **With exchangeable lens/symbol:** No
- **Suitable for degree of protection (IP):** IP40
- **Depth:** 650,00 mm

Certifications

- 96. Electrotechnical expert ([download](#))

Packaging

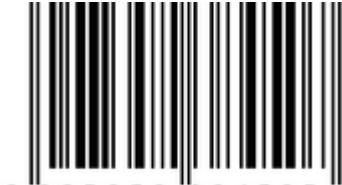
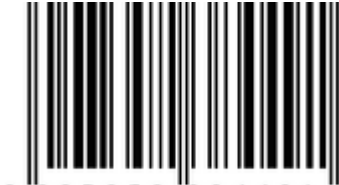

Code 8007352384491
Quantity 1 NR
Dim. 5x1.9x1.3 [cm]
Weight 5.19 [g]

Code 8007352384507
Quantity 6 NR
Dim. 14.2x6.7x5.9 [cm]
Weight 62.12 [g]

Legal

Vimar reserves the right to change at any time and without notice the characteristics of the products reported. Installation should be carried out by qualified staff in compliance with the current regulations regarding the installation of electrical equipment in the country where the products are installed. For the terms of use of the information on the product info sheet see [Conditions of Use](#).