



ARKÉ: Classic plate 4M Reflex sagegreen

19654.65

Wiring devices / Traditional wiring devices / ARKÉ / Cover plates

Classic plate 4M Reflex sagegreen

4-module Classic cover plate, technopolymer, Reflex sagegreen



Product Status

3 - Active

Minimum order quantity

10 NR

Drawings

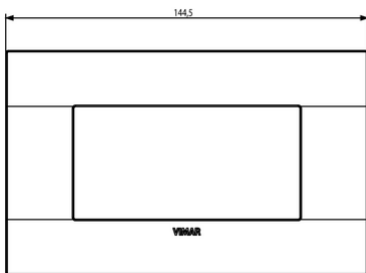

Space view

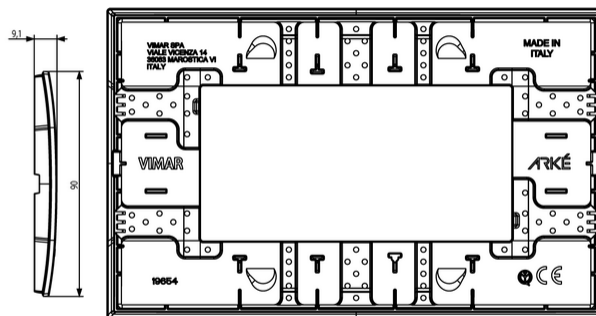

Backside view

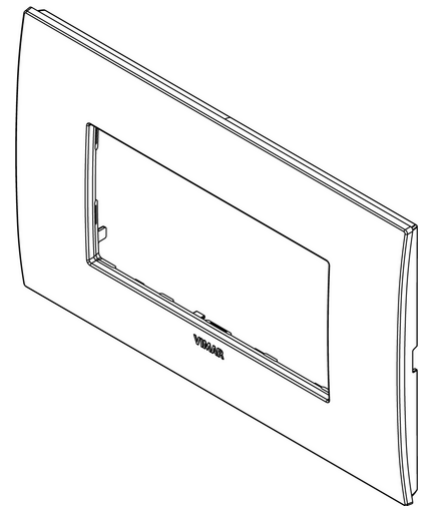

3D View

Certifications

• 00. CE Marking - EU

• 01. IMQ - Italy ([download](#))

Technical data

Class group: Domestic switching devices

Class: Cover frame for domestic switching devices

Number of units: 4

Mounting direction: Horizontal and vertical

Number of device inserts horizontal: 4

Number of device inserts vertical: 1

Number of modules horizontal (module system): 4

Number of modules vertical (module system): 1

With mounting grid: Yes

Suitable for subfloor installation duct box: Yes

Suitable for wall duct: Yes

Suitable for built-in installation: Yes

Label space/information surface: Yes

Material: Plastic

Material quality: Acrylic glass

Halogen free: Yes

Surface protection: Untreated

Surface finishing: Glossy

Colour: Green

RAL-number (similar): 6019

Transparent: No

With hinged lid: No

Degree of protection (IP): IP00

Type of fastening: Clamp mounting

Width: 144,50 mm

Height: 90,00 mm

Depth: 9,100 mm

Built-in width: 144,50 mm

Built-in height: 90,00 mm

Diameter bore hole (opening): 0,00 mm

Packaging



8 007352 552425

8007352552425

Qtà 1 NR

Dim 14.5x9x0.9 [cm]

Weight 43 [g]



8 007352 552432

8007352552432

Qtà 10 NR

Dim 17.1x9.8x9.9 [cm]

Weight 481 [g]

You may also be interested in



19614 - Frame 4M
+screws

Legal

Vimar reserves the right to change at any time and without notice the characteristics of the products reported. Installation should be carried out by qualified staff in compliance with the current regulations regarding the installation of electrical equipment in the country where the products are installed. For the terms of use of the information on the product info sheet see [Conditions of Use](#).