



LINEA: 2-button voice control+actuat.3M black

---

## 30815.G

Smart systems&products / View smart system / LINEA / Devices

### 2-button voice control+actuat.3M black

Amazon Alexa built-in vocal control device with built-in Wi-Fi and two front buttons, RGB LED backlighting, 1 input for wired push button, 1 NO relay output 100-240 V 50/60 Hz for 500 W incandescent lamps, 100 W LED lamps, 250 VA electronic transformers, 120 W fluorescent lamps, local or remote control, designed for use on VIEW Wireless mesh system thanks to IoT technology on Bluetooth technology 5.0 standard and on By-me Plus system thanks to the By-me bus, 100-240 V 50/60 Hz power supply, black - 3 modules. To be completed with Linea cover plates.

- Control with on-board relay, with dual technology for View Wireless smart systems (Bluetooth 5.0 mesh technology), and for By-me Plus wired home automation systems
- Equipped with two programmable electronic microswitch push buttons with RGB back lighting and adjustable brightness for visible in darkness and a relay with zero crossing technology to control one light
- Built-in Amazon Alexa vocal interface for use to control the on-board relay, to listen to music and control all Amazon Alexa compatible devices; specifically, via the VIEW skill - both on View Wireless and By-me Plus systems - it is designed to operate lights, handle curtains and roller shutters, control climate, call up scenarios, and via the VIEW Product skill, it is designed to control multi-sockets, Vimar connected adaptors and Elvox Wi-Fi cameras. All the products supported can be inter-connected to create - in the form of routines - simple automations that make the smart system even smarter



### Product Status

3 - Active

### Minimum order quantity

1 NR

## Sheets, Manuals, Documentation

- [Light multilanguage instructions sheet \(5044 kb\)](#)
- [Foglio istruzioni Full \(4567 kb\)](#)
- [Feuille d'instructions Full \(4570 kb\)](#)
- [Hoja de instrucciones Full \(4567 kb\)](#)
- [Full instructions sheet \(4564 kb\)](#)
- [Φυλλάδιο οδηγιών Full \(4712 kb\)](#)
- [Anweisungsblatt Full \(4569 kb\)](#)
- [Full \(4647 kb\)](#)

## Drawings

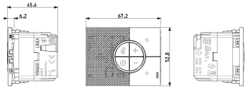

Space view

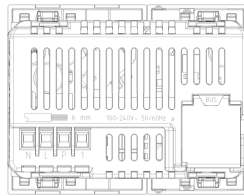

Backside view

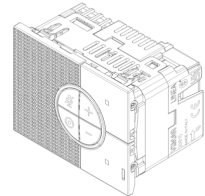

3D View

## Technical data

- **Class group:** Installation bus systems
- **Class:** Multi operating device for bus system
- **Bus system KNX:** No
- **Bus system KNX-RF (Radio Frequent):** No
- **Bus system radio frequent:** Yes
- **Bus system LON:** No
- **Bus system Powernet:** No
- **Other bus systems:** Other
- **Radio frequent bidirectional:** Yes
- **Mounting method:** Flush-mounted
- **Width in number of modular spacings:** 3
- **Number of actuation points:** 1
- **With display:** No
- **Status-LED:** Yes
- **IR sensor:** No
- **Manual set point setting:** No
- **Presence button:** No
- **With temperature controller:** No
- **With integrated DCF77 receiver:** No
- **With time switch clock:** Yes
- **With anti-theft/dismantling protection:** No
- **Central functional unit for senders/actuators:** Yes
- **Material:** Plastic
- **Material quality:** Thermoplastic
- **Surface protection:** Untreated
- **Surface finishing:** Matt
- **Colour:** Black
- **RAL-number (similar):** 7021
- **Transparent:** No
- **Degree of protection (IP):** IP20
- **With bus connection:** Yes

## Certifications

- 00. CE Marking - EU
- 37. Marking - Morocco
- 40. Bluetooth technology
- 43. UKCA mark - Great Britain
- 46. UK PSTI compliance ([download](#))
- 99. WEEE Directive ([download](#))

## Packaging



**Code** 8007352704008  
**Quantity** 1 NR  
**Dim.** 10.8x8.7x5.9 [cm]  
**Weight** 150 [g]

## Legal

Vimar reserves the right to change at any time and without notice the characteristics of the products reported. Installation should be carried out by qualified staff in compliance with the current regulations regarding the installation of electrical equipment in the country where the products are installed. For the terms of use of the information on the product info sheet see [Conditions of Use](#).