



## Switchboards: Flush mounting box for V53172

### V53372

System infrastructure / Enclosures and control units / Switchboards / Flush mounting

### Flush mounting box for V53172

Flush mounting box for 72-module consumer unit (GW 650 °C) for masonry walls, light blue. Dimensions 426x723x100 mm

### Product Status

3 - Active

### Minimum order quantity

3 NR

### Video

- [Flush mounting consumer units](#)



## Drawings

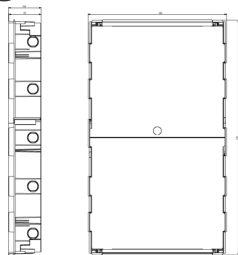

Space view

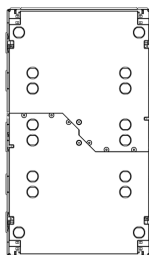

Backside view

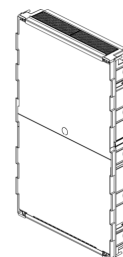

3D View

## Technical data

- **Class group:** Distribution boards
- **Class:** Empty cabinet
- **Mounting method:** Flush-mounted
- **Type of covering:** None
- **Cover model:** None
- **Type of door:** None
- **Transparent cover/door:** No
- **With lock:** No
- **Nominal current (In):** 0 A
- **Height:** 723 mm
- **Width:** 426 mm
- **Depth:** 100,00 mm
- **Built-in depth:** 100,00 mm
- **Inner depth:** 98,00 mm
- **Colour:** Other
- **RAL-number:** 0
- **Number of modules:** 72
- **Number of rows:** 4
- **Width in number of modular spacings:** 72
- **Number of openings for flange plates:** 0
- **Extension possible:** No
- **Number of conduit inlets:** 26
- **Housing material:** Plastic
- **Surface protection:** Untreated
- **With mounting plate:** No
- **Suitable for outdoor use:** No
- **Suitable for lightning protection:** No
- **Degree of protection (IP):** IP40
- **Protection class:** II
- **Circuit integrity:** None

## Certifications

- 01. IMQ - Italy ([download](#))
- 96. Electrotechnical expert ([download](#))

## Packaging



**Code** 8007352509979  
**Quantity** 1 NR  
**Dim.** 42.6x72x10 [cm]  
**Weight** 1,591.1 [g]



**Code** 8007352509986  
**Quantity** 3 NR  
**Dim.** 72x31x43 [cm]  
**Weight** 5,950.8 [g]

## Legal

Vimar reserves the right to change at any time and without notice the characteristics of the products reported. Installation should be carried out by qualified staff in compliance with the current regulations regarding the installation of electrical equipment in the country where the products are installed. For the terms of use of the information on the product info sheet see [Conditions of Use](#).