

Use and Configuration Manual**TAB****7549 - 7548**

Due Fili Plus TAB 4.3" video entryphone with handset

Index

General information	4
Description	4
Warnings and advice	4
Keys and LED statuses	5
Status LED	6
Operation	7
First power up	8
Programming the primary ID identification code	8
- <i>Simplified programming mode</i>	8
- <i>Standard programming mode</i>	12
Functions	17
Answering a call from an Outdoor Station	18
Answering a call from an Indoor Station or Reception switchboard	21
Audio/video settings	23
Volume and image brightness control	23
Pan/Zoom adjustment	25
Calling an Outdoor Station (Self-start)	27
Calling an Indoor Station (Intercom) or Reception Switchboard	29
Alert function	31
User Configurations	32
Call ringtone selection (for video entryphone 7549)	33
Call ringtone selection (for video entryphone 7548)	34
Ringtone volume control	35
Ringtone exclusion	36
Device cleaning	37
Installer configuration	38
Programming the secondary ID identification code	
- <i>Simplified programming mode</i>	40
- <i>Standard programming mode</i>	41
Programming keys for intercom calls	
- <i>Simplified programming mode</i>	42
- <i>Standard programming mode</i>	43
Programming the self-start key for a specific Outdoor Station	
- <i>Simplified programming mode</i>	44
- <i>Standard programming mode</i>	45
Programming the self-start key for a specific Outdoor Station	
- <i>Simplified programming mode</i>	46
Programming display contrast and brightness levels (video signal)	47
Restoring the default programming of each individual key	
- <i>Simplified programming mode</i>	48 - 49
- <i>Standard programming mode</i>	50
Restoring the complete default settings	
- <i>Simplified programming mode</i>	51
- <i>Standard programming mode</i>	52
Alert function configuration via SaveProg	53
Advanced configuration with SaveProg software	54

General information

Description

Surface mounting Tab video entryphone for Due Fili Plus system with 4.3" LCD colour display, handset, loudspeaker for calls, capacitive keypad for entryphone functions (door release, self-starting, auxiliary services, volume, brightness and contrast controls) and intercom calls.

It is possible to differentiate the call ringtones. The visual signals are for "door/gate open," "missed calls from a reception switchboard", "user away" and "ringtone exclusion". Can be used by people wearing hearing aids.



Warnings and advice

Audio frequency function for hearing aids (Teleloop)

The video entryphone can be used by people wearing hearing aids.

For correct functioning of the hearing aid, please refer to its instruction manual.

Any metal objects or electronic equipment in the vicinity may affect the quality of the sound received by the hearing aid.

Maintenance

Clean using a soft cloth.

Do not pour water onto the appliance and do not use any type of chemical product.

Cleaning must be done with the device powered off (disconnected from the bus) or after activating the [Keypad cleaning procedure](#)

Warnings for the user

Do not open or tamper with the appliance.

In the event of faults, contact specialized personnel.

For installation, refer to the instruction sheet in the package.

Driver for PC

The drivers are the same as for the other device in the TAB family.

The first time a device is connected to a USB port, the PC must associate the drivers to the peripheral device even if a TAB device has already been associated.







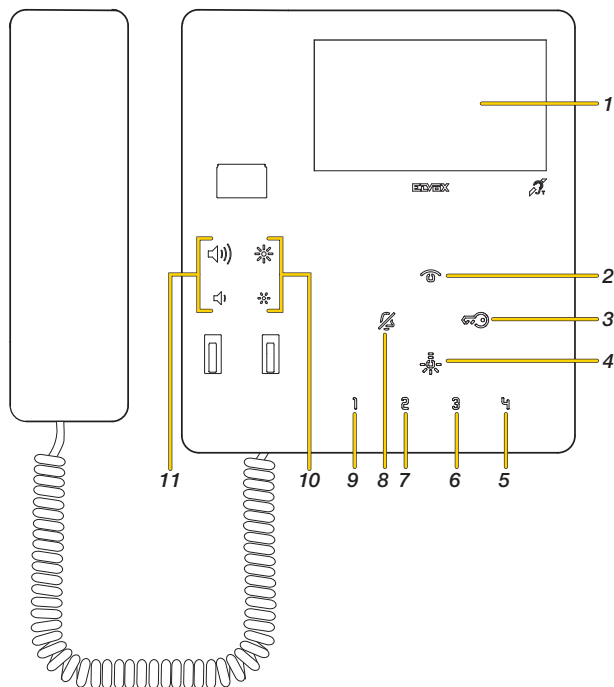

The Indoor Station is identified in SaveProg as ELVOX_7549 or ELVOX_7548 (depending on the model).

Keys and LED statuses

The TAB 4.3 video entryphone (7549, 7548) can be operated using the touch keys described below.





N.B.: with the handset replaced, the keys send the control concurrently with the sound feedback, whilst with the handset raised, the control is activated when the key is released.

1. 4.3" LCD 16:9 display, resolution 480x272 pixels
2.  Self-start: it activates the main outdoor station (ID 1).
3.  It activates the lock of the calling Outdoor Station.
4.  It activates the first relay of the Due Fili Plus system (Aux 1), stair lights function
5.  It sends an F2 control to Outdoor Stations (default *); (**Only for 7549**)
6.  It sends an F1 control to Outdoor Stations (default *); (**Only for 7549**)
7.  Free (default *); (**Only for 7549**)
8.  Ringtone exclusion: in stand-by, press and hold down for 2 s to deactivate/activate the ringtone. Ringtone mute: during an incoming call, press to deactivate the ringtone. The ringtone is simultaneously also deactivated for subsequent calls.
9.  It activates the second relay (Aux 2) of the Due Fili Plus system (default *); (**Only for 7549**)
10. It adjusts the brightness level (see [Image brightness and volume control](#))
11. It adjusts the ringtone volume, contrast and voice unit (see [Image brightness and volume control](#))

***N.B.:** where appropriately configured, it may activate intercom calls or auxiliary functions (see [installer configuration](#)).

Status LED

Some of the LEDs illustrated below only come on in certain conditions.

LED	DESCRIPTION
	When lit permanently, it indicates the door open status, and flashes when configuration is under way
	When lit permanently, it indicates that the ringtone is muted. Flashing in the following cases: – it is receiving a call from an Outdoor Station or Indoor Station (different flashes); – configuration is under way. If configured via SaveProg: – indication of calls received and missed from the switchboard (1 flash every 10 seconds); – user away (1 flash every second): the Indoor Station will refuse calls from an Outdoor Station
	Possible "Alert" signalling, see Alert Function

KEY



Operation

The TAB 4.3 video entryphone is designed to receive calls from Indoor Stations, Outdoor Stations and the Reception switchboard.

It can also perform the self-start of the Outdoor Station, intercom calls with Indoor Stations and the Reception switchboard.

Calls can be answered using the handset and/or by releasing the lock of the Outdoor Station using the dedicated key.

Some **programmable keys** are also available to activate other functions such as relay actuation or intercom calls:

- keys 1 2 3 4  for video entryphone 7549.

- only key  for video entryphone 7548.

First power up

Programming the primary ID identification code (Simplified programming mode)

Perform the device installation (according to the assembly instructions and the installation instructions provided in the printed instruction sheet supplied) and connect it to the Due Fili Plus bus.

Caution: installation must be carried out by qualified persons in compliance with the current regulations regarding the installation of electrical equipment in the country where the products are installed;

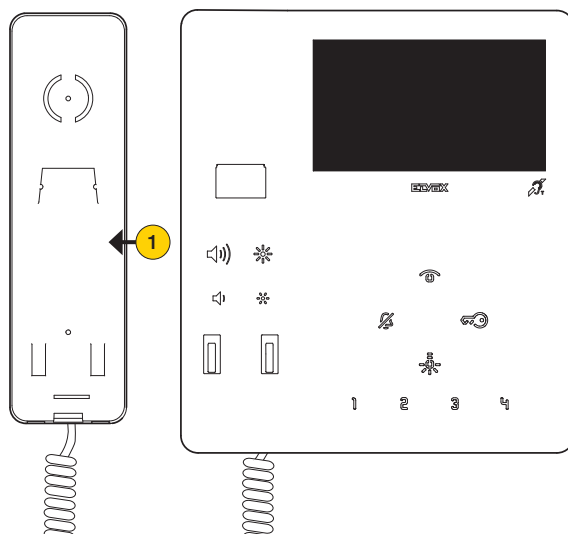

1. Lift the handset and bring it to your ear

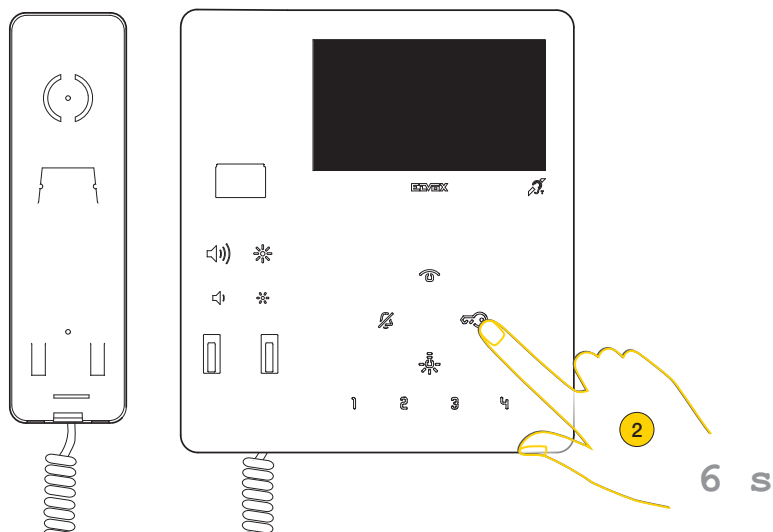

4. Press and hold down for 6 seconds

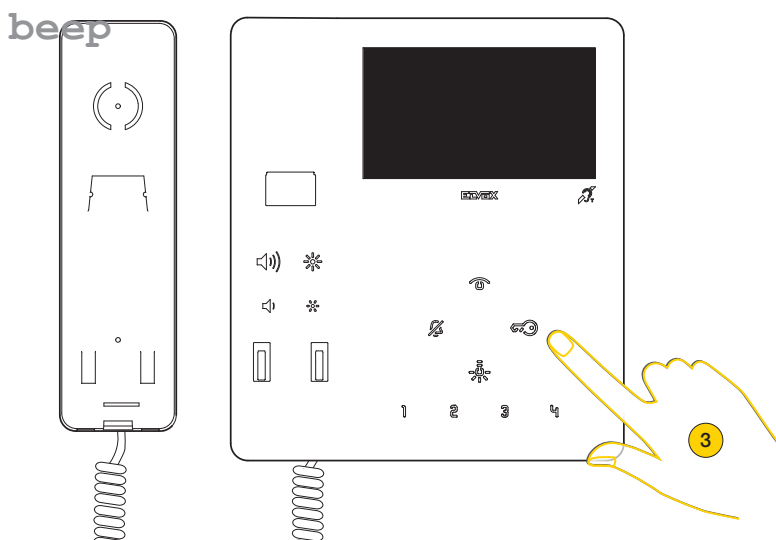

5. A sound is reproduced, release the key
N.B.: release the key after the first sound; prolonged pressing leads to a different programming.

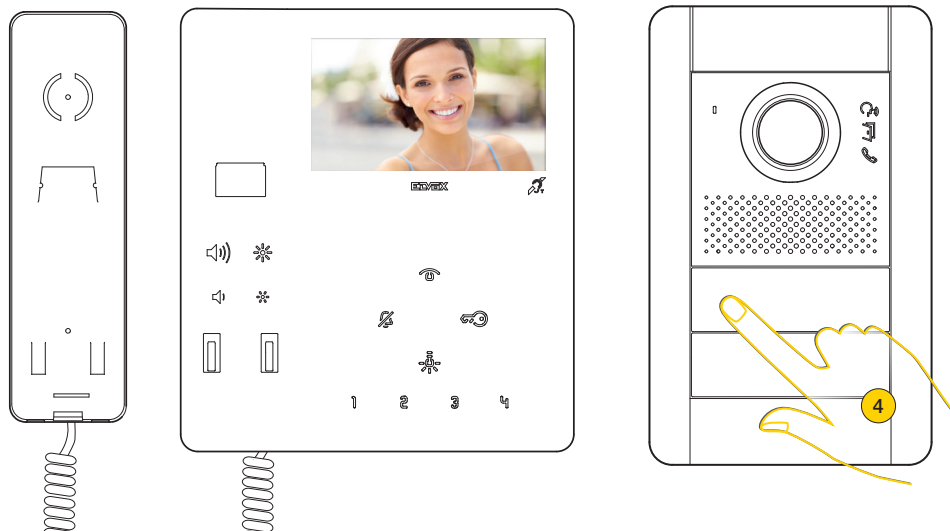

The Indoor Station starts communicating with the Outdoor Station

6. Within 30 seconds, press the push button on the Master outdoor station you wish to receive the call from.

N.B.: this procedure applies for Outdoor Stations with push buttons and may vary according to the Outdoor Station used. For Outdoor Stations with a keypad and display, type in the ID code and confirm with the call key.

BEEP

BEEP

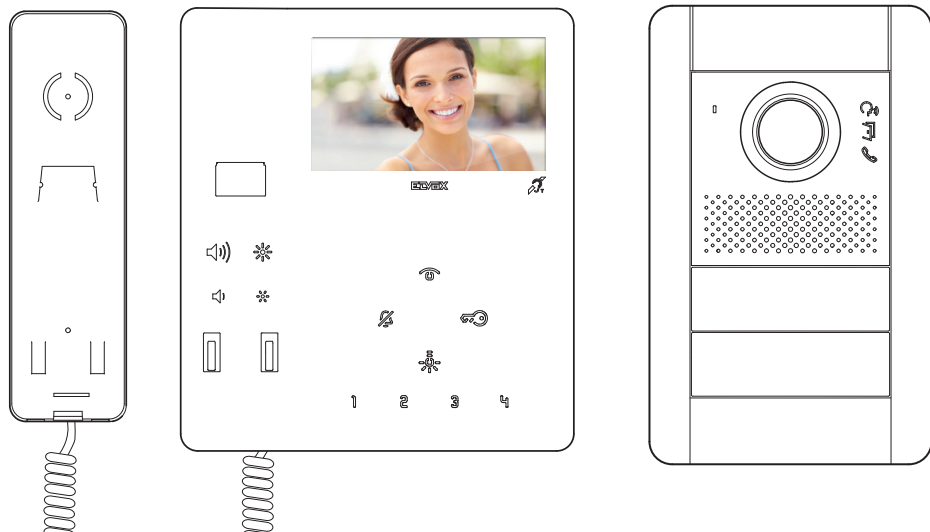

The video entryphone and the Outdoor Station emit a sound to confirm the operation.

N.B.: if the installation already contains an Indoor Station with the same paired identification code, the entrance panel will emit a tone and the process must be repeated from the start in order to assign a different code

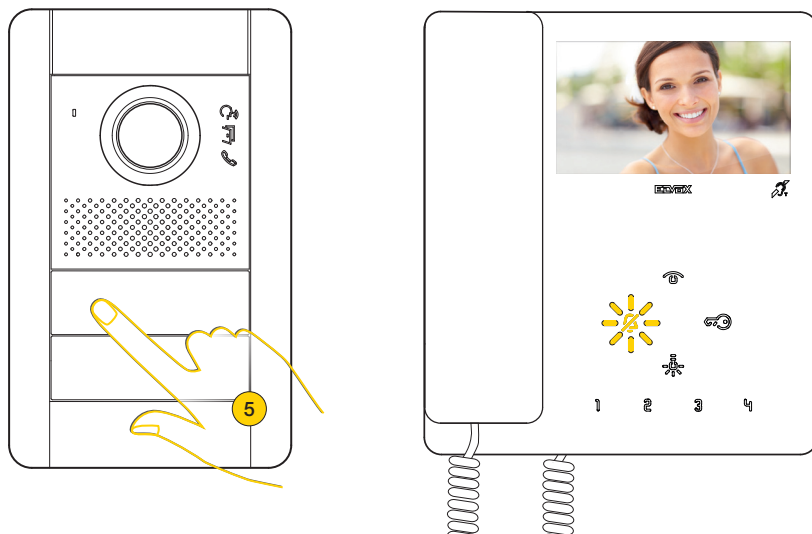

7. Press the corresponding key on the Outdoor Station to send the call to the Indoor Station

You can now use all the **Functions** of the Video entryphone.

Programming the primary ID identification code (*Standard programming mode*)

Perform the device installation (according to the assembly instructions and the installation instructions provided in the printed instruction sheet supplied) and connect it to the Due Fili Plus bus.

Caution: *installation must be carried out by qualified persons in compliance with the current regulations regarding the installation of electrical equipment in the country where the products are installed;*

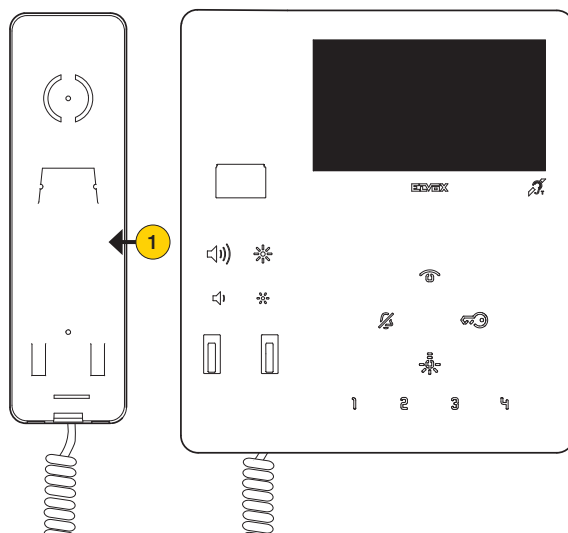

1. Lift the handset and bring it to your ear

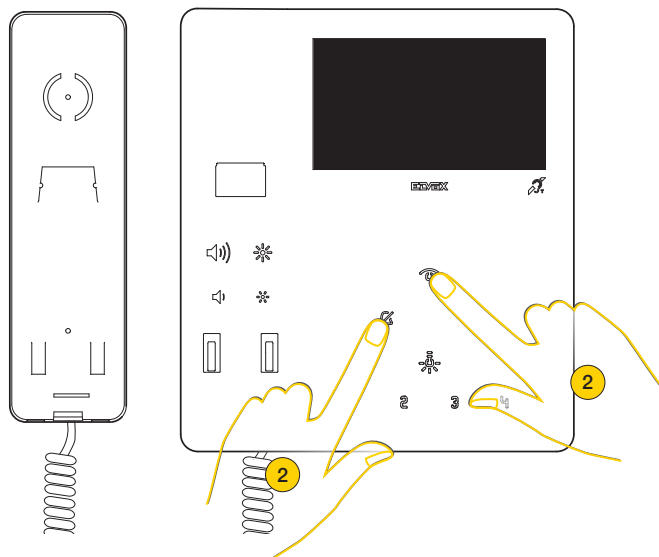

2. Hold down simultaneously

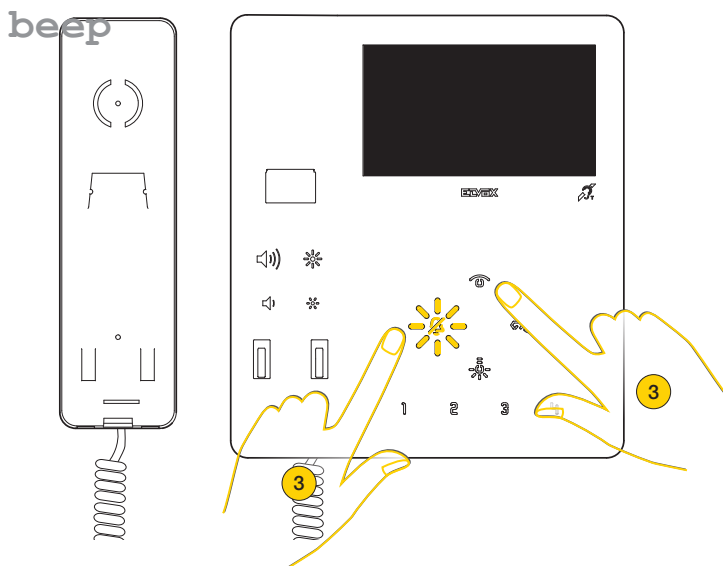

3. The ringtone LED flashes and a sound is reproduced, release the keys

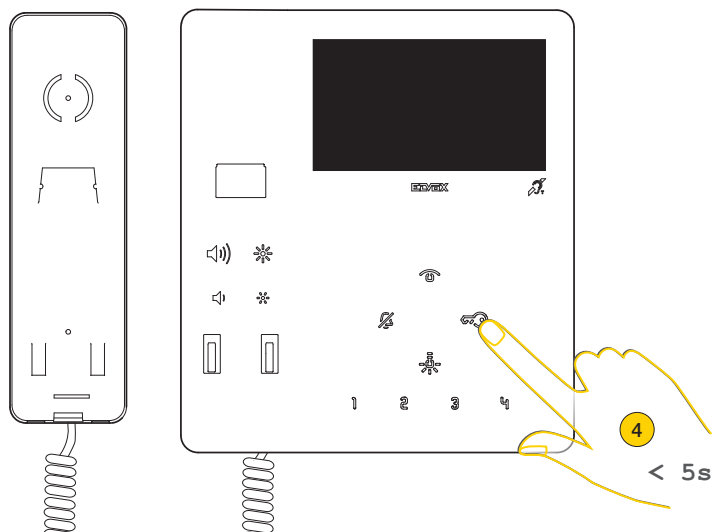

4. Press within 5 seconds and hold down
If you exceed 5 seconds, repeat points 1 and 2

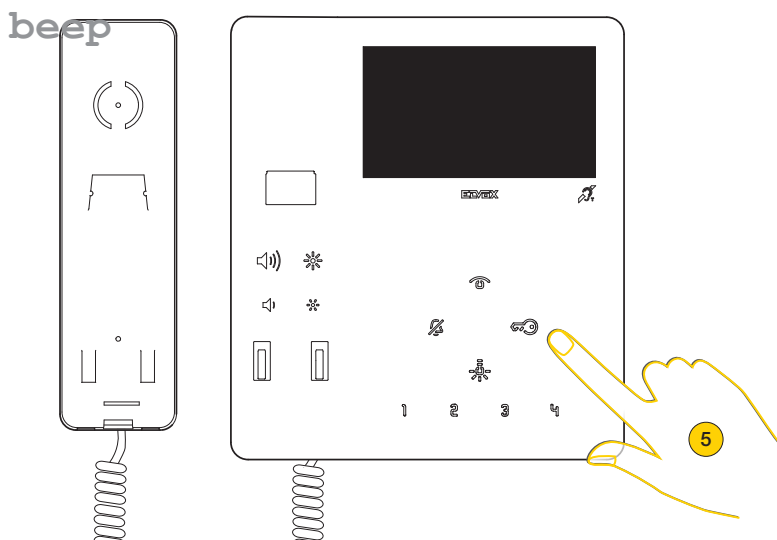

5. A sound is reproduced, release the key

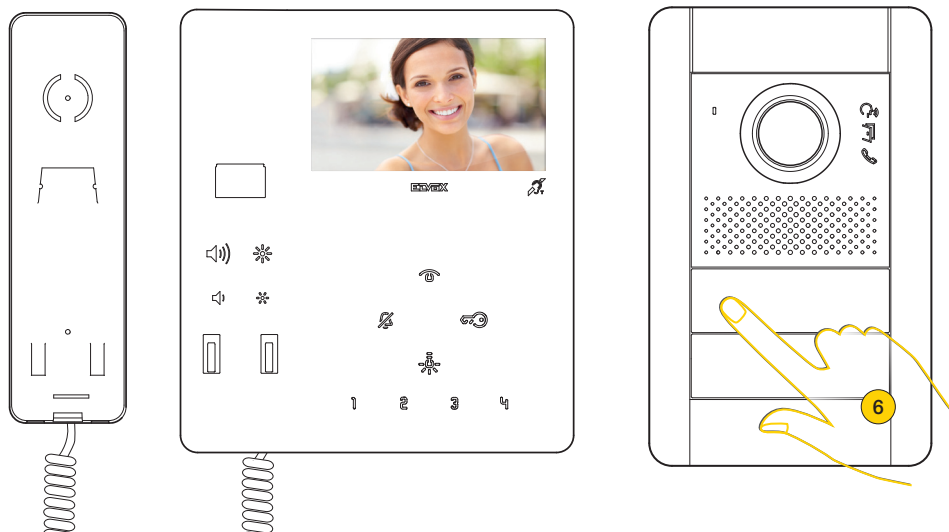

The Indoor Station starts communicating with the Outdoor Station

6. Within 30 seconds, press the push button on the Master outdoor station you wish to receive the call from.

N.B.: this procedure applies for Outdoor Stations with push buttons and may vary according to the Outdoor Station used. For Outdoor Stations with a keypad and display, type in the ID code and confirm with the call key.

BEEP

BEEP

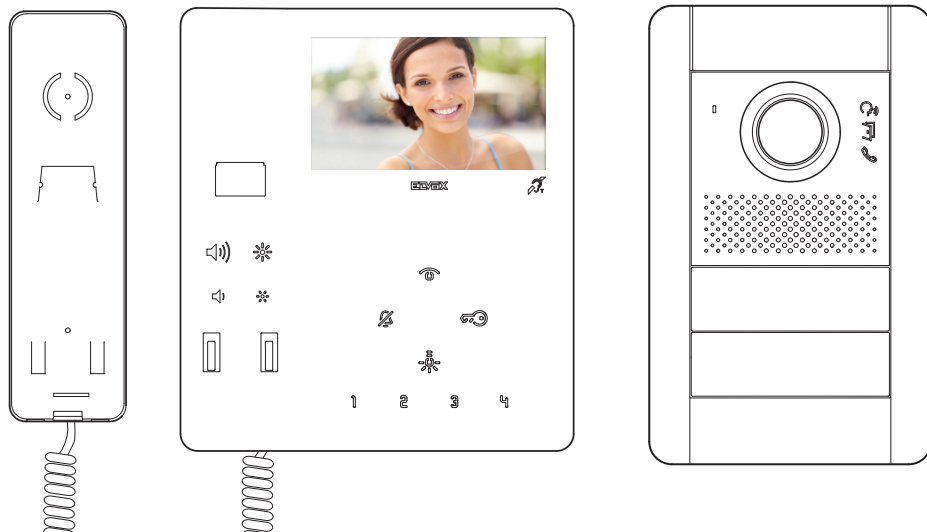

The video entryphone and the Outdoor Station emit a sound to confirm the operation.

N.B.: if the installation already contains an Indoor Station with the same paired identification code, the entrance panel will emit a tone and the process must be repeated from the start in order to assign a different code

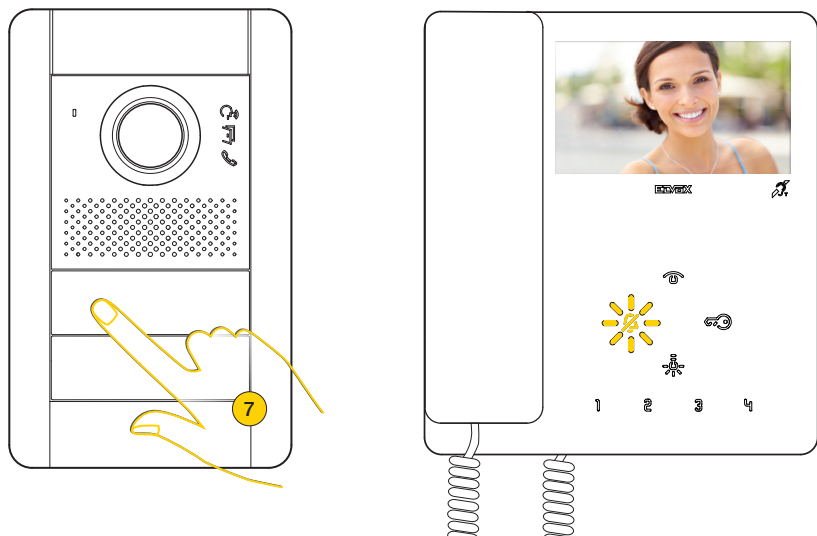

7. Press the corresponding key on the Outdoor Station to send the call to the Indoor Station

You can now use all the **Functions** of the TAB 4.3 Video entryphone.

Functions

The video door entry functions illustrated in the following paragraphs refer to audio/video calls from Outdoor Stations.

In the case of audio only Outdoor Stations, the display will be black.

In the case of a video door entry call with no video signal, the display will be blue.

For the operation of the video entryphone, the ID identification must be configured. To check whether an ID has been allocated to the video entryphone, proceed as follows:

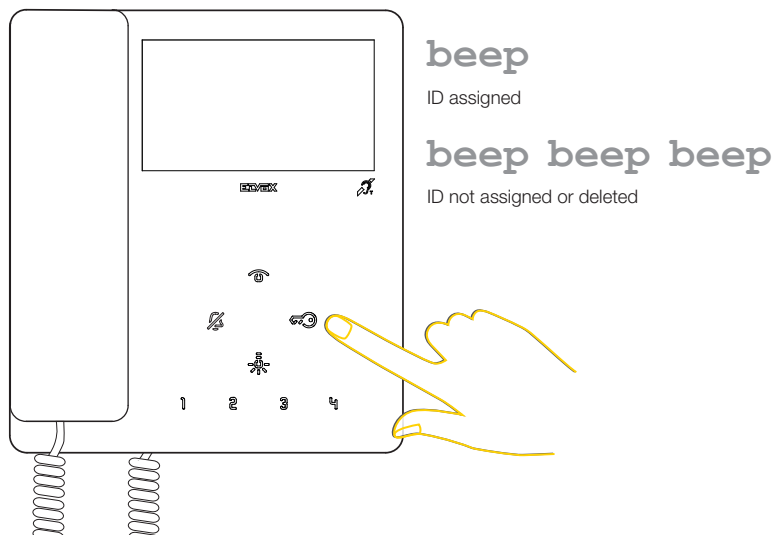

In stand-by, press any of the keys.

Answering a call from an Outdoor Station

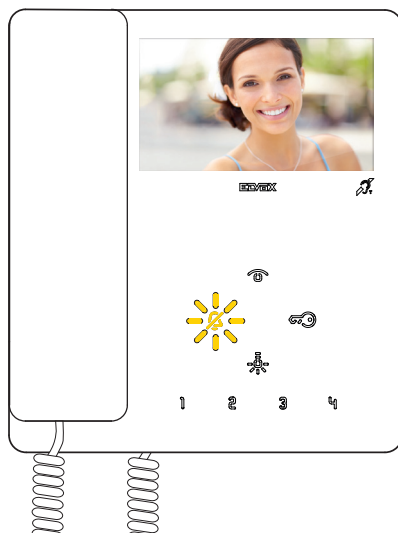

Following a call from an Outdoor Station, the display shows the images filmed and the  key flashes;

Depending on the type of outdoor station installed, the identification code of the calling outdoor station may also appear.

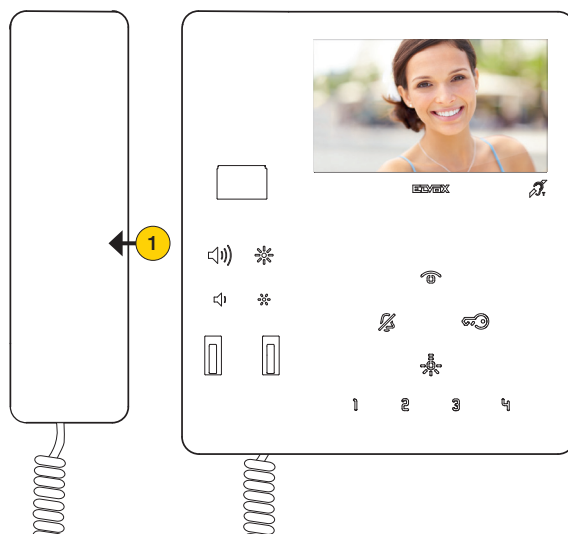

1. Lift the handset to answer the call.

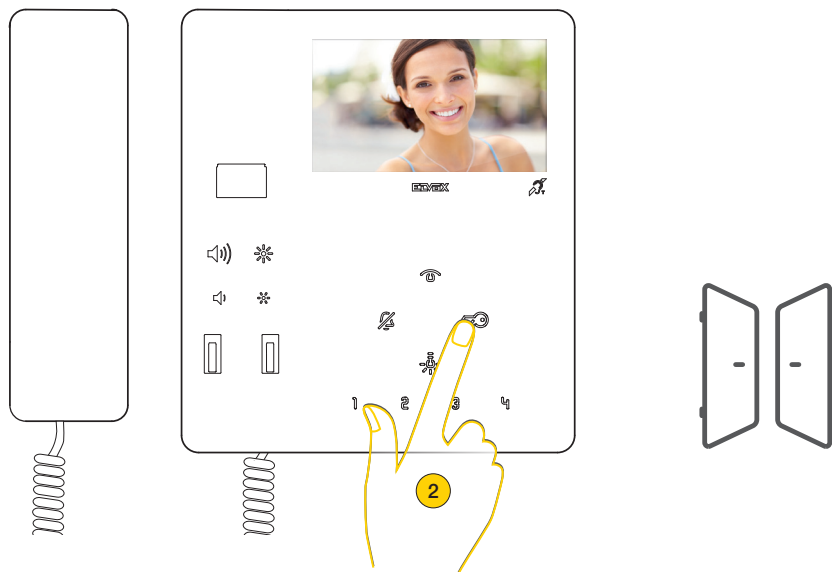

In addition to communicating, actions can be activated and/or **audio/video adjustments** can be made

2. Press to release the lock of the Outdoor Station connected, the lock release is also available in stand-by

N.B.: By Default the Indoor Station releases the lock of the last calling entrance panel.



3. Press to activate an actuation among those programmed

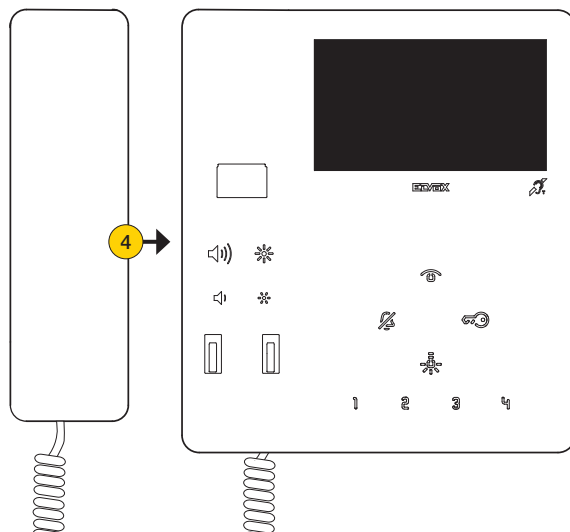

4. Reposition the handset to finish communicating

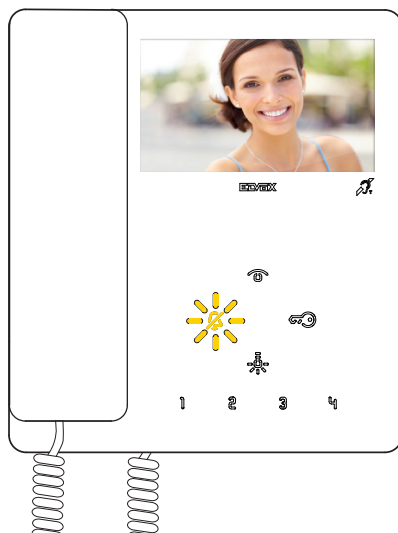

Answer a call from an Indoor Station or Reception switchboard

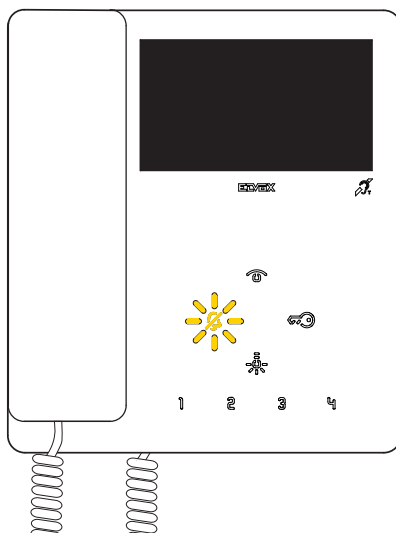

Following a call from an Indoor Station the ringtone key flashes

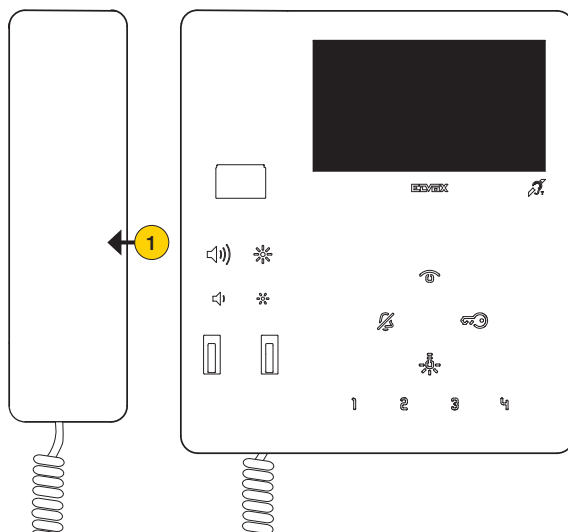

1. Lift the handset to answer the call.

N.B.: if the reception switchboard is configured to operate with a camera, then the receiver will be able to see the video signal from the camera.

Other video calls are possible (Due Fili Plus call button 20577, 19577) suitably configured and associated with an "Audio/video selector for 4 cameras 69AM" or "Video selector for 4 cameras 69AM/T".

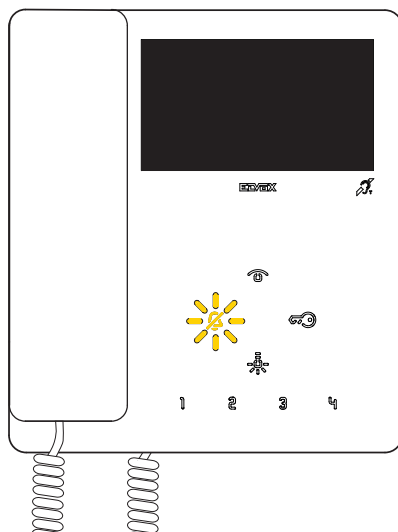

If there is no answer to one or more calls from the Reception switchboard, the  LED flashes (if the function was enabled from SaveProg).

The  LED stops flashing after the Indoor Station has answered and returned to stand-by or:

- after the ringtone has been reactivated
- after a self-start
- making any intercom call

N.B.: the missed call signal remains also in the case of a power outage.

Audio/video settings

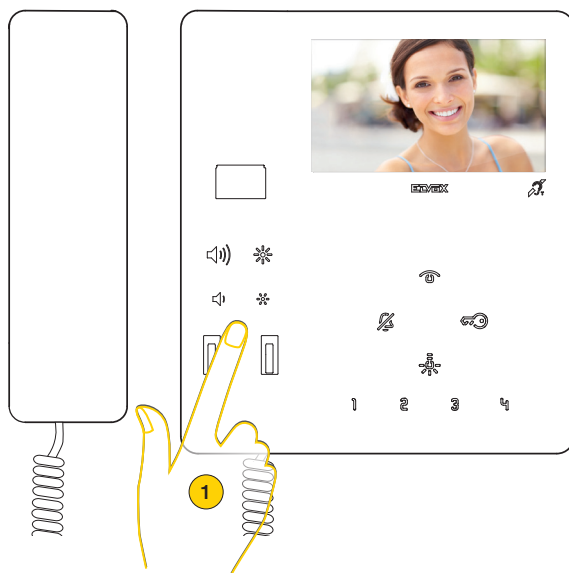

During an audio/video communication with Outdoor Stations or Indoor Stations, a series of adjustments can be made, including: adjusting the audio volume, the brightness of the image recorded and zooming (only Outdoor Stations designed for this purpose).



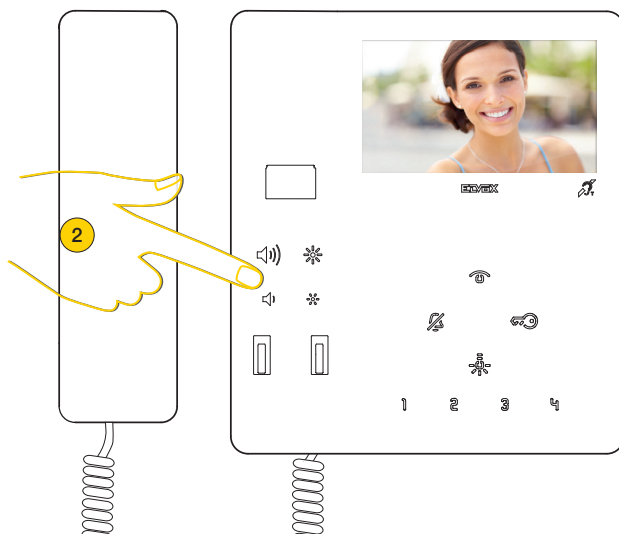

1. During a communication, press the keys positioned under the handset, to adjust the audio/video parameters.

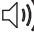
Volume and image brightness control

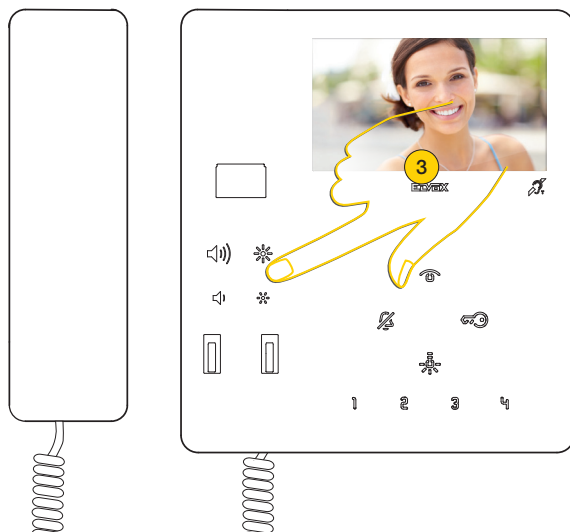

2. Press  to increase the audio level and  to reduce it.
A beep is emitted on reaching the maximum or minimum level.



3. Press  to increase the brightness and  to reduce it.
A beep is emitted on reaching the maximum or minimum level.

Pan/Zoom adjustment (Only for 7549)

Following a call from an Outdoor Station or self-start, the function can be actuated both with the handset raised (communication active) and lowered.

In the event that the TAB 7549 Video entryphone is paired with a Pixel Outdoor Station with appropriate characteristics (Art. 41004, 41005 or 40404 40405), with FW version that supports the function), the function can be actuated.

N.B.: if the entrance panel is performing a pan/zoom adjustment, it cannot receive activation controls for any F1-F2 functions.

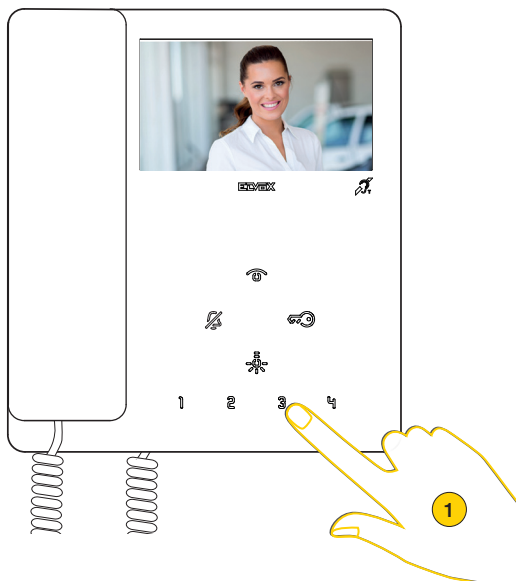

1. Press to zoom the image filmed by the Outdoor Station



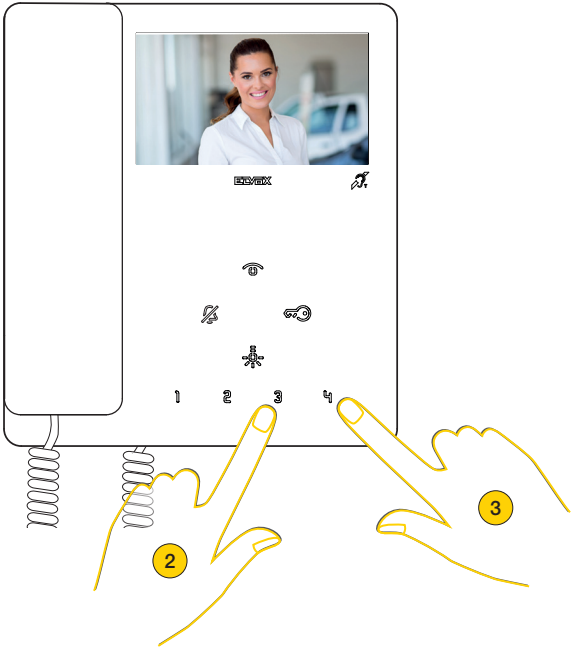

The device performs a zoom divided up into 5 zones

- 2. Press to display the zones in sequence clockwise
- 3. Press to display the zones in sequence anti-clockwise

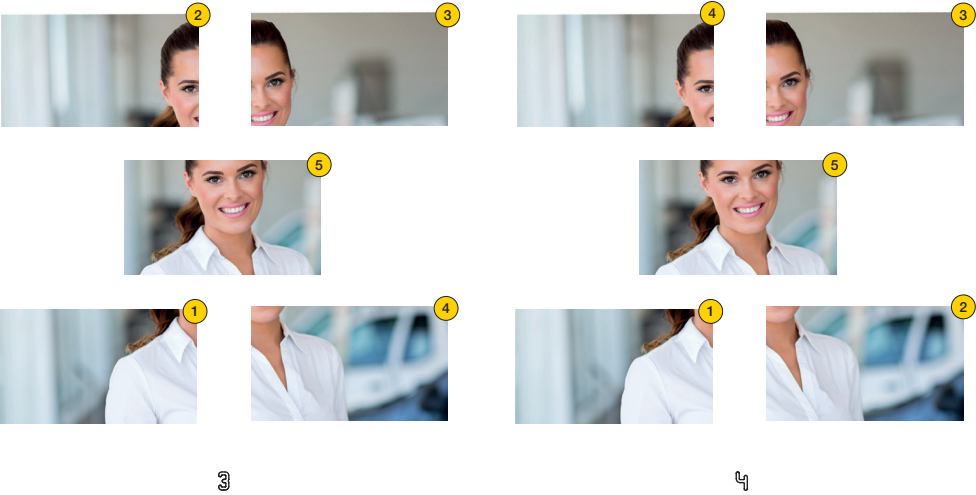

In both cases, once the sequence is finished, press the key again to return to the normal display

Self-start (Calling an Outdoor Station)

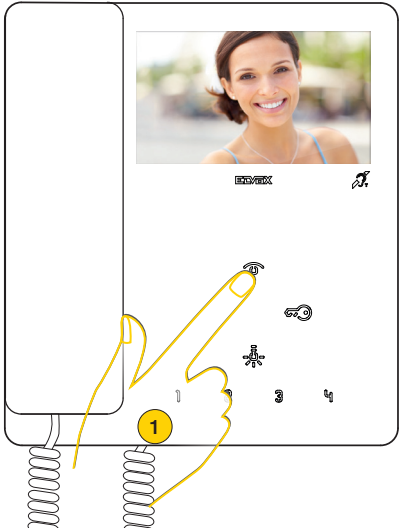

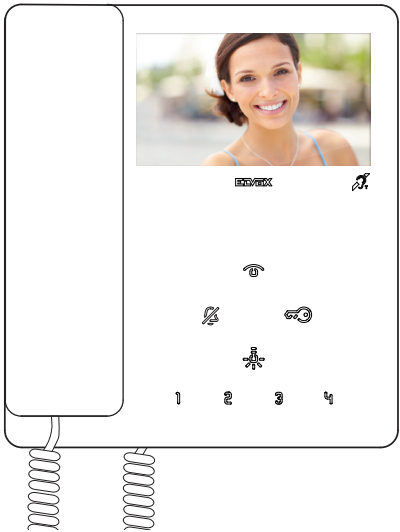

1. Press to perform the self-start of the Master Outdoor Station (default configuration).

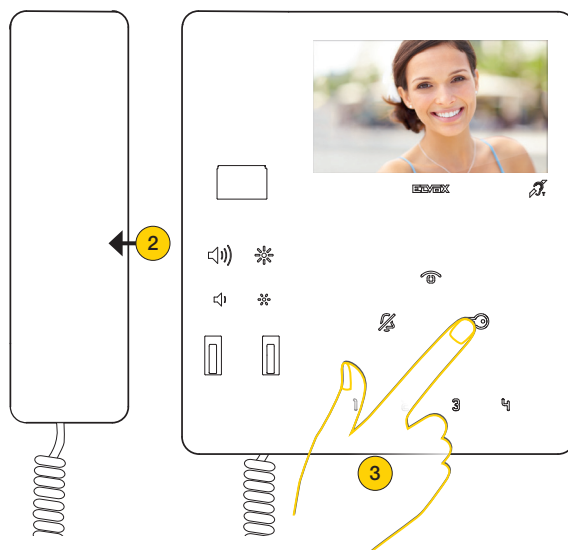

The video entryphone shows the image filmed



2. Raise the handset to start communicating
3. Press to release the lock

You can also perform the self-start of a specific Outdoor Station by using keys 1 2 3 4 , (only  for 7548): after appropriate programming (see [Programming the self-start key for a specific Outdoor Station](#))

N.B.: in the case of self-starting an audio-only outdoor station, raise the handset before pressing the self-start key.

Calling an Indoor Station (Intercom) or Reception Switchboard

You can call another Indoor Station using keys 1 2 3 4 , (only  for 7548):
after appropriate programming (see [Key programming procedure for making intercom calls](#)).

You can also call a reception switchboard (if present in the system) using the  key, with the handset raised.

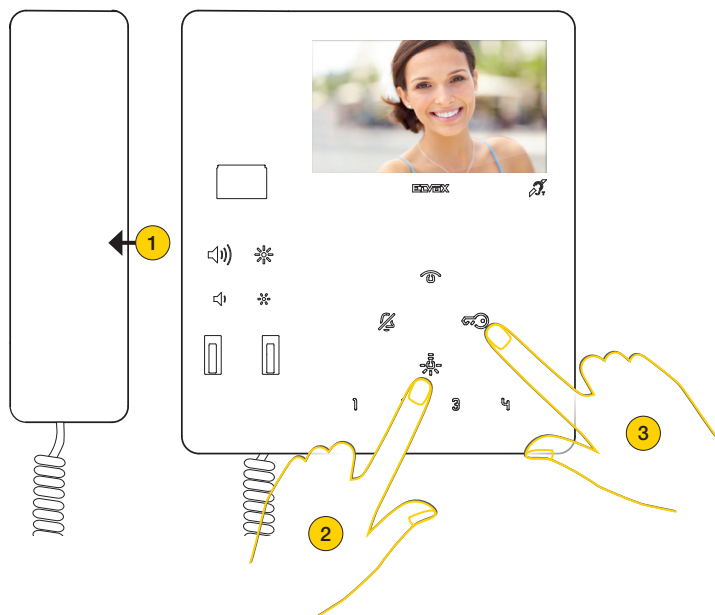

1. Raise the handset

2. Press to call the Indoor Station associated with the push button for example 
or

3. Press  to call the reception switchboard.

During the call, the Indoor Station emits a tone in order to signal that the call is being made.

If the Indoor Station is already engaged with another call, a tone will be heard on the Indoor Station making the call to indicate that the user receiving the call is busy.

When the Indoor Station being called answers, communication starts automatically.

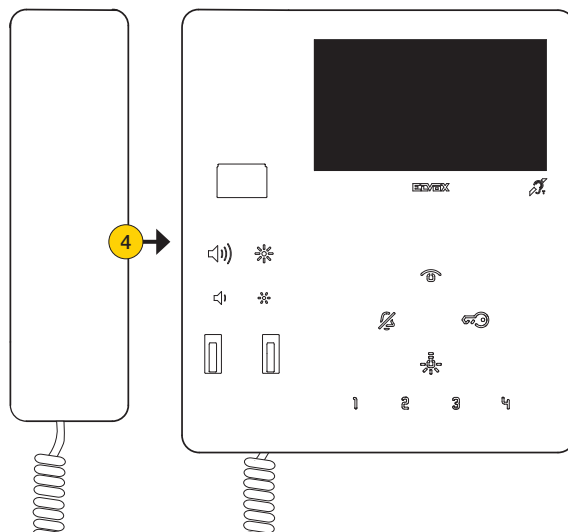

4. Reposition the handset to finish communicating.

N.B.: the maximum length of an intercom conversation is 5 minutes (unless programmed otherwise with [SaveProg](#)).

Alert Function

This function is used to send a notice to the Reception Switchboard art 40510 even if the Due Fili Plus bus is busy.
To activate this function, you need to connect a push button to terminals FP-M and use the SaveProg software to set the operating mode (see [Alert configuration via SaveProg](#)).

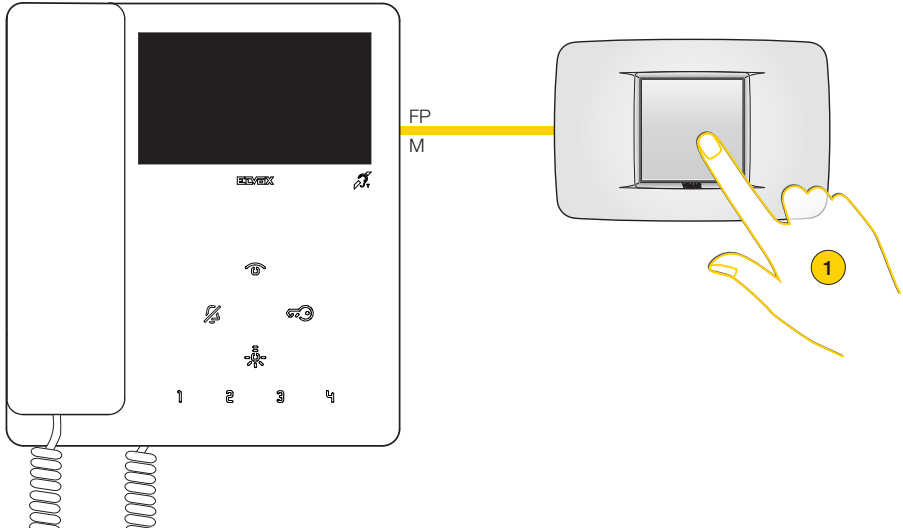

1. Press the push button to send an alert notification

Now the video entryphone goes in stand-by and receives various answers depending on the actions of the Reception switchboard.
These answers may be visual or acoustic depending on the configuration set via SaveProg (see [Alert configuration via SaveProg](#)).

The video entryphone is pending an answer from the Reception switchboard



or



BEEP

Slow flashing

Low and slow
sound

The video entryphone has received confirmation of receipt of the notification from the Reception switchboard



or



BEEP

Rapid flashing

High and fast
sound

User configurations

Certain parameters of the TAB 7549 Video entryphone can be adjusted according to the following procedures:

PROCEDURE	DESCRIPTION	DEFAULT VALUE
Call ringtone selection	It selects the ringtone that is reproduced in the event of a call from an Outdoor Station, from an Indoor Station or a Landing Call	Respectively: Outdoor Station = 1 Indoor Station = 3 Landing = 2
Ringtone volume control	It adjusts the volume of the ringtones	5
Ringtone exclusion	It activates/deactivates the ringtone	Ringtone on
Device cleaning	It activates the blockage of all keys (5 seconds), to allow you to clean the video entryphone	–

Caution: these procedures should be carried out with the video entryphone in stand-by and the handset replaced.

KEY

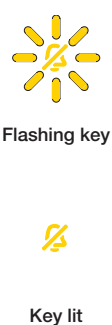

Call ringtone selection (for video entryphone 7549)

You can use this procedure to select the ringtone (10 available) which is reproduced in the event of a call from:

External Call	key	1
Intercom Call	key	2
Landing	key	3

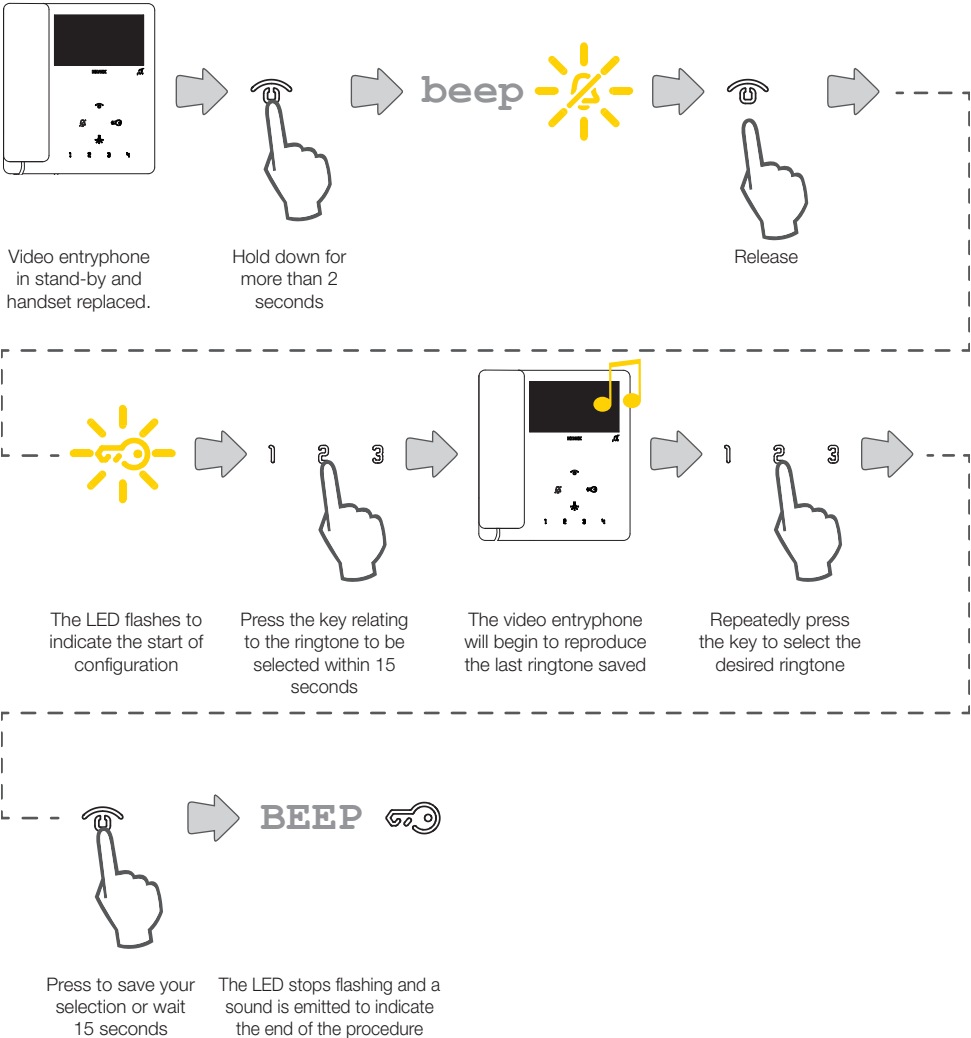

Call ringtone selection (for video entryphone 7548)

You can use this procedure to select the ringtone (10 available) which is reproduced in the event of a call from:

External Call

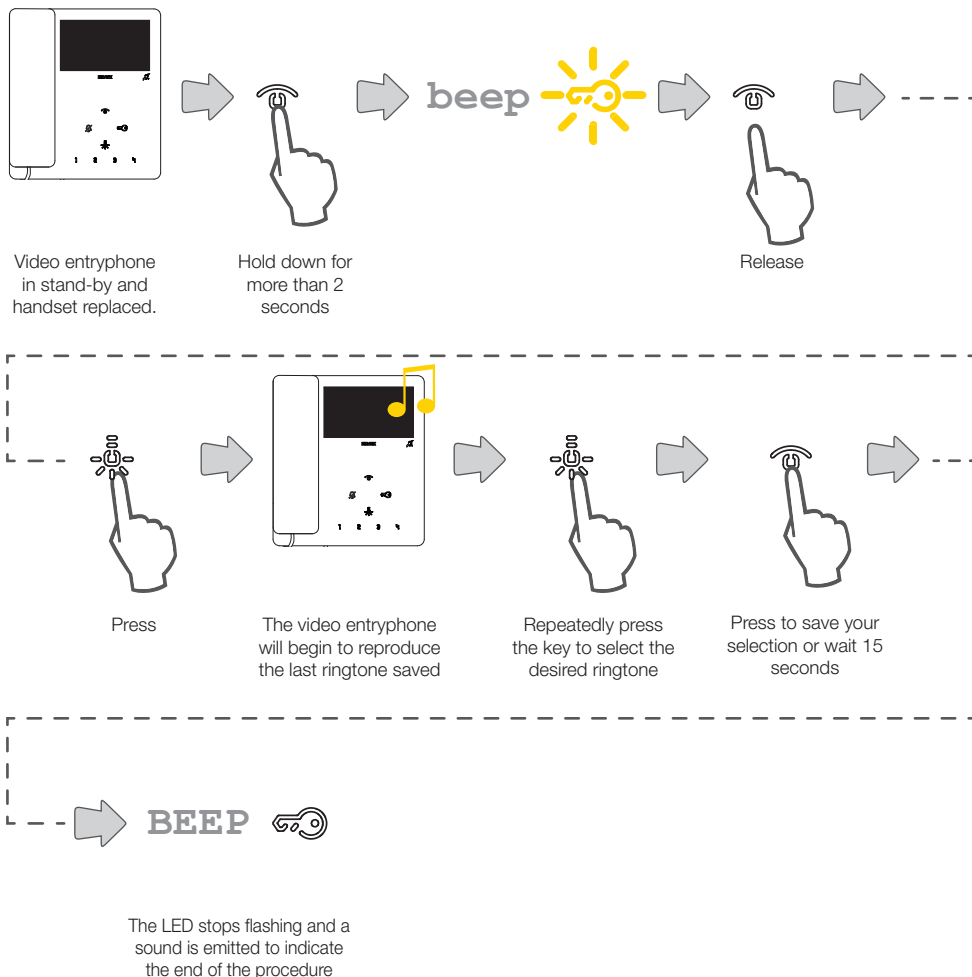

N.B.: The intercom call and landing call melodies can be modified via [SaveProg](#) but not using the keys.

Ringtone volume control

Use this procedure to adjust the volume (10 levels) of the ringtones.

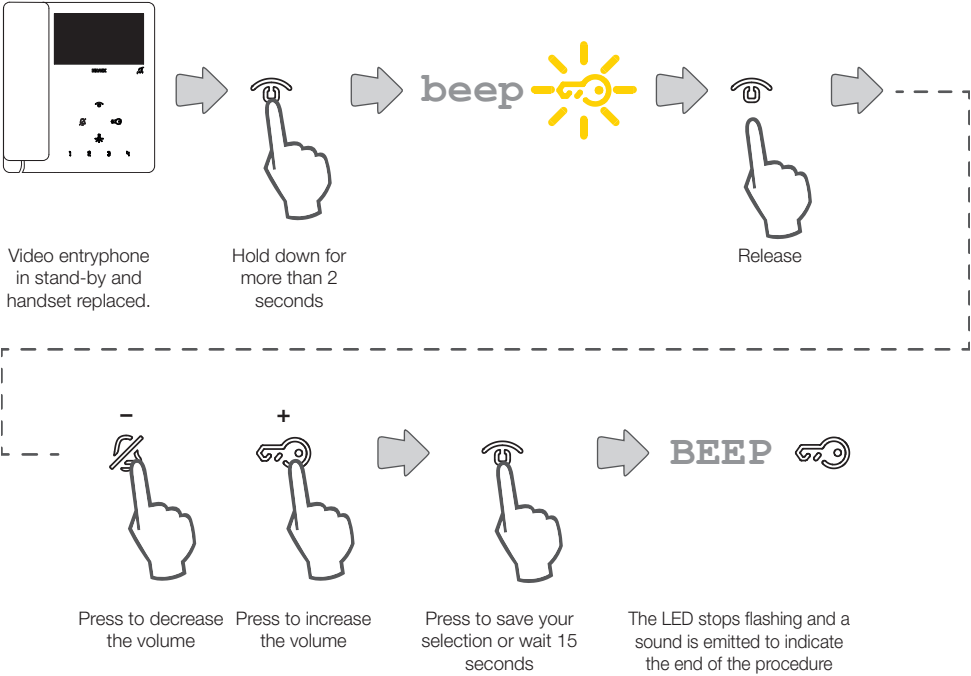

Ringtone exclusion

Use this procedure to deactivate the ringtone.

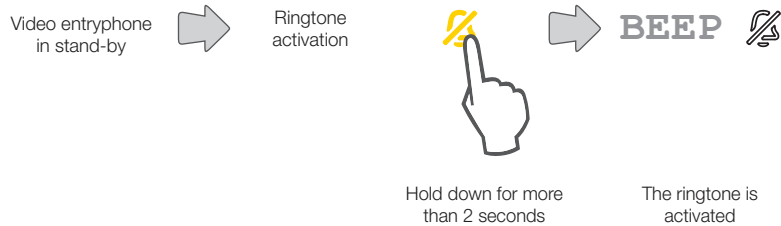
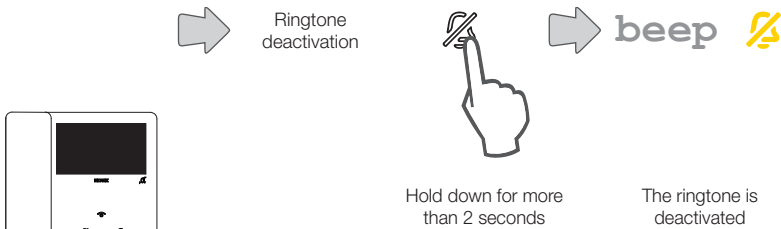

***N.B.:** during an incoming call, simply press the key, without prolonged pressure of 2 seconds, to deactivate the ringtone.*

Device cleaning

Use this procedure to activate the keypad cleaning function, by blocking the keys of the video entryphone for the amount of time necessary to clean them.

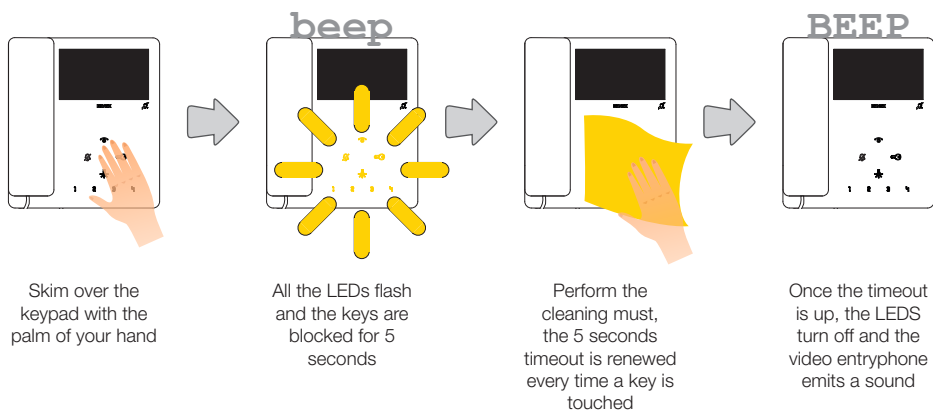

Caution: clean using a soft cloth.

Do not pour water onto the appliance and do not use any type of chemical product.

Cleaning must be done with the device powered off (disconnected from the BUS) or after activating the keypad cleaning procedure

Installer configuration

In this section, you can set certain parameters directly from the device; for certain advanced functions, use the [SaveProg](#) software).

PROCEDURE	DESCRIPTION	DEFAULT VALUE
Programming the main ID identification code	See First power up	No ID assigned (only in the case of a Video entryphone included in a kit, the ID may even be pre-configured)
Programming the secondary ID identification code	Identifies an Indoor Station as secondary	–
Programming keys for intercom calls	Programmes one or more keys to make intercom calls towards other Indoor Stations.	No intercom programmed.
Programming a key for self-start of a specific outdoor station	Programmes one or more keys to perform the self-start of a specific Outdoor Station	–
Programming video signal contrast and brightness levels	Sets the video signal contrast and brightness levels	
Restoring the default programming of each individual key	Restores the default programming of each individual programmable key.	
Restoring the complete default settings	Deletes all the video entryphone programming (restoring it to the factory configuration)	

For each programming, two modes are available and described below:

- Simplified programming mode
- Standard programming mode

KEY



Sound up



Flashing key



BEEP

Sound low



Key lit

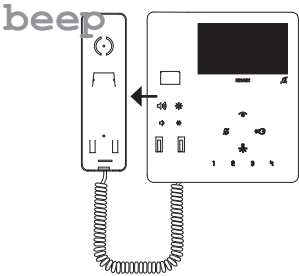

Handset released, sound reproduced by
the handset speaker

Programming the secondary ID identification code (Simplified programming mode)

Use this procedure to identify as secondary an Indoor Station associated with the master of a group with the contemporary call from an Outdoor Station (max one master and 3 secondaries).

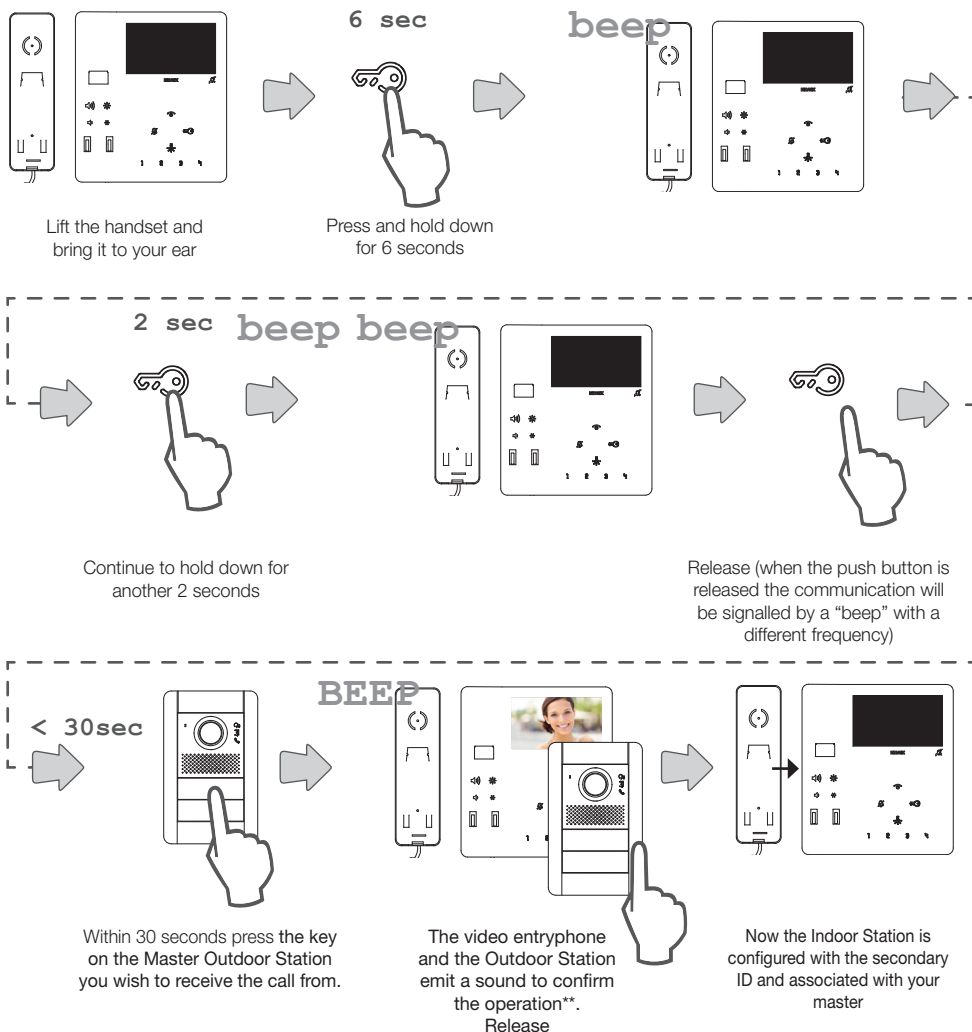

***N.B.:** this procedure applies for entrance panels with push buttons and may vary according to the Outdoor Station used. For Outdoor Stations with a keypad and display, type in the ID code of the master and confirm with the call key.

N.B.: to programme the ringtone activation of all the video entryphones and the activation of the video of the master video entryphone only, use the [SaveProg](#) software.

N.B.: to delete from a Group, see ["Restoring the default data"](#).

Programming the secondary ID identification code (Standard programming mode)

Use this procedure to identify as secondary an Indoor Station associated with the master of a group with the contemporary call from an Outdoor Station (max one master and 3 secondaries).

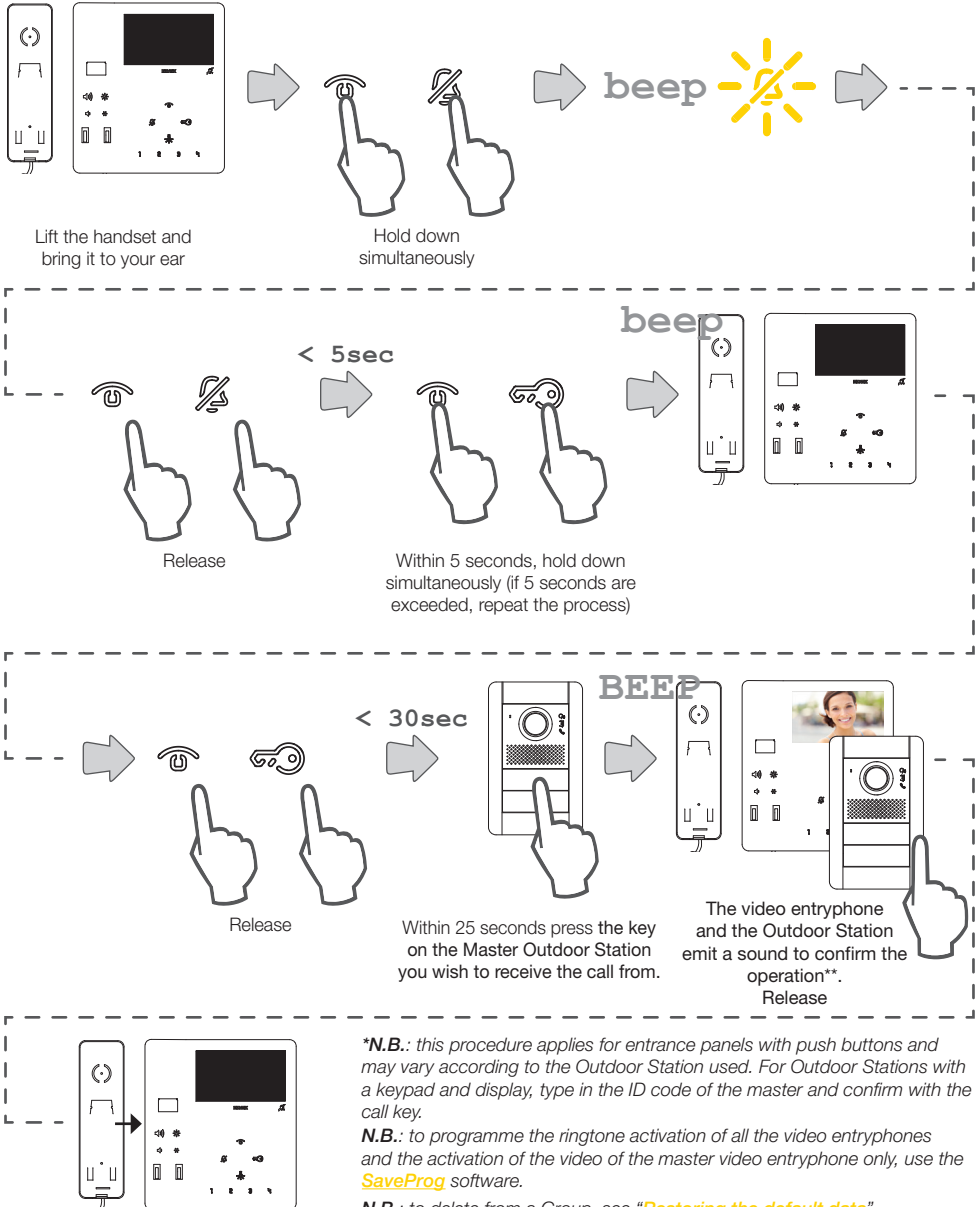

Now the Indoor Station is configured with the secondary ID and associated with your master

Programming keys for intercom calls
(Simplified programming mode)

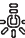

Use this procedure to programme one of the keys on the video entryphone to make intercom calls towards other Indoor Stations.

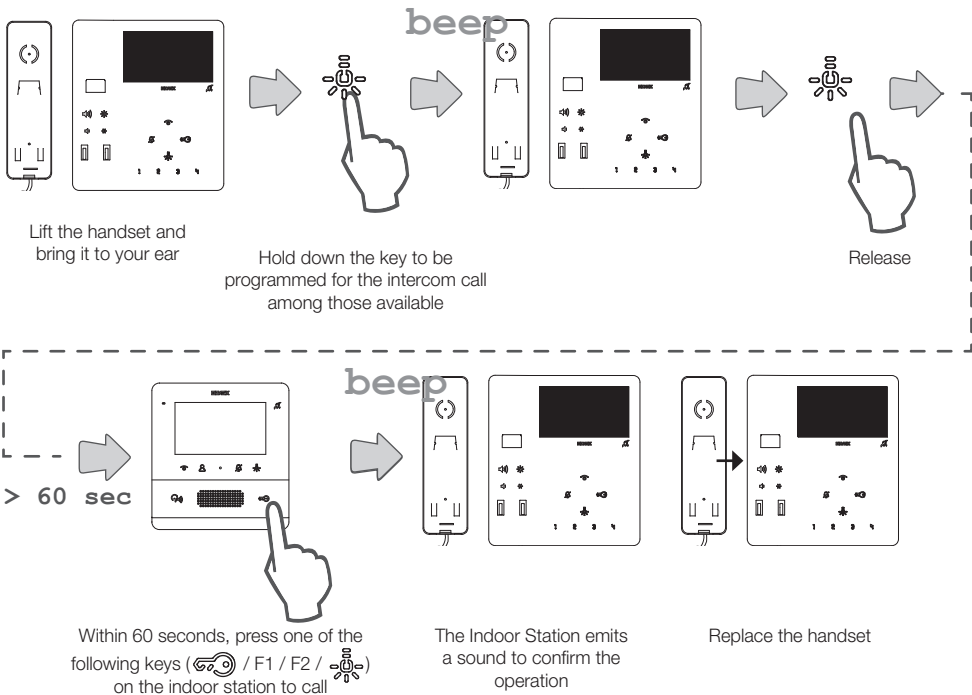
The programmable keys for this function are: 1 2 3 4  for video entryphone 7549, only  for video entryphone 7548.



Programming keys for intercom calls (Standard programming mode)

Use this procedure to programme one of the keys on the video entryphone to make intercom calls towards other Indoor Stations.

The programmable keys for this function are: 1 2 3 4  for video entryphone 7549, only  for video entryphone 7548.

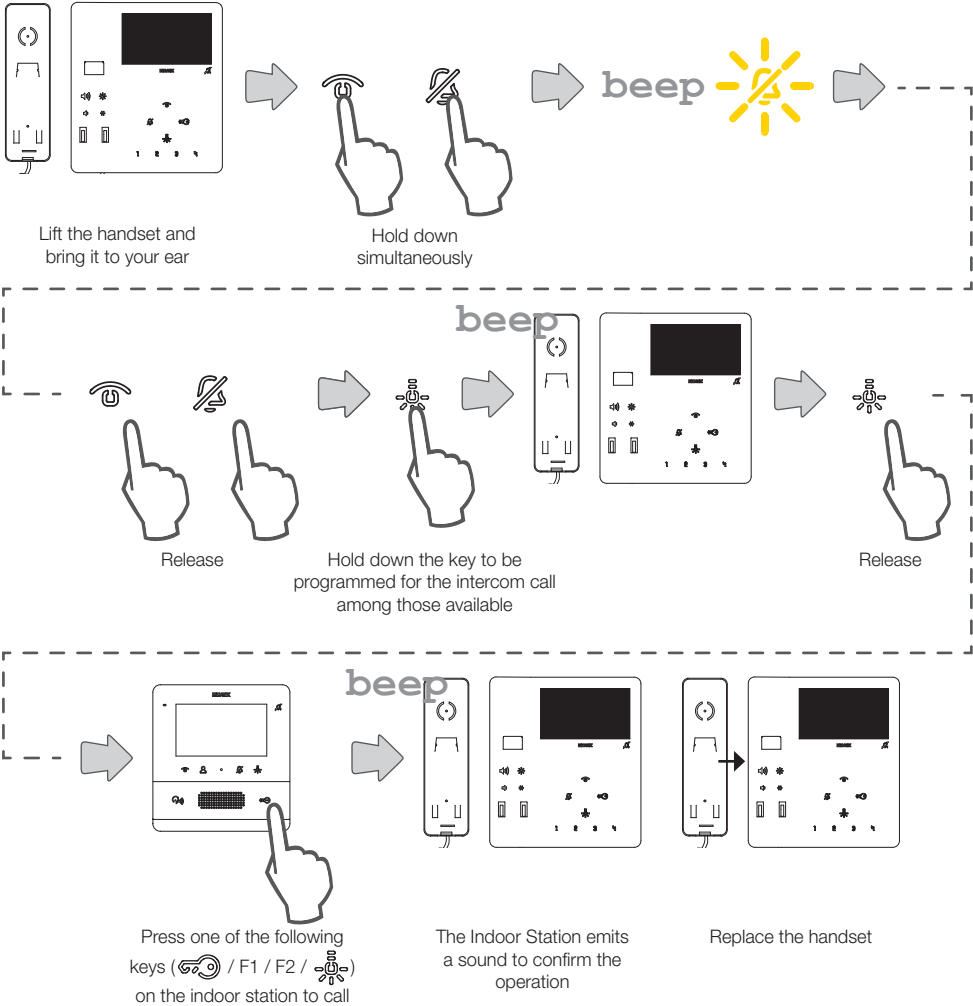

Programming the self-start key for a specific Outdoor Station (Simplified programming mode)

Use this procedure to programme one of the keys on the video entryphone to perform the self-start directly on a specific Outdoor Station.

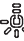

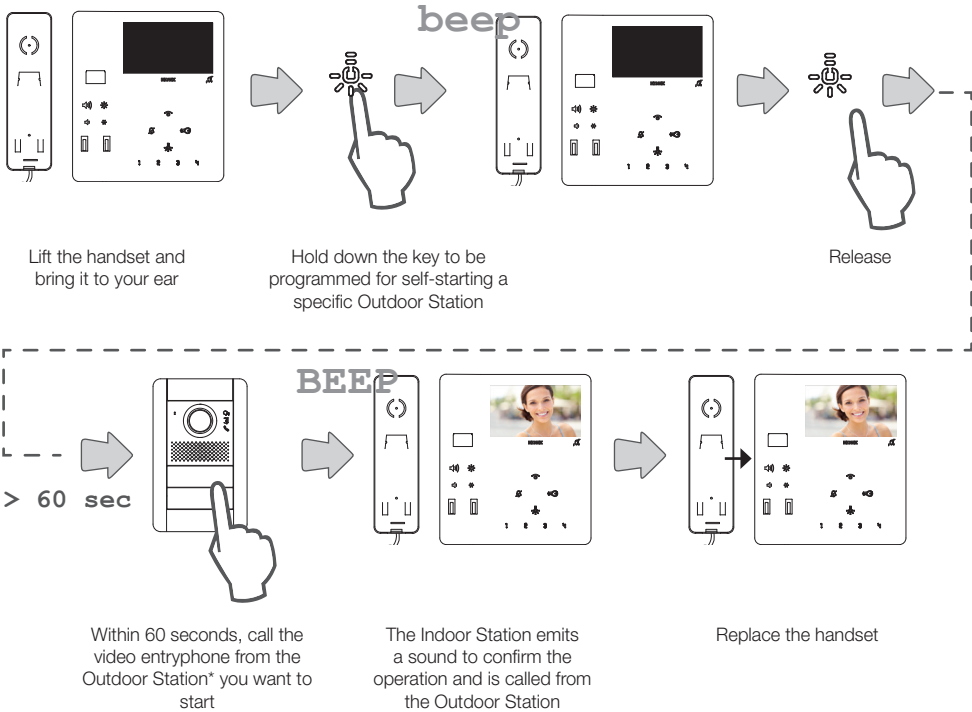
The programmable keys for this function are: 1 2 3 4  for video entryphone 7549, only  for video entryphone 7548.



****N.B.:** this procedure applies for entrance panels with push buttons and may vary according to the Outdoor Station used. For Outdoor Stations with a keypad and display, type in the ID code and confirm with the call key*

Programming the self-start key for a specific Outdoor Station (Standard programming mode)

Use this procedure to programme one of the keys on the video entryphone to perform the self-start directly on a specific Outdoor Station.

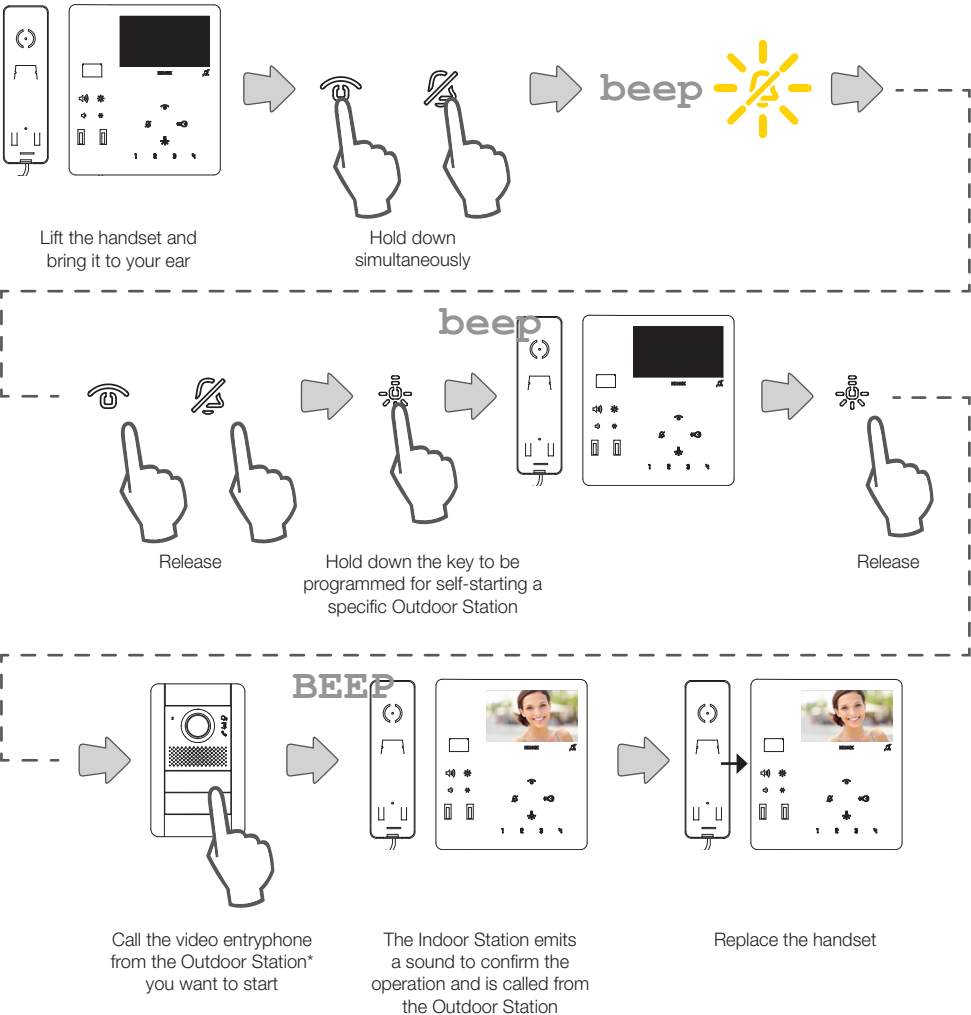

The programmable keys for this function are: 1 2 3 4  for video entryphone 7549, only  for video entryphone 7548.



***N.B.:** this procedure applies for entrance panels with push buttons and may vary according to the Outdoor Station used.
For Outdoor Stations with a keypad and display, type in the ID code and confirm with the call key

Programming a key to control a specific lock (Simplified programming mode)

Use this procedure to programme a key to control the lock release of a specific Outdoor Station.

The programmable keys for this function are: 1 2 3 4  for video entryphone 7549, only  for video entryphone 7548.

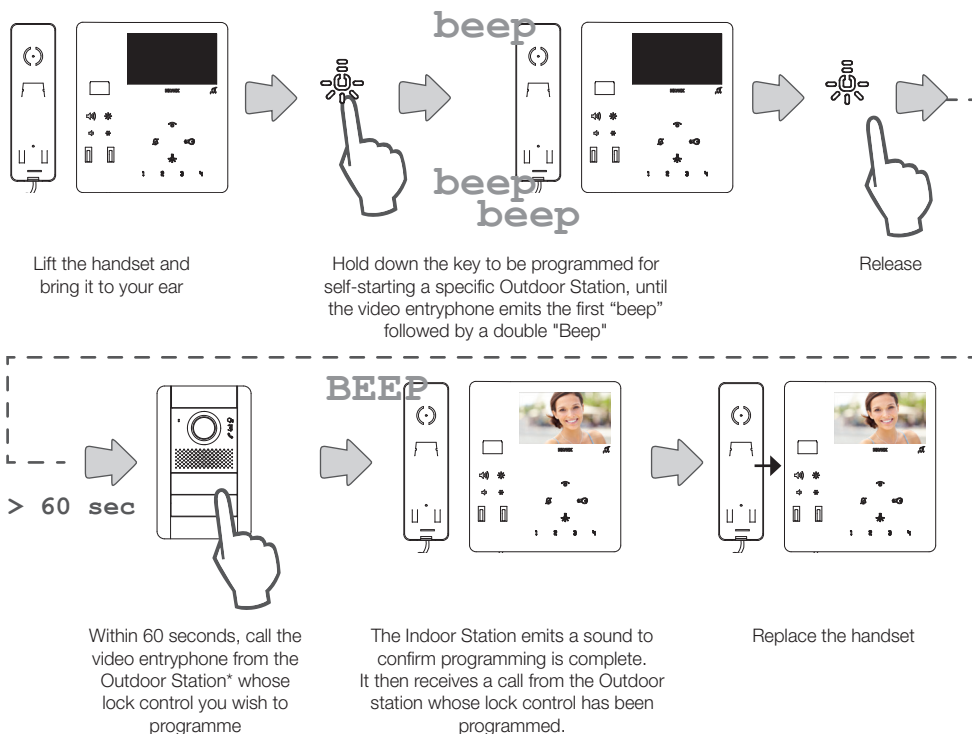

**N.B.: this procedure applies for entrance panels with push buttons and may vary according to the Outdoor Station used. For Outdoor Stations with a keypad and display, type in the ID code and confirm with the call key*

Programming display contrast and brightness levels (video signal)

Use this procedure to set the contrast and brightness levels of the display (video signal).

N.B.: configuration only available if there is an outdoor station configured as a "Master" in the system.

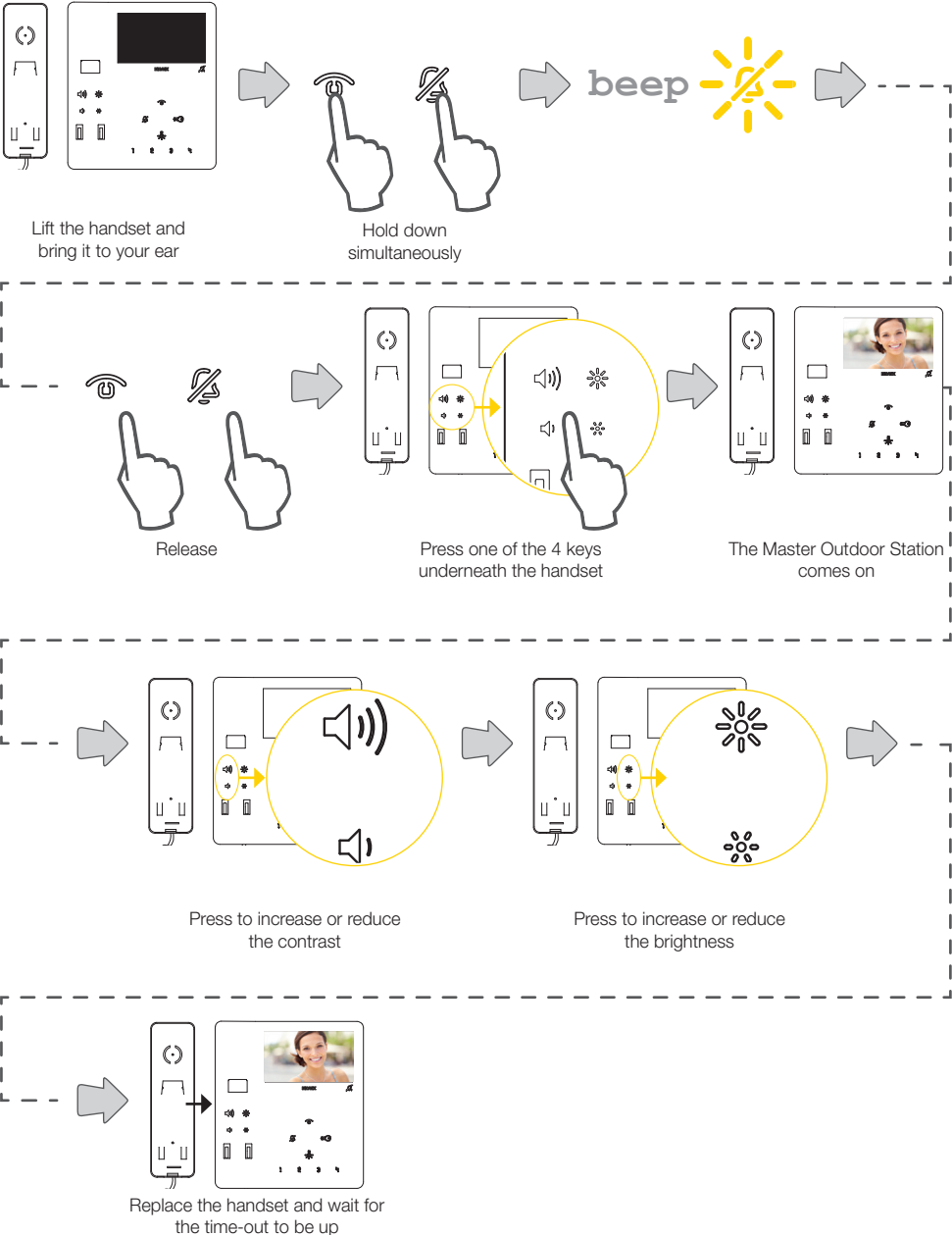

Restoring the default programming of each individual key (Simplified programming mode)

Use this procedure to restore the default programming of each individual programmable key.

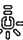
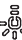
The keys that can be manually restored are: 1 2 3 4  for video entryphone 7549, only  for video entryphone 7548.

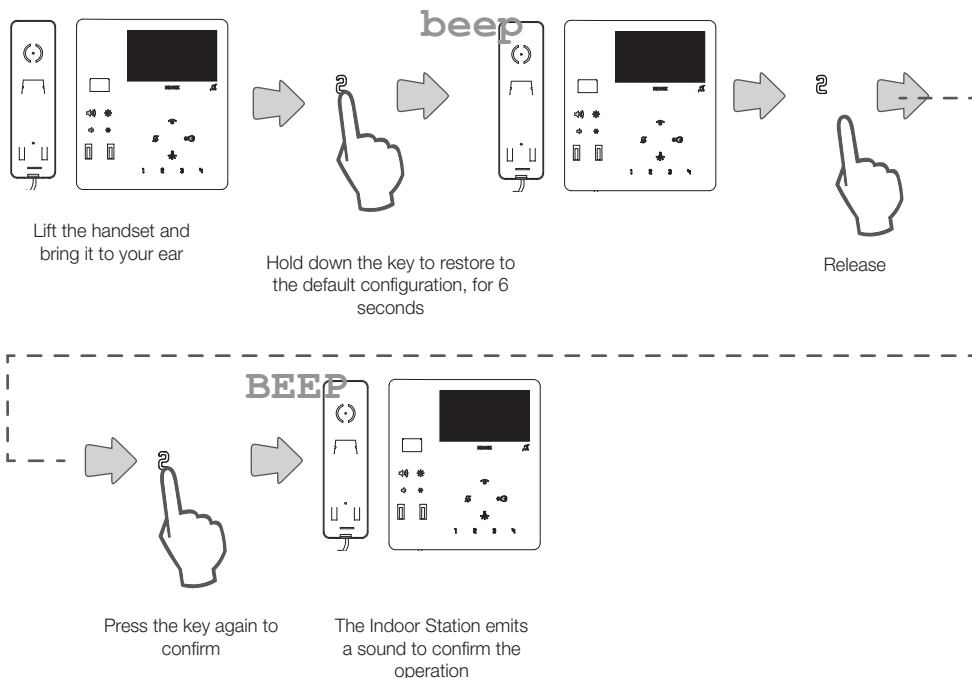

N.B.: to reprogramme the keys or restore the   keys to the default situation, use the [SaveProg](#) software

Restoring the default programming of each individual key (alternative Simplified programming mode)

Use this procedure to restore the default programming of each individual programmable key.

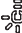
The keys that can be manually restored are: 1 2 3 4  for video entryphone 7549, only  for video entryphone 7548.

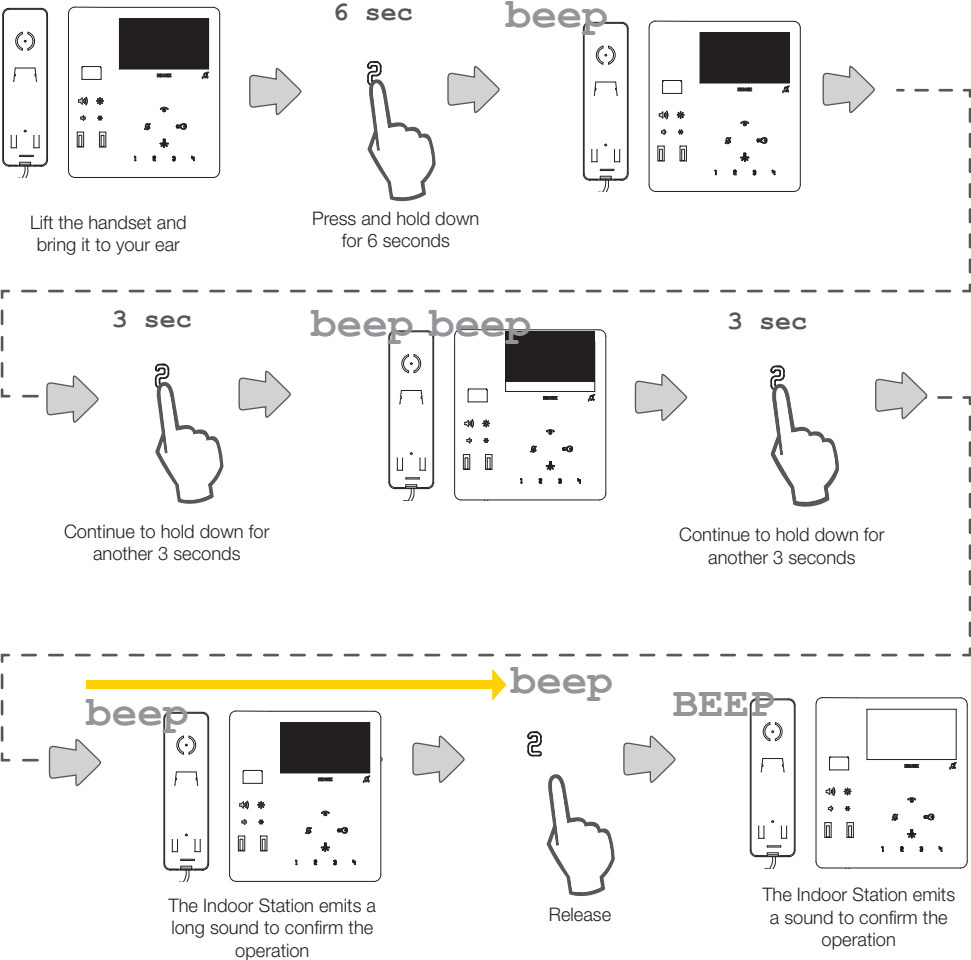

N.B.: to reprogramme the keys or restore the   keys to the default situation, use the **SaveProg** software

Restoring the default programming of each individual key (*Standard programming mode*)

Use this procedure to restore the default programming of each individual programmable key.

The keys that can be manually reprogrammed are: 1 2 3 4 .

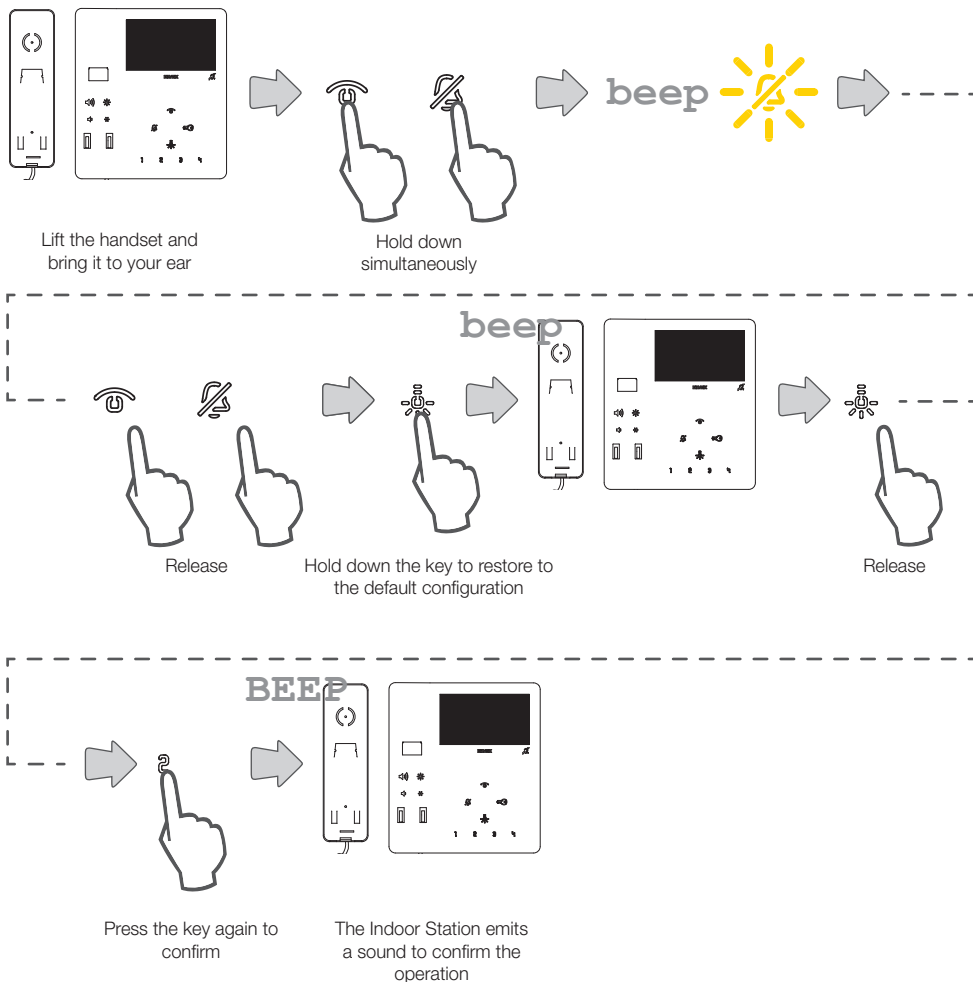

N.B.: to reprogramme the keys or restore the   keys to the default situation, use the [SaveProg](#) software

Restoring the complete default settings (Simplified programming mode)

Use this procedure to delete all the video entryphone programming (restoring it to the factory configuration)

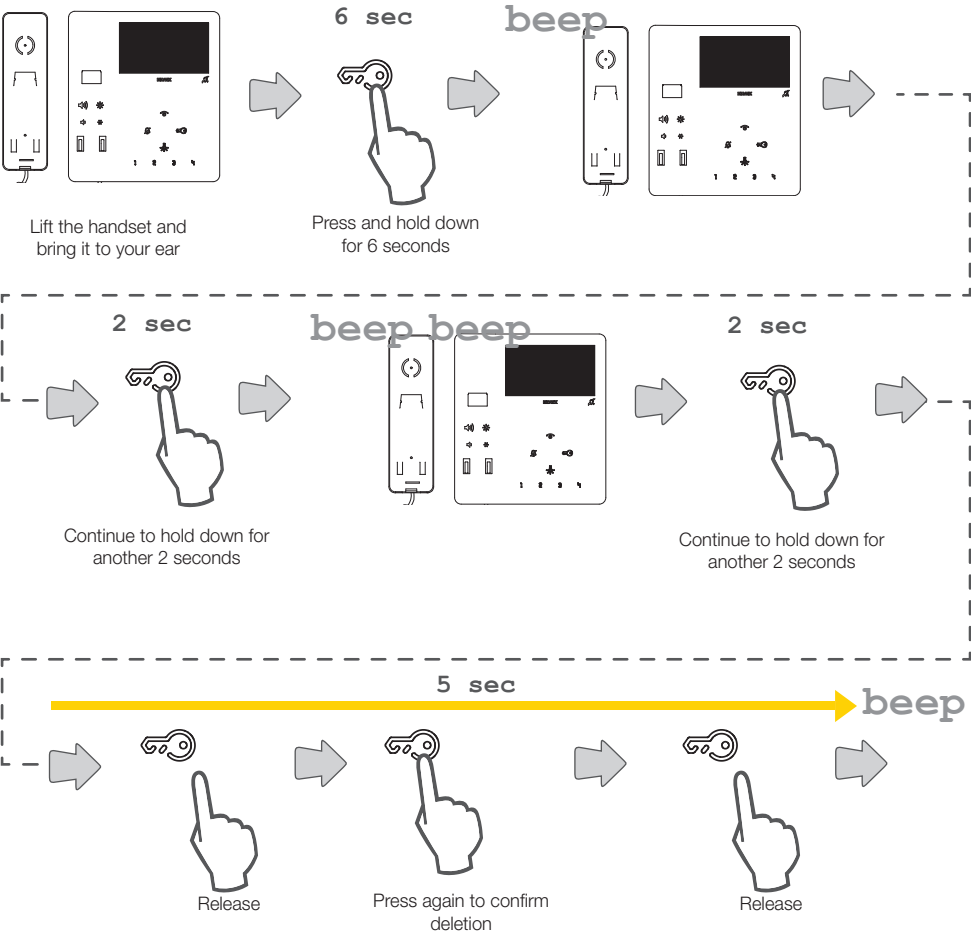

***Caution:** the following operations must be performed during the sound reproduction of the handset

Check deletion

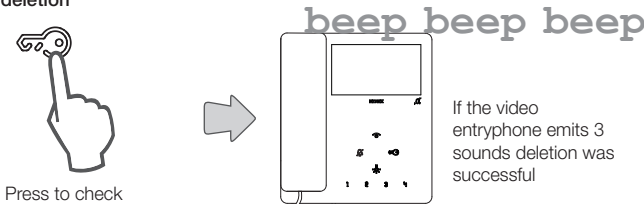

Restoring the complete default settings (Standard programming mode)

Use this procedure to delete all the video entryphone programming (restoring it to the factory configuration)

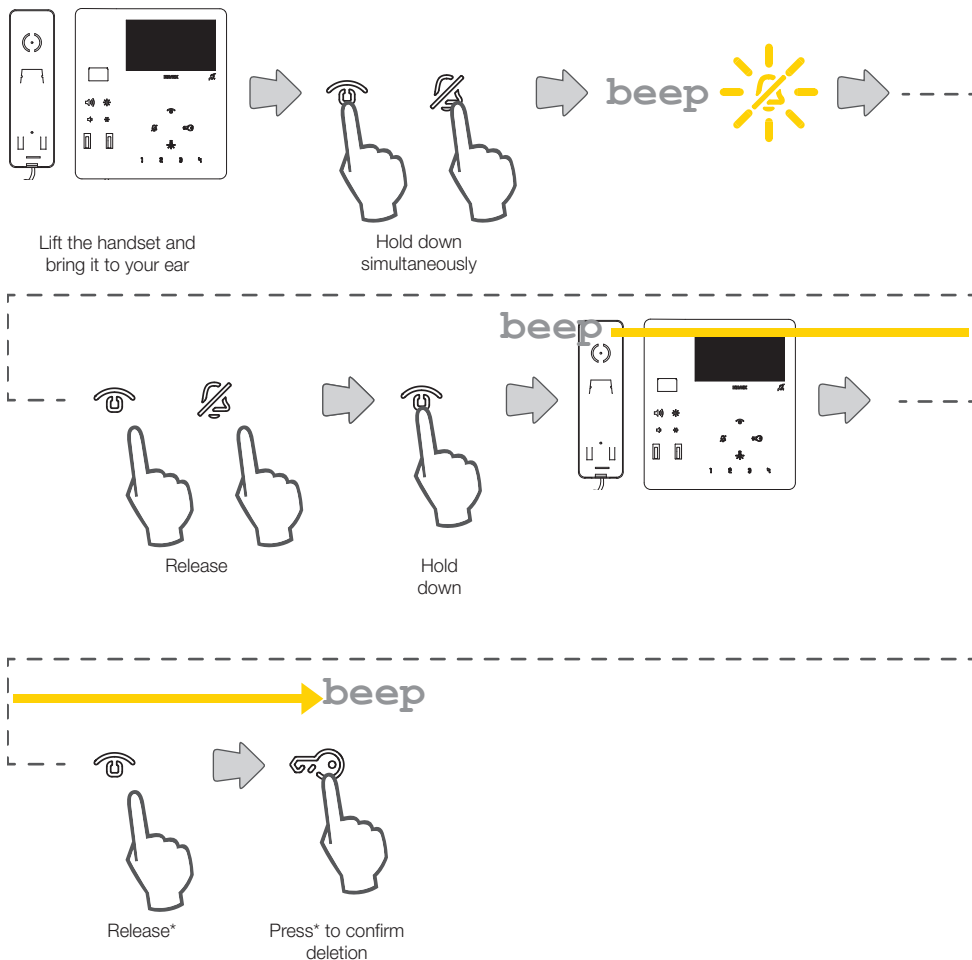

***Caution:** the following operations must be performed during the sound reproduction of the handset

Check deletion

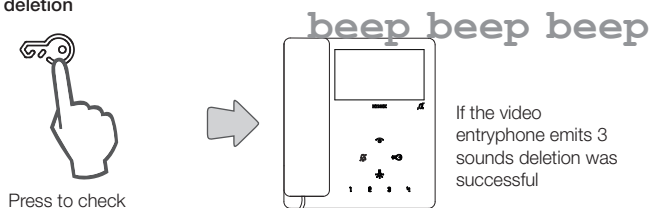

Alert function configuration via SaveProg

The appropriately configured video entryphone can send a notice to the Reception Switchboard art 40510 even if the Due Fili Plus bus is busy. Unlike other Indoor Stations, only the pair of FP-M terminals can be used as input, not the keys. In this case, the local door landing call function is lost.

The FP-M operating mode is selected using SaveProg.

1. Render the FP-M input active.
2. The Indoor Station waits to receive the alert from the switchboard.
In the meantime, the chosen signalling is sent to the user according to the table below.
On receipt of the message, the switchboard emits a double beep and displays a red envelope icon to alert the operator.
3. If it does not receive an answer, the Indoor Station resends the message every 10 seconds.
After 5 failed attempts, the Indoor Station stops sending messages.
4. When an Indoor Station receives confirmation of the receipt of the message by the switchboard, the chosen signalling is sent to the user according to the table below.
Normally the time between the sending of the request and confirmation of reception is less than a second.
5. Until the switchboard calls the Indoor Station to service the request, the Indoor Station resends the message every 120 s. At each message, the switchboard emits two beeps and increases count of messages received.
With each message the switchboard emits two beeps and increases the counter of messages received.
The counter can be viewed by opening the list of alerts in the switchboard.
The sending of messages never terminates.
It continues until the end of the service described in the next point, unless the switchboard is powered off or removed from the system, in which case the indoor station, after 5 unsuccessful attempts starting from the first timeout of 120 seconds, will return to standby mode and the Alert signal is no longer sent to the user.
6. If the switchboard operator calls and speaks to the Indoor Station from the list of warnings, and only from this, a message is sent to the Indoor Station via the Due Fili Plus bus to end the Alert procedure so the related signal is no longer sent to the user.

N.B.: *if the Indoor Station is switched off, when it is switched back on again the function starts again from the beginning.*

Alert Configuration

Use SaveProg to select some of the characteristics of the Alert function:

1. Enabling
 - a. Disabled (default)
 - b. Enabled
2. Active state polarity
 - a. Contact normally open (default)
 - b. Contact normally closed
3. Activation delay
 - a. 0.1 seconds (default)
 - b. 0.5 seconds
 - c. 1 second
 - d. 2 seconds
4. Signalling mode
 - a. None
 - b. LED associated with the Stair Light key (default)
 - c. Sound

According to the selected signalling type, apart from the first, the timer is as follows:

STATUS	LED TIMER	SOUND TIMER
The Indoor Station is waiting to receive a warning from the switchboard	Flashing with a cycle of 0.5 seconds on / 0.5 seconds off	A 2 KHz tone for 0.2 seconds
The Indoor Station has received confirmation of receipt of the message from the switchboard	Flashing with a cycle of 0.1 seconds on / 0.1 seconds off	A 1 KHz tone for 0.1 seconds

Advanced configuration with SaveProg software

Using SaveProg, you can configure the Video entryphone in an advanced manner. SaveProg is PC software designed for advanced configuration of Due Fili Plus Systems.

Advanced programming can be done using the software:

- modifying the configurations of all keys
- creating Groups
- enabling and disabling functions.

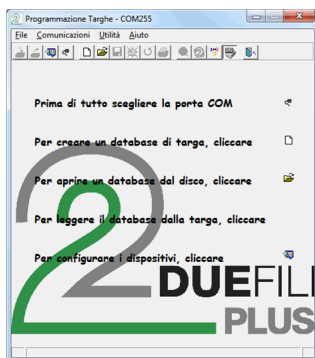

Click to open the “Device Configuration” window

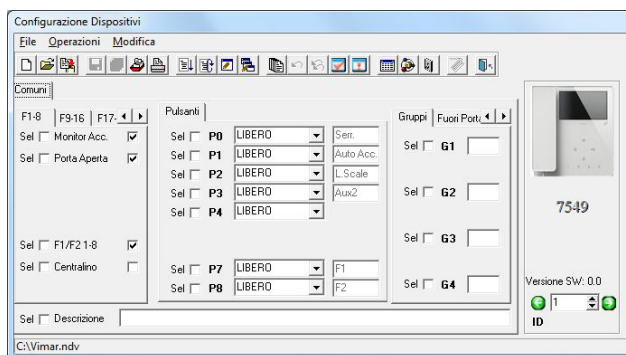

Perform the configuration and click on  to transfer it to the video entryphone

Firmware Updating

To update the device:

1. disconnect it from the Due Fili Plus bus
2. connect it to the PC via USB
3. start the WinBoot update within 30 seconds

Follow the WinBoot user instructions



Notes



49401339C0 00 2104



VIMAR

Viale Vicenza 14
36063 Marostica VI - Italy
www.vimar.com