



Shared components: Domotic logic unit

01468

Smart systems&products / By-me Plus / Shared components / DIN devices

Domotic logic unit

Unit for implementing logic, mathematical, timing and messaging functions, installation on DIN rails (60715 TH35), for By-me home automation, configurable only with EasyTool Professional, occupies 1 module size 17.5 mm



3 - Active

1 NR

- [Multilanguage instructions sheet \(487 kb\)](#)
- [Manuale installatore \(17947 kb\)](#)
- [Installer manual \(15305 kb\)](#)
- [By-me automation-fw Compatibility \(206 kb\)](#)

- [Clima2 01468](#)
- [Clima1 01468](#)

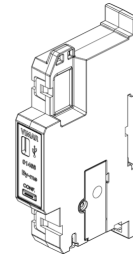
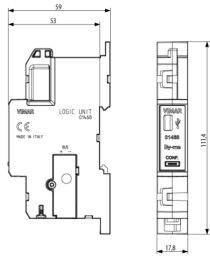

3D



- **Class group:** Installation bus systems
- **Class:** Logic component for bus system
- **Bus system KNX:** No
- **Bus system KNX-RF (Radio Frequent):** No
- **Bus system radio frequent:** No
- **Bus system LON:** No

- 00. CE Marking - EU
- 19. NOM - Mexico
- 37. Marking - Morocco
- 43. UKCA mark - Great Britain

- **Bus system Powernet:** No
- **Other bus systems:** Other
- **Mounting method:** Other
- **Width in number of modular spacings:** 1
- **With bus connection:** Yes
- **Logic object:** Yes

- 92. RoHS UAE
- 96. Electrotechnical expert ([download](#))
- 99. WEEE Directive ([download](#))



8007352512115
1 NR
14.2x6.7x5.9 [cm]
86.8 [g]

Vimar