



## Shared components: SLAVE dimmer 230V 1000W/VA

**01862**

Smart systems&products / By-me Plus / Shared components / DIN devices

### SLAVE dimmer 230V 1000W/VA

SLAVE dimmer, 230 V~ 50/60 Hz for: 40-1000 W incandescent lamps, 40-1000 VA ferromagnetic transformers, from 01861 control, protection fuse, MOSFET+TRIAC technology, for DIN (60715 TH35) rail installation, occupies 4 17,5 mm modules

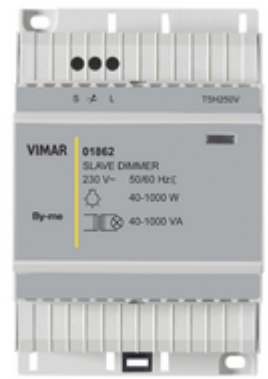

2 - Will be discontinued

1 NR

- [FI - Foglio istruzioni ZIS\\_49400254A0 \(277 kb\)](#)

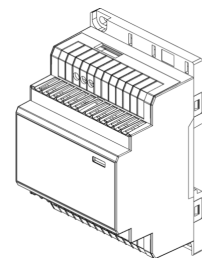
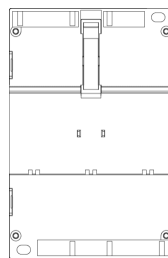
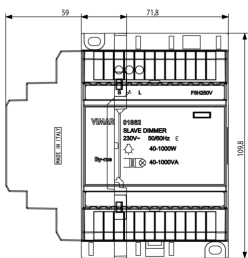

3D

- **Class group:** Installation bus systems
  - **Class:** Dimming actuator for bus system
  - **Bus system KNX:** No
  - **Bus system KNX-RF (Radio Frequent):** No
  - **Bus system radio frequent:** No
  - **Bus system LON:** No
  - **Bus system Powernet:** No
  - **Other bus systems:** Other
  - **Radio frequent bidirectional:** No
  - **Model:** Dimming actuator
  - **Mounting method:** Other
  - **Width in number of modular spacings:** 4
- **With bus connection:** No
  - **Bus module detachable:** No
  - **Local operation/hand operation:** No
  - **With LED indication:** Yes
  - **Number of outputs:** 1
  - **Output power:** 40 - 1.000 W
  - **Power boost suitable:** Yes
  - **Type of load:** Universal
  - **Voltage:** 230,00 - 230,01 V
  - **Parallel-service possible:** No
  - **Frequency:** 50,00 - 60,00 HZ
  - **Degree of protection (IP):** IP20
- 00. CE Marking - EU
  - 43. UKCA mark - Great Britain
  - 99. WEEE Directive ([download](#))



8007352387430  
 1 NR  
 11.7x10.8x7.1 [cm]  
 200.6 [g]

Vimar