



Shared components: LED emergency lamp Eikon/Arké/Plana

02662.120

Wiring devices / Traditional wiring devices / Shared components / Devices

LED emergency lamp Eikon/Arké/Plana

LED lamp, supply voltage 120 V~ 50 Hz, from MASTER dimmer or ON/OFF device control, with automatic emergency device, 3 replaceable and rechargeable 1,2 V AAA batteries, 3 hours of operating range - 3 modules. To complete with Eikon, Arké or Plana cover plates



2 - Will be discontinued

1 NR

- [FI - Foglio istruzioni ZIS_49400505B0 \(2098 kb\)](#)
- [SI - Schemi Installativi ZIS_120 V Insta \(2052 kb\)](#)

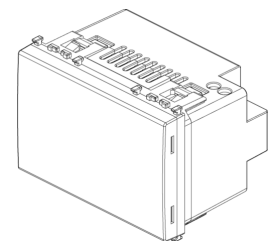
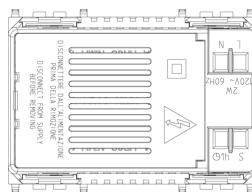
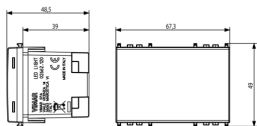

3D

- **Class group:** Luminaires
- **Class:** Emergency luminaire
- **Monitoring equipment:** None
- **With remote switch connection:** Yes
- **Power supply system:** Peripheral (individual battery)
- **Battery quality:** NiMH
- **Lamp type:** LED not exchangeable
- **With light source:** Yes
- **Housing colour:** White
- **Voltage type:** AC

- **Nominal voltage:** 120,00 - 120,01 V
- **Degree of protection (IP):** IP40
- **Protection class:** II
- **Max. system power:** 2,50 W
- **Rated luminous flux according to IEC 62722-2-1:** 50
- **Width:** 67,30 mm
- **Height/depth:** 48,50 mm
- **Length:** 49,00 mm
- **Built-in width:** 67,30 mm
- **Built-in height/depth:** 39,00 mm

- 00. CE Marking - EU
- 37. Marking - Morocco
- 43. UKCA mark - Great Britain

- 96. Electrotechnical expert ([download](#))
- 99. WEEE Directive ([download](#))



8007352487819
 1 NR
 11.2x9.6x9.8 [cm]
 171.5 [g]

Vimar