



PLANA: Button 1M w/o Symbol simple push white

14531

Smart systems&products / By-me Plus / PLANA / Buttons

Button 1M w/o Symbol simple push white

Interchangeable 1-module button, without symbol, for simple push buttons, white

2 - Will be discontinued

1 NR



14751 - 2 half buttons 1M
w/o symbol cust. white

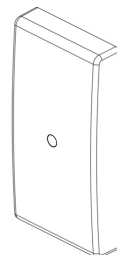
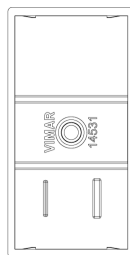
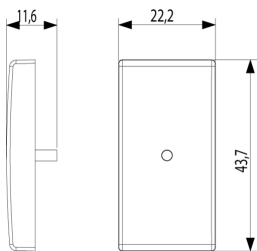

3D

- **Class group:** Installation bus systems
- **Class:** Touch rocker for bus system
- **Bus system KNX:** No
- **Bus system KNX-RF (Radio Frequent):** No
- **Bus system radio frequent:** No
- **Bus system LON:** No
- **Bus system Powernet:** No
- **Other bus systems:** None

- **Radio frequent bidirectional:** No
- **Material:** Plastic
- **Material quality:** Thermoplastic
- **Surface protection:** Other
- **Surface finishing:** Glossy
- **Colour:** White
- **RAL-number (similar):** 9003
- **Transparent:** No

• 01. IMQ - Italy ([download](#))

• 96. Electrotechnical expert ([download](#))

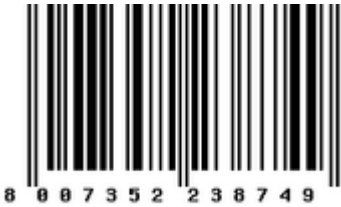

8007352238749
1 NR
2.22x4.37x1.2 [cm]
4 [g]



8007352238756
20 NR
12.3x9.6x5.1 [cm]
113.2 [g]

Vimar