



PLANA: Power supply 32Vdc 100mA 1M white

14580

Smart systems&products / By-me Plus / PLANA / Devices

Power supply 32Vdc 100mA 1M white

Supply unit with 32 V d.c. 100 mA output, supply voltage 110-230 V~ 50-60 Hz, white - 1 module

3 - Active

1 NR

- [Sound System technical catalogue - IT \(32460 kb\)](#)
- [Multilanguage instructions sheet \(464 kb\)](#)

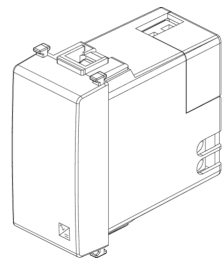
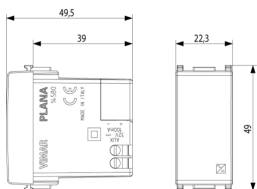

3D

- **Class group:** Installation bus systems
- **Class:** Power supply for bus system
- **Bus system KNX:** No
- **Bus system KNX-RF (Radio Frequent):** No
- **Bus system radio frequent:** Yes
- **Bus system LON:** No
- **Bus system Powernet:** No

- **Other bus systems:** None
- **Mounting method:** Flush-mounted
- **Width in number of modular spacings:** 1
- **With LED indication:** No
- **Bus voltage stockable:** No
- **Number of lines to feed:** 1
- **Max. output current:** 100,00 mA

- 00. CE Marking - EU
- 37. Marking - Morocco
- 43. UKCA mark - Great Britain

- 96. Electrotechnical expert ([download](#))
- 99. WEEE Directive ([download](#))



8 007352400252

8007352400252
1 NR
5.1x4.3x5.3 [cm]
49 [g]



8 007352400269

8007352400269
5 NR
14.4x11.6x6 [cm]
291.8 [g]

Vimar