



## PLANA: Plate 2centrM techn. white

**14652.01**

Wiring devices / Traditional wiring devices / PLANA / Cover plates

### Plate 2centrM techn. white

2-central-module cover plate, technopolymer, white

3 - Active

10 NR



14612 - Frame 2centralM  
+screws

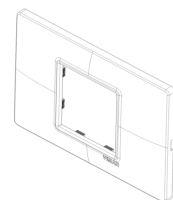
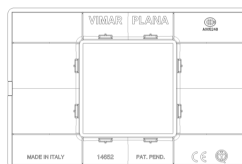
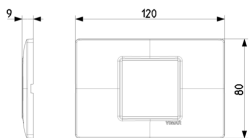

3D



- **Class group:** Domestic switching devices
- **Class:** Cover frame for domestic switching devices
- **Number of units:** 2
- **Mounting direction:** Horizontal and vertical
- **Number of units horizontal:** 2
- **Number of units vertical:** 1
- **Number of modules horizontal (module system):** 2
- **Number of modules vertical (module system):** 1
- **With mounting grid:** Yes
- **Suitable for subfloor installation duct box:** Yes
- **Suitable for wall duct:** Yes
- **Suitable for built-in installation:** Yes
- **Label space/information surface:** Yes
- **Material:** Plastic
- **Material quality:** Thermoplastic
- **Halogen free:** Yes
- **Surface protection:** Untreated
- **Surface finishing:** Glossy
- **Colour:** White
- **RAL-number (similar):** 9016
- **Transparent:** No
- **With hinged lid:** No
- **Degree of protection (IP):** IP00
- **Type of fastening:** Clamp mounting
- **Width:** 120,00 mm
- **Height:** 80,00 mm
- **Depth:** 9,00 mm
- **Built-in width:** 120,00 mm
- **Built-in height:** 80,00 mm
- **Diameter bore hole (opening):** 0 mm
- 00. CE Marking - EU
- 01. IMQ - Italy ([download](#))
- 29. QCERT - Colombia
- 43. UKCA mark - Great Britain



8 007352120136

8007352120136  
1 NR  
17x8x0.9 [cm]  
20 [g]



8 007352120143

8007352120143  
10 NR  
14.1x9.8x9.9 [cm]  
235.6 [g]



8 007352635029

8007352635029  
480 NR  
59x39x31.5 [cm]  
12,108 [g]



8 007352588202

8007352588202  
5,120 NR  
120x80x105 [cm]  
127,627 [g]

Vimar