



PLANA: Plate 2centrM techn. matt silver

14652.20

Wiring devices / Traditional wiring devices / PLANA / Cover plates

Plate 2centrM techn. matt silver

2-central-module cover plate, technopolymer, matt silver

3 - Active

10 NR



14612 - Frame 2centralM
+screws

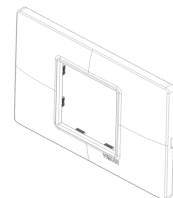
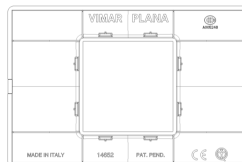
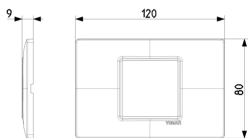

3D

- **Class group:** Domestic switching devices
- **Class:** Cover frame for domestic switching devices
- **Number of units:** 2
- **Mounting direction:** Horizontal and vertical
- **Number of units horizontal:** 2
- **Number of units vertical:** 1
- **Number of modules horizontal (module system):** 2
- **Number of modules vertical (module system):** 1
- **With mounting grid:** Yes
- **Suitable for subfloor installation duct box:** Yes
- **Suitable for wall duct:** Yes
- **Suitable for built-in installation:** Yes
- **Label space/information surface:** Yes
- **Material:** Plastic
- **Material quality:** Thermoplastic

- **Halogen free:** Yes
- **Surface protection:** Lacquered
- **Surface finishing:** Glossy
- **Colour:** Silver
- **RAL-number (similar):** 9006
- **Transparent:** No
- **With hinged lid:** No
- **Degree of protection (IP):** IP00
- **Type of fastening:** Clamp mounting
- **Width:** 120,00 mm
- **Height:** 80,00 mm
- **Depth:** 9,00 mm
- **Built-in width:** 120,00 mm
- **Built-in height:** 80,00 mm
- **Diameter bore hole (opening):** 0 mm

- 00. CE Marking - EU
- 01. IMQ - Italy ([download](#))

- 29. QCERT - Colombia
- 43. UKCA mark - Great Britain



8007352120259
1 NR
17x8x0.9 [cm]
20.4 [g]



8007352120266
10 NR
14.1x9.8x9.9 [cm]
251.4 [g]



8007352639751
480 NR
59x39x31.5 [cm]
12,867.2 [g]