



PLANA: Four half-buttons 1M O symbol Silver

14841.0.SL

Smart systems&products / KNX / PLANA / Buttons

Four half-buttons 1M O symbol Silver

Four interchangeable half-buttons, 1 module, O symbol, Silver

2 - Will be discontinued

1 NR

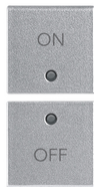
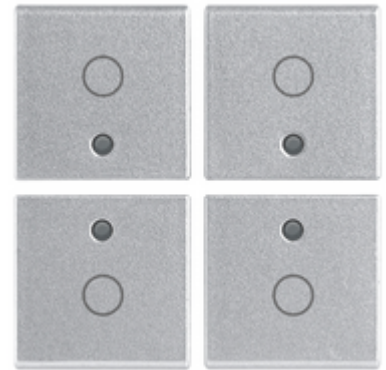

14751.1.SL - 2 half buttons
1M ON/OFF symbol Silver

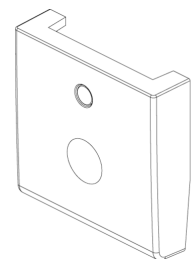
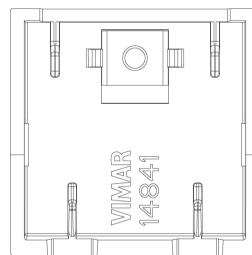
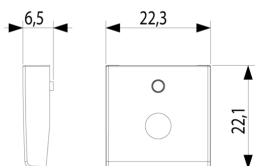

3D

- **Class group:** Domestic switching devices
- **Class:** Control element/cover plate for domestic switching devices
- **Model:** Other
- **Imprint/indication:** Symbol 0
- **Utilization:** Switch/push button
- **Suitable for touch sensor connector for bus system:** No
- **Type of fastening:** Clamp mounting
- **Monitoring window/light outlet:** Yes
- **Material:** Plastic
- **Material quality:** Thermoplastic

- **Halogen free:** Yes
- **Surface protection:** Lacquered
- **Surface finishing:** Glossy
- **Colour:** Silver
- **RAL-number (similar):** 9006
- **With label area:** No
- **With exchangeable lens/symbol:** No
- **Suitable for degree of protection (IP):** IP40
- **Depth:** 650,00 mm

- 96. Electrotechnical expert ([download](#))



8 007352383890

8007352383890
1 NR
7x5.5x0.6 [cm]
6.3 [g]



8 007352383906

8007352383906
6 NR
14.2x6.7x5.9 [cm]
68.87 [g]

Vimar