



## IDEA: Four half-buttons 1M arrow symbol grey

**16841.3**

Smart systems&products / KNX / IDEA / Buttons

### Four half-buttons 1M arrow symbol grey

Four interchangeable half-buttons, 1 module, directional arrows symbol, grey

3 - Active

1 NR

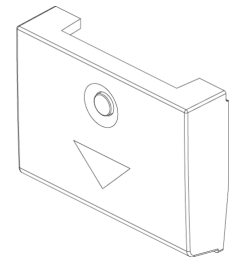
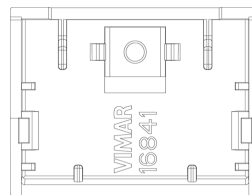
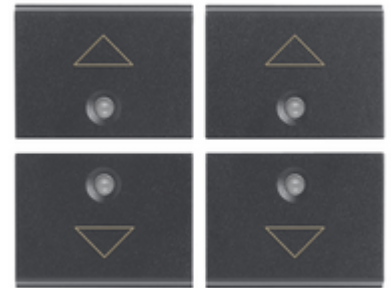

3D

- **Class group:** Domestic switching devices
- **Class:** Control element/cover plate for domestic switching devices
- **Model:** Other
- **Imprint/indication:** Symbol arrows
- **Utilization:** Switch/push button
- **Suitable for touch sensor connector for bus system:** No
- **Type of fastening:** Clamp mounting
- **Monitoring window/light outlet:** Yes
- **Material:** Plastic
- **Material quality:** Thermoplastic
- **Halogen free:** Yes
- **Surface protection:** Untreated
- **Surface finishing:** Matt
- **Colour:** Grey
- **RAL-number (similar):** 7015
- **With label area:** No
- **With exchangeable lens/symbol:** No
- **Suitable for degree of protection (IP):** IP40
- **Depth:** 650,00 mm

- 96. Electrotechnical expert ([download](#))



8007352384491  
1 NR  
5x1.9x1.3 [cm]  
5.19 [g]



8007352384507  
6 NR  
14.2x6.7x5.9 [cm]  
62.12 [g]

Vimar