



IDEA: Four half-buttons 1M w/o symbol white

16841.B

Smart systems&products / KNX / IDEA / Buttons

Four half-buttons 1M w/o symbol white

Four interchangeable half-buttons, 1 module, without symbol, white

3 - Active

1 NR

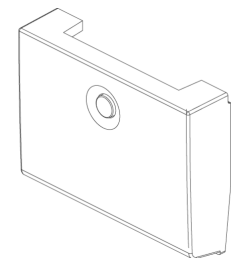
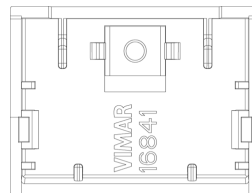
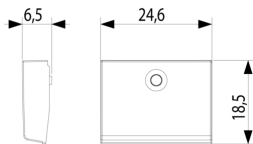

3D

- **Class group:** Domestic switching devices
- **Class:** Control element/cover plate for domestic switching devices
- **Model:** Other
- **Imprint/indication:** None
- **Utilization:** Switch/push button
- **Suitable for touch sensor connector for bus system:** No
- **Type of fastening:** Clamp mounting
- **Monitoring window/light outlet:** Yes
- **Material:** Plastic
- **Material quality:** Thermoplastic

- **Halogen free:** Yes
- **Surface protection:** Untreated
- **Surface finishing:** Matt
- **Colour:** Grey
- **RAL-number (similar):** 9001
- **With label area:** No
- **With exchangeable lens/symbol:** No
- **Suitable for degree of protection (IP):** IP40
- **Depth:** 650,00 mm

- 96. Electrotechnical expert ([download](#))



8 0 0 7 3 5 2 3 8 4 3 5 4

8007352384354
1 NR
5x1.9x1.3 [cm]
5.19 [g]



8 0 0 7 3 5 2 3 8 4 3 6 1

8007352384361
6 NR
14.2x6.7x5.9 [cm]
62.12 [g]

Vimar