



IDEA: Two half-buttons 2M O symbol grey

16842.0

Smart systems&products / KNX / IDEA / Buttons

Two half-buttons 2M O symbol grey

Two interchangeable half-buttons, 2 modules, O symbol, grey

3 - Active

1 NR

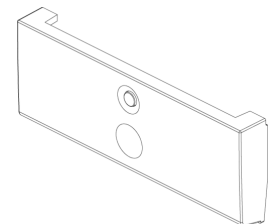
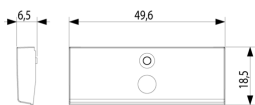
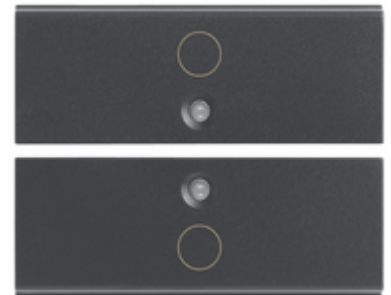

3D

- **Class group:** Domestic switching devices
- **Class:** Control element/cover plate for domestic switching devices
- **Model:** Two-part button
- **Imprint/indication:** Symbol 0
- **Utilization:** Switch/push button
- **Suitable for touch sensor connector for bus system:** No
- **Type of fastening:** Clamp mounting
- **Monitoring window/light outlet:** Yes
- **Material:** Plastic
- **Material quality:** Thermoplastic

- **Halogen free:** Yes
- **Surface protection:** Untreated
- **Surface finishing:** Matt
- **Colour:** Grey
- **RAL-number (similar):** 7015
- **With label area:** No
- **With exchangeable lens/symbol:** No
- **Suitable for degree of protection (IP):** IP40
- **Depth:** 650,00 mm

- 96. Electrotechnical expert ([download](#))



8007352384613
1 NR
5x3.7x0.6 [cm]
4.54 [g]



8007352384620
6 NR
14.2x6.7x5.9 [cm]
58.15 [g]

Vimar