



LINEA: 2-button voice control+actuat.3M black

---

## 30815.G

Smart systems&products / View smart system / LINEA / Devices

### 2-button voice control+actuat.3M black

Amazon Alexa built-in vocal control device with built-in Wi-Fi and two front buttons, RGB LED backlighting, 1 input for wired push button, 1 NO relay output 100-240 V 50/60 Hz for 500 W incandescent lamps, 100 W LED lamps, 250 VA electronic transformers, 120 W fluorescent lamps, local or remote control, designed for use on VIEW Wireless mesh system thanks to IoT technology on Bluetooth technology 5.0 standard and on By-me Plus system thanks to the By-me bus, 100-240 V 50/60 Hz power supply, black - 3 modules. To be completed with Linea cover plates.

- Control with on-board relay, with dual technology for View Wireless smart systems (Bluetooth 5.0 mesh technology), and for By-me Plus wired home automation systems
- Equipped with two programmable electronic microswitch push buttons with RGB back lighting and adjustable brightness for visible in darkness and a relay with zero crossing technology to control one light
- Built-in Amazon Alexa vocal interface for use to control the on-board relay, to listen to music and control all Amazon Alexa compatible devices; specifically, via the VIEW skill - both on View Wireless and By-me Plus systems - it is designed to operate lights, handle curtains and roller shutters, control climate, call up scenarios, and via the VIEW Product skill, it is designed to control multi-sockets, Vimar connected adaptors and Elvox Wi-Fi cameras. All the products supported can be inter-connected to create - in the form of routines - simple automations that make the smart system even smarter



3 - Active

1 NR

- [Light multilanguage instructions sheet \(5044 kb\)](#)
- [Foglio istruzioni Full \(4567 kb\)](#)
- [Feuille d'instructions Full \(4570 kb\)](#)
- [Hoja de instrucciones Full \(4567 kb\)](#)
- [Full instructions sheet \(4564 kb\)](#)
- [Φυλλάδιο οδηγιών Full \(4712 kb\)](#)
- [Anweisungsblatt Full \(4569 kb\)](#)
- [Full \(4647 kb\)](#)

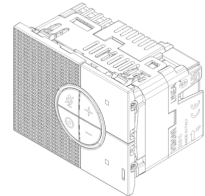
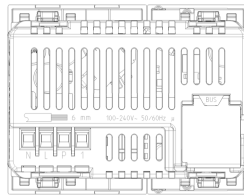
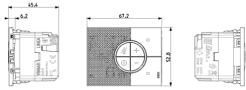

3D

- **Class group:** Installation bus systems
- **Class:** Multi operating device for bus system
- **Bus system KNX:** No
- **Bus system KNX-RF (Radio Frequent):** No
- **Bus system radio frequent:** Yes
- **Bus system LON:** No
- **Bus system Powernet:** No
- **Other bus systems:** Other
- **Radio frequent bidirectional:** Yes
- **Mounting method:** Flush-mounted
- **Width in number of modular spacings:** 3
- **Number of actuation points:** 1
- **With display:** No
- **Status-LED:** Yes
- **IR sensor:** No
- **Manual set point setting:** No
- **Presence button:** No
- **With temperature controller:** No
- **With integrated DCF77 receiver:** No
- **With time switch clock:** Yes
- **With anti-theft/dismantling protection:** No
- **Central functional unit for senders/actuators:** Yes
- **Material:** Plastic
- **Material quality:** Thermoplastic
- **Surface protection:** Untreated
- **Surface finishing:** Matt
- **Colour:** Black
- **RAL-number (similar):** 7021
- **Transparent:** No
- **Degree of protection (IP):** IP20
- **With bus connection:** Yes

- 00. CE Marking - EU
- 37. Marking - Morocco
- 40. Bluetooth technology
- 43. UKCA mark - Great Britain
- 46. UK PSTI compliance ([download](#))
- 99. WEEE Directive ([download](#))

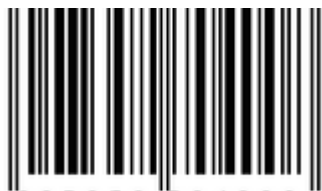

8 007352 704008

8007352704008  
1 NR  
10.8x8.7x5.9 [cm]  
150 [g]

Vimar