



## Switchboards: Flush mounting box for V53172

### V53372

System infrastructure / Enclosures and control units / Switchboards / Flush mounting

### Flush mounting box for V53172

Flush mounting box for 72-module consumer unit (GW 650 °C) for masonry walls, light blue. Dimensions 426x723x100 mm

3 - Active

3 NR

- [Flush mounting consumer units](#)

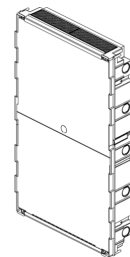
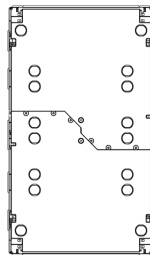
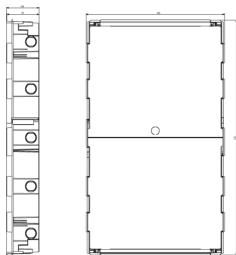

3D

- **Class group:** Distribution boards
- **Class:** Empty cabinet
- **Mounting method:** Flush-mounted
- **Type of covering:** None
- **Cover model:** None
- **Type of door:** None
- **Transparent cover/door:** No
- **With lock:** No
- **Nominal current (In):** 0 A
- **Height:** 723 mm
- **Width:** 426 mm
- **Depth:** 100,00 mm
- **Built-in depth:** 100,00 mm
- **Inner depth:** 98,00 mm
- **Colour:** Other

- **RAL-number:** 0
- **Number of modules:** 72
- **Number of rows:** 4
- **Width in number of modular spacings:** 72
- **Number of openings for flange plates:** 0
- **Extension possible:** No
- **Number of conduit inlets:** 26
- **Housing material:** Plastic
- **Surface protection:** Untreated
- **With mounting plate:** No
- **Suitable for outdoor use:** No
- **Suitable for lightning protection:** No
- **Degree of protection (IP):** IP40
- **Protection class:** II
- **Circuit integrity:** None

• 01. IMQ - Italy ([download](#))

• 96. Electrotechnical expert ([download](#))



8007352509979  
1 NR  
42.6x72x10 [cm]  
1,591.1 [g]



8007352509986  
3 NR  
72x31x43 [cm]  
5,950.8 [g]

Vimar