



## Fixing and tools: Junction box cover screw 50mm

### V70199

System infrastructure / Enclosures and control units / Fixing and tools / Fixing

### Junction box cover screw 50mm

Screw, 50 mm long, for cover fixing



3 - Active



50 NR

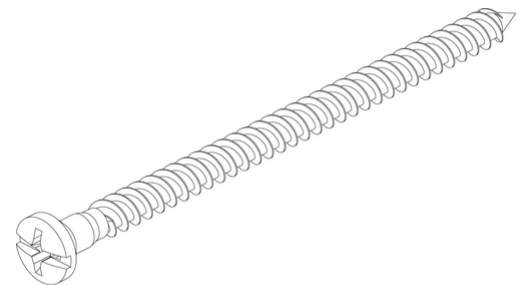
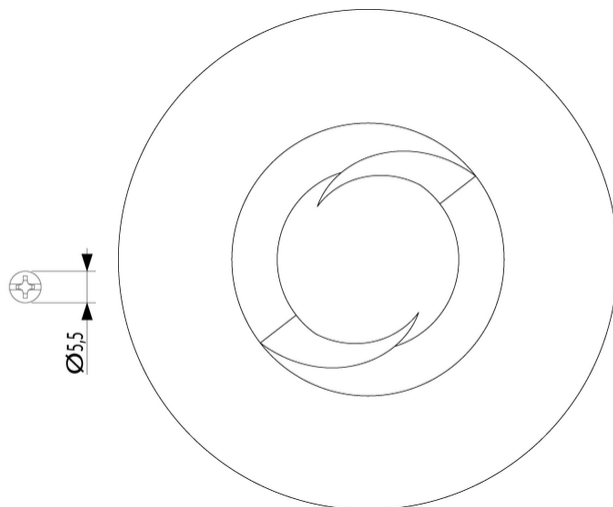
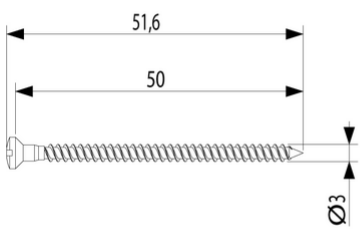

3D 



**Class group:** Fasteners and anchoring systems

**Class:** Wing bolt

**Width:** 3,00 mm

**Total height:** 50 mm

**Thread length:** 50,00 mm



8 007352 312340

8007352312340

**Qtà** 1 NR  
 5.2x0.5x0.5 [cm]  
 25.47 [g]



8 007352 312357

8007352312357

**Qtà** 50 NR  
 11.5x10.5x1.5 [cm]  
 101.8 [g]



8 007352 312364

8007352312364

**Qtà** 200 NR  
 13.9x8.9x5.4 [cm]  
 439.07 [g]



V70006 - Flush junction box 195x154x70mm



V70007 - Flush junction box 287x154x70mm



V72006 - Junction box hollow walls 205x164x73,5mm



V72007 - Junction box hollow walls 298x164x73,5mm



V70005 - Flush junction box 154x128x70mm



V70008 - Flush junction box 391x154x70mm



V70009 - Flush junction box 479x154x70mm

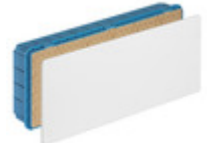

V70010 - Flush junction box 515x201x80mm



V70001 - Flush junction box 92x92x50mm



V70002 - Flush junction box 116x92x50mm



V70003 - Flush junction box 116x92x70mm



V70004 - Flush junction box 154x92x70mm



V70011 - Flush junction box 515x292x80mm



V70207 - Flush junction box 248x248x120mm



V70211 - Flush junction box 515x248x120mm



V72008 - Junction box hollow walls 402x164x73,5mm



V72009 - Junction box hollow walls 490x164x73,5mm



V72211 - Junction box hollow walls 533x263x120mm

