



CATALOGUE
english

ELVAX DOOR ENTRY





SEE, HEAR AND TALK WITH THE EXTERIOR OF THE DWELLING AND MORE BESIDES.

Seeing what goes on outside the home, recognising those who ring our doorbell and communicating accurately are all crucial operations for living a quiet life. This is why we need access to advanced solutions based on innovative technology that can ensure the security and clarity we require by simultaneously combining user-friendliness with a system that is simple to install. Not to mention a sharp focus on design and typically stylish Italian production, which provides essential added value.

> When technology is high-performance the solutions multiply.

Due Fili Plus technology can be easily used to create even large systems, guaranteeing the highest performance in any type of building, from small homes to large residential complexes. A high-performance system that is capable of accurately meeting all building requirements.



> The complete range.

A wide selection of video door entry units, door entry units and outdoor panels for residential and tertiary settings. All products vary in size, design, structure, type of system, functions and installations. They all share high structural quality, attention to design, easy installation and use.



DUE FILI PLUS TECHNOLOGY.

Due Fili Plus is a rapid, flexible and precise technology used to create high-performing video and audio door entry communication systems in all types of building, whether new constructions or restructuring works, in the simplest possible way. Due Fili Plus technology ensures perfect connections between all the devices through which power, audio, video and data pass.

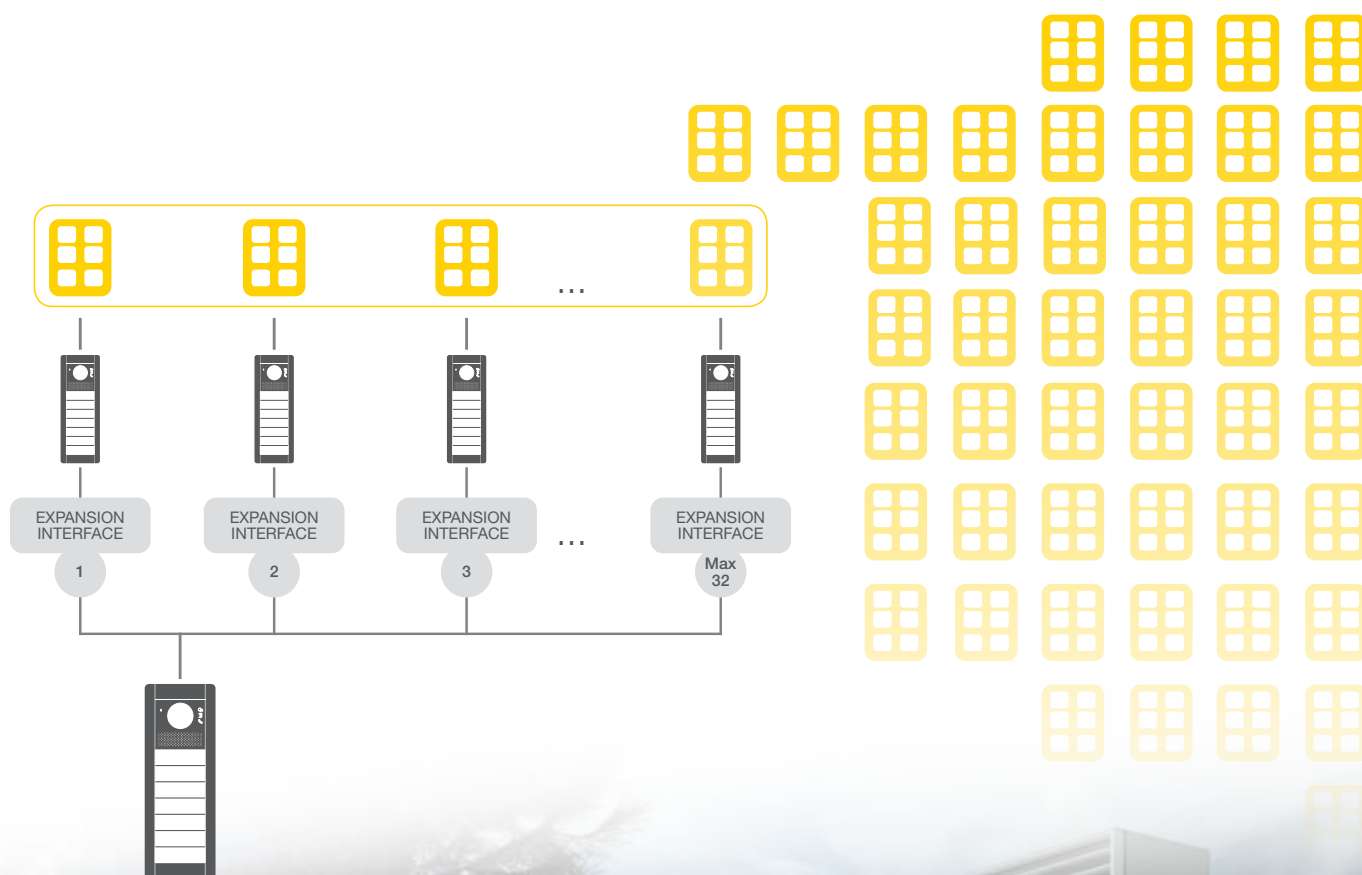

> Performance.



Up to 6400 indoor units.

With Due Fili Plus technology, you can make installations which handle up to a maximum of 484 outdoor units and up to 6,400 indoor units. With the expansion interface, you can expand the system, replicating several Due Fili Plus systems with up to 32 blocks and 128 reception video-switchboards.



Up to 1200 metres.

With Due Fili Plus technology you can create huge systems, with a distance between indoor and outdoor panels of up to 1200 metres, without losing any quality of the audio or video signal. The signal is carried along a single twisted-pair cable of small diameter.



Immediate programming.

And Due Fili Plus technology ensures really simple programming. Directly from the indoor panel, the installer can programme the device with the outdoor panel. After encoding the indoor panel, the system can also simulate an audio/video call from the outdoor panel, to immediately check that the installation has been done correctly.



A comprehensive range.

An extensive selection of video entryphones, entryphones and outdoor units for residential and service industry facilities. All products vary in dimensions, design, structure, type of system, functions and mounting. They all share the same superior structural quality, attention to design, easy installation and use.



Accessible anywhere via smartphone and tablet.

Combined with the Tab 7S, the Video-Door app can receive the video call, view the video surveillance cameras or open the door, directly from your smartphone or tablet, wherever you are.

VIDEO ENTRYPHONES CONNECTED TO YOUR SMARTPHONE OR TABLET.



The new Tab 7 video entryphone, which draws its inspiration from the light weight and simple silhouette that distinguish all the models in the Tab series, is a device affording revolutionary functions teamed with stylish design. Available in 2 different versions: Tab 7 with traditional video entryphone functions, and Tab 7S which, thanks to the integrated Wi-Fi and Video Door app - allows call repetition on your smartphone, ensuring total control even when you are out and about. In short, this is a product with its sights set firmly on the future.



With Wi-Fi. You can answer the video entryphone from anywhere in the home.

The new Tab 7S video entryphones with integrated Wi-Fi are designed to communicate instantly with smartphones and tablets thanks to the new Video Door app. Just tap once to answer video entryphone calls from any room in the home, with complete freedom of movement (receive calls from the panel, make intercom calls, release the lock, activate auxiliary services, switch on the stair lights, start the irrigation system, send and receive text messages or consult recorded messages).



Video Door App, designed to make life easy for you.

- > Immediate configuration.
- > Intuitive and customizable interface.
- > Available on the Vimar website and from Apple and Google Play stores.





Answer the video entryphone.

When the door bell sounds, you can talk to whoever is standing outside from wherever you happen to be, using a smartphone or tablet.



Open the gate.

When you happen to be elsewhere, but need to let someone onto your property, you can open the gate from a smartphone or tablet. Problem solved.

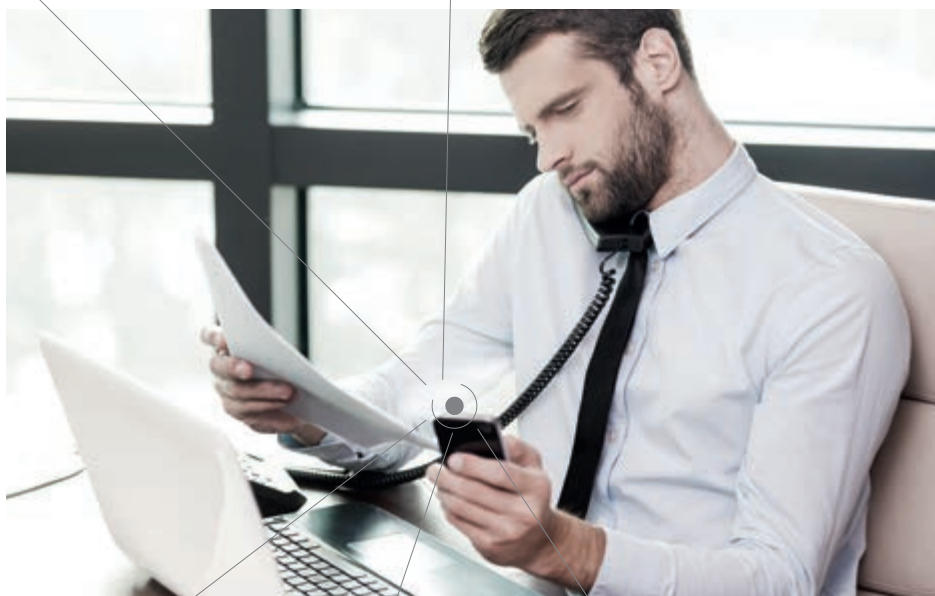

Start the sprinklers.

When on holiday or simply out and about, a simple tap on your smartphone or tablet will ensure the garden gets exactly the amount of water it needs.



Check all cameras.

A smartphone or tablet gives you round-the-clock control over all spaces, and you can always see exactly what is going on.



Intercom calls.

With the Video Door App on a smartphone, audio calls can be made with the TAB 7S to enable an immediate and direct conversation with whoever is at home.

A SOLUTION FOR EVERY NEED.

Whatever your living context, we have a solution for you, for both inside and outside the building. A full range of products responding to all style and function needs, whatever the type of building. Versatile, technologically advanced solutions for communicating easily, effectively and safely.

> Outdoor units.

Outdoor units are available in various dimensions and can be mounted in various ways, but they all have one thing in common: an elegant and sophisticated design in keeping with the most demanding architectural requirements.



> Indoor units.

Hands-free or with handset, stand alone or built into the By-me home automation system. Internal video entryphones have quality, modern and delicate finishes, with reduced thickness to blend in perfectly to any interior design solution. And always easy and intuitive to use.



PIXEL AND PIXEL HEAVY SERIES. BEAUTY AND STRENGTH.



The modular entrance panels with a slim, modern design, Pixel in aluminium with four colour variants: grey, white, slate and anodised grey and Pixel Heavy, the version in zama, with a single special sable grey finish that is more resistant to knocks and atmospheric agents, with degree of protection IK09, IK10 and IP54, all represent a timeless panel. With great modularity, Pixel can be composed as you wish, responding perfectly to actual installation needs.

Video camera with wide-angle lens.

The audio/video module has a video camera with a wide-angle lens and high-definition recording. A zoom function can also be set from the internal units, where multiple recording frames can also be browsed.

Video camera recording range

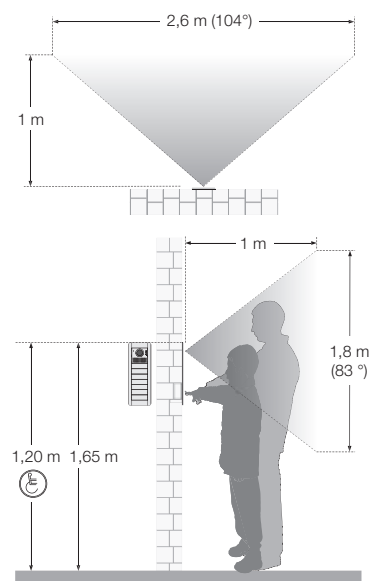

High sensitivity and automatic lighting control.

The sensor sensitivity recognises guests even in poor lighting. The luminous intensity of the lighting LEDs is automatically adjusted according to the surrounding luminous intensity.



Echo Canceller and noise reduction.

Echo Canceller means you can have a natural, two-way conversation, automatically avoiding annoying audio feedback (Larsen effect). You will hear loud and clear thanks to the Noise Reduction function.

Automatic gain control.

Sound levels are always outstanding thanks to automatic gain control (AGC) and voice activity detection (VAD).

Back-lit LED buttons.

The call buttons have LED back-lighting with white LEDs for maximum readability of names. Back-lighting and the intensity setting is controlled by the integrated dusk/dawn sensor.

Up to 4 buttons in a single module.

The audio or audio/video module, the heart of the panel, comes with 4 push buttons in double file for installation in small residential contexts.



Impaired hearing function and voice synthesis for non-sighted users.

The first function allows hearing aid wearers fitted with T type magnetic interface prostheses to listen to conversations in the acoustic device; the second offers the non-sighted the chance to listen to a voice message which the specifically programmed panel reproduces for each command.



Visual call indicators.

A LED on the front indicates the calls in progress and any active communications, if the lock control is enabled or a missed call if the line is busy.

IP54

IK08

IP54

IK10



Impact resistance and degree of protection.

Pixel is an aluminium panel affording a high degree of protection against atmospheric agents (IP54) and against impacts (IK08). Pixel Heavy in zamak is even more resistant, with IK09 and IK10 ratings.

Flexible, modular development, from 1 to 84 calls.

Pixel and Pixel Heavy can be used to create various combinations according to need, starting from 1, 2 and 3 vertical modules and up to 3 rows horizontally, for a composition of 9 modules and allowing up to 84 calls.

Pixel composition options.

Owing to the availability of different-sized push buttons, Pixel can be composed freely to accommodate specific installation requirements.



Double axial
button
(one call)



Single axial
button
(two calls)



Double row single
rocker button
(four calls)

Grey

Slate

Anodised
grey

White



Sable grey



Functional design and ultra-thin thickness.

Small sizes that enhance forms, the panel can be installed on metal pillars, being just 100 mm wide and standing out from the wall by just 14 mm (Pixel), 18.5 (Pixel Heavy) are the ideal solution for confined spaces.

Pixel: in aluminium with different finishes: grey, slate, white and anodised grey.

Pixel Heavy: sable grey finish.

Total compositional freedom for Pixel and Pixel Heavy panels.



LCD colour display and contacts list with up to 6.400 names.

With 3.5" colour LCD display - the largest in the modular segment - with an intuitive navigation menu it can manage up to 6.400 names. Calls can be made by scrolling the contacts list or entering the required number. And with an 80° horizontal viewing angle, the information can easily be read on the display even in back-lit conditions.

Installation responds to your needs.

Rapid front access to the audio/video unit and other expansion modules for ordinary maintenance without completely removing the panel from the support.



Expansion modules.

Pixel is a dynamic solution, as it allows you to create all the compositions you need, using additional modules and combining audio or audio/video electronic units. Every entrance panel can hold up to 5 button modules in single file and 10 in double file, alphanumeric keyboard, display with electronic contacts list or back-lit name card, biometric sensor or transponder.

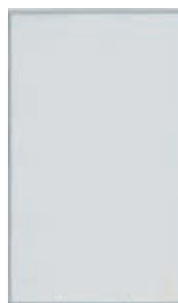

Name card or house number



Biometric sensor



Transponder

Flush mounting in series or surface mounting with rain-proof frame.

Pixel panels can be either flush mounting or surface mounting. In both cases, they guarantee great functional performance.

For mounting in series, the flush mounting boxes are fitted with a spacer that secures them tightly together. In Pixel panels, it works like a cable outlet because the void, watertight interior guarantees total protection for the wiring. Furthermore, a cardboard antimortar cover protects them during installation.

Flush mounting can be completed by adding the rain-proof frame which is incorporated into the surface mounting boxes.



Flush mounting boxes for Pixel panels



Flush mounting boxes for Pixel Heavy panels

Universal adaptors for Pixel and Pixel Heavy.

Universal adaptors are designed to mount Pixel and Pixel Heavy modular entrance panels to replace and renovate an existing entryphone or video entryphone system. Being universal, these adaptors are totally compatible with the most widely available flush mounting boxes on the market.



1300 SERIES: BUILT TO SUIT YOUR NEEDS.



Soft, modern design with non-scratch finish. The 1300 series is made from 1.8 mm thick electro-polished anodized aluminium. Designed for flush mounting and wall mounting, it has high-efficiency LED green backlighting that makes it visible even at night.

Modern and hard-wearing.

Soft, modern design with scratch-resistant finishes. The 1300 series, fitted with LED backlighting to make it easy to read even at night, is made of electro-polished anodised aluminium and can be either flush mounted or surface mounted with a rain-proof frame.



Accessories to suit any installation.

Flush mounting boxes or surface mounting boxes to meet all installation requirements, with the added optional rain-proof frame.



Versatility and customisation.

The basic cover plate comprises an audio-video module and a module with 1 push button and 3 blank modules which can be replaced by conventional push buttons. This allows you to create the keypad as you wish, with an infinite combination of cover plates and push buttons. The 1300 series is also available with an alphanumeric keypad.



One- and two-family systems.

The compact 1300 panel (13K1), which is 168 mm high, is supplied with accessories for both flush mounting and surface mounting, using the dedicated mounting boxes provided. With the installation of an additional button (R131), the modular keyboard can also be used for two-family systems.



1200 AND 1200 REINFORCED SERIES. HIGH PERFORMANCE, VERSATILITY AND DESIGN.



With a modern, technological design the 1200 series comes with elegant finishes and high-performing yet user friendly technology. The 1200 series can be wall-mounted or flush-mounted with the related accessories. A reinforced version is also available, in sable grey satin-finished paint, which is particularly resistant to atmospheric agents and with degree of protection against impacts to IK10 it is ideal for installation in saline environments.



One material, two colours and two finishes.
To satisfy every style.

The cover plates are made in 8/10 thick AISI 316 stainless steel and come in two different finishes: stainless steel colour with embossed surfaces or sable grey colour with satin-finished paint.



steel with embossed surface



sable grey



PATAVIUM SERIES. A CLASSIC, SOPHISTICATED STYLE.



Made of OT59 brass for watch-making with PVD treatment, the Patavium panels, available in both audio/video and audio-only versions, fulfil the widest range of installation requirements in elegant spaces. With their sophisticated lines and timeless design, they adapt to suit all types of architecture, particularly historical buildings, guaranteeing an excellent look and high performance.



Patavium panels with special finish.

Alongside the standard version, cover plates with special finish are available to offer additional customisation of video entryphone outdoor units thanks to the modularity available, four colour variants (satin-finish brass, polished brass, raw brass and steel grey), six different installation methods and the possibility of reproducing logos, symbols and trade marks with impeccable precision.

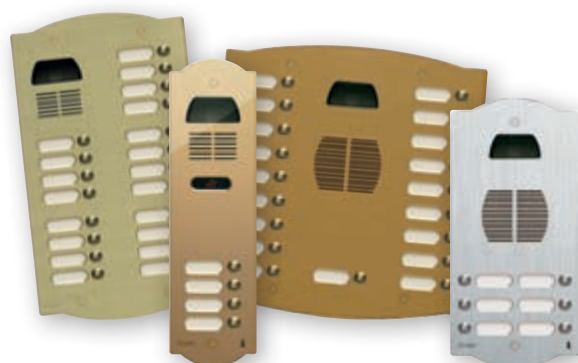

Name or number, it's up to you.

Patavium is available in two versions: keyboard with push buttons or alphanumeric keyboard. Both have high-efficiency LED backlighting to increase readability in poor lighting conditions.

Expand it as you please.

Patavium can be expanded by combining it with additional entrance panels. These are available with both 8 conventional push buttons or only lit name card holders when combined with an entrance panel already equipped with a keyboard, display and electronic contacts list.



Customisation.

Logos, symbols and trade marks can be reproduced on cover plates, accurately and indelibly, using a fine black milling technique guaranteed millimetric precision.

TAB SERIES: THE APPEAL OF THICKNESS, FOR SLIM GENERATION.



The video door entryphones Tab 7S, Tab 7, Tab Free, Tab 4,3, and the Tab jr. entryphone share the same philosophy: an ultra-slim shape, capacitive keyboard and an innovative design in two different colours. Modern and elegant, Tab is easy to combine and simple to install. Its flexible and dynamic essential style allows it to satisfy every user's needs.



TAB 7S and TAB 7

With integrated Wi-Fi.

Thanks to the Wi-Fi integrated into the Tab 7S video entryphone, the app can be used to receive calls originating from the outdoor unit, make intercom calls, release the lock or activate auxiliary services (switch on the stair lights or start the irrigation system, etc.).

7" and ultra-high resolution.

The LCD colour screen offers a magnificently large and well defined image: 7" with 800x480 pixel resolution.

Linear and sober styling.

Striking the perfect balance between simplicity and attention to detail, the Tab 7 comes across as an innovative device, with clean and unfussy lines. A modern blend of rigour and elegant restraint.

Black and White, glass effect.

Two timeless colour schemes, selected to blend in with any interior décor, are used for the special "glass effect". The effect is sparkling, like glass, and creates artful suggestions of transparency.

Capacitive keypad and touch controls.

Tab models are equipped with flush capacitive buttons, in keeping with the minimal design of the entire device. The Tab 7S model also offers touch screen functionality: fast and sensitive, this allows the user to activate controls simply by tapping the display.

Catering for the needs of everyone.

The Tab 7 is equipped with a teleloop so that hearing aid wearers can also use the system, and has tactile aids designed to facilitate operation of the controls by persons with impaired vision.

No-nonsense speaker.

Its generous proportions stand out below the video entryphone. Aiming at an audio output as clear and free of disturbance as possible, voice reproduction is always faultless, and of high quality.

Tab 7S video entryphone



VIEW
IoT smart life

Tab 7 video entryphone



2 DUEFIL PLUS

Functions:

2 DUEFIL PLUS

✓	Visual call indicators. Activation of functions accompanied by visual and audible feedback.	✓
✓	Hands-free. Communication made easy and convenient, with no physical constraints.	✓
✓	Accessibility. For the visually impaired and hearing aid users.	✓
✓	Alert. Users can send priority requests for service to porter desks.	✓
✓	CCTV video camera viewing. A constant watch on the home.	✓
✓	Video door entry system answering machine. Messages taken in the absence of a reply.	
✓	Capacitive touch screen display. Drag & Drop functions.	
	Graphic menu with capacitive keyboard. For the main video entryphone functions: answering and opening the door.	✓
✓	Integrated Wi-Fi. Calls can be transferred to smartphone and tablet.	

TAB Series: video entryphones with handset and speakerphone, for top communication.



TAB 4,3

Styling.

Available in black or white: two timeless colours, processed to obtain a special glass-effect for a look that blends in with every design interior.

Profile.

With a thin profile just 2.6 cm thick, for surface mounting, and up to 2 cm for the Tab video entryphone, thanks to a special mounting frame for semi-flush mounting.



TAB FREE

Hands-free.

TAB Free means communicating in full freedom and comfort, with no constraints. No cables, no handset.

Colour display.

Visual performance encased in a 7", 4.3" or 3.5" display showing outside images with perfect definition and colour.

Capacitive keypad and side controls.

With buttons and controls flush with the surface. No thickness, in line with the minimal design of the whole appliance. 8 functions, 4 basic and 4 programmable for intercom calls and auxiliary services. And for Tab Free, the user-friendly volume control on the side.

Ringtones.

10 different set tunes: simply choose your favourite and set the volume to suit your needs and application contexts.



TAB jr.

Small in both name and deed: Tab jr. is designed for those who don't need the video function. An audio-only device which maintains all the technology, quality, design and basic functions of its "big brother".

EXTREME COORDINATION BETWEEN STYLING AND FUNCTIONALITY.



5700

5700 Series.

With its simple, clean lines, fully representing the best in modern design trends, the new 5700 video entryphone blends perfectly into any residential setting, with its ultra-thin profile and two available colours, black and white. Simple controls, user-friendly symbols, functions that are easy to programme and can be integrated with the By-me home automation system, a 3.5" high definition colour display: these are the characteristics that make it unique.

Touch buttons.

The touch keyboard with clear controls and intuitive symbols, controls 4 standard and another four variable functions.

Installation versatility.

For flush mounting, it is supplied with a mounting frame and cover plate.

6600 Series.

The video entryphones in the 6600 series also stand out for their special 3.5" TFT LCD monitors, with vertical tilt function, which help the user clearly view in detail who is at the door. They combine technology and design, and are flexible solutions that can be used in various contexts. Versions for flush mounting, surface mounting and table mounting available, providing a comfortable way to welcome visitors.

Hands-free for total comfort.

No wires, no handset, for totally free communication.

Maximum installation simplicity and versatility.

Depending on the model, it is available with up to 8 buttons for basic functions and 6 additional buttons for auxiliary functions. For flush, wall or desktop mounting.



6600



Wall mount



Desktop

VIDEO DOOR ENTRY SYSTEMS AND DOOR ENTRY SYSTEMS FOR NO-FUSS SOLUTIONS.



Video door entry and door entry units with essential, clean lines, that will blend in with any living style. Simple to use and reliability guaranteed.



PETRARCA
audio door
entry unit



PETRARCA
Monitor +
door entry unit

Design.

With the typical appearance of the door entry phone, it has a simple and essential line but excellent functionality. For those looking for the essential in both shape and function.

Installation versatility.

The Petrarca entryphone functions can be expanded with accessories: colour monitor, call volume control and additional push buttons. Wall-mounted or desktop installation requires the relative fixing brackets or desktop installation kit.



GIOTTO

Substantial.

The Giotto series comes with all basic video door entry system functions: colour monitor, speaker for electronic calls and three push buttons for opening the doors, self start and auxiliary functions. It can be wall or desktop mounted using the conversion kit.



6900

Hands-free loudspeaker.

Very practical use with the hands-free function of the loudspeaker system: you don't need to hold the reply button down during the conversation.

Quick settings.

With just 4 keys dedicated to the main door entry functions and 6 for setting the ringtone volume, ringtone choice, intercom calls, and other auxiliary signals.



8870

Functions.

The 8870 series comes in the standard configuration with two push buttons (one to open the lock and the other for auxiliary services).

VIEW: VIMAR ENERGY on the WEB.

Video entryphones now go on-line. Smart products and interconnected systems.

What is VIEW? VIEW is a range of stylistically matching smart products and interconnected systems that are also compatible with other manufacturers' products, all conceived with the aim of increasing simplicity for users and offering them an intuitive experience, working towards total control of their homes and a smart lifestyle.

In line with this premise, VIEW is Vimar's vision of the digital world and of the Internet of Things, which forms the guiding principle for the ongoing development of smart solutions, all connected to each other, to the Internet and to the user by means of state-of-the-art digital technologies. VIEW looks to the future, today.



Full control via APP.

All you need is your smartphone to manage and supervise your home and the objects in it, easily and instantly.

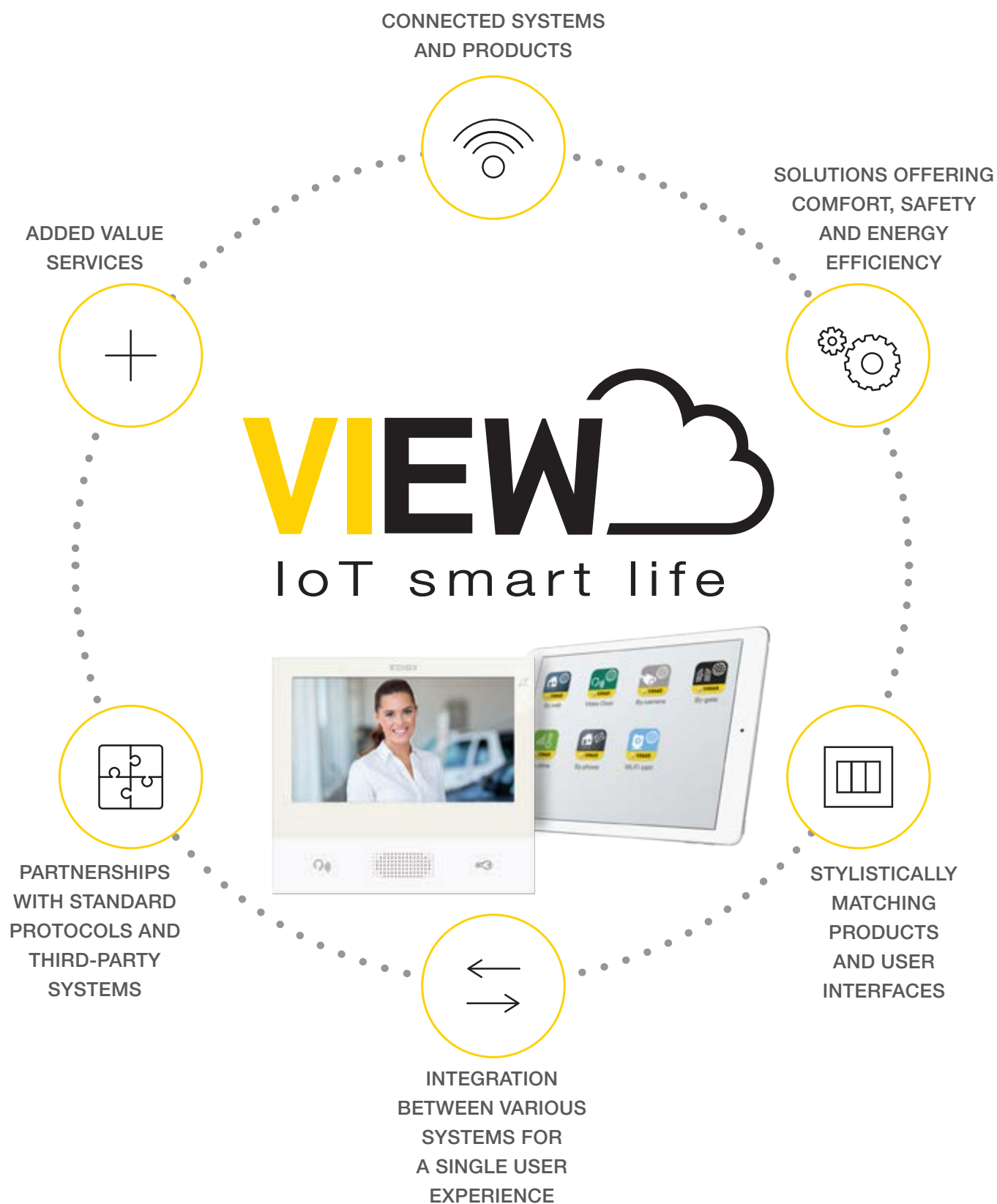

A host of benefits that reflect the needs of a modern lifestyle.



CONNECTED SYSTEMS AND PRODUCTS

Vimar has created a whole range of systems that share a contemporary styling approach and wireless products utilizing technologies that are intuitive, reliable and precise.

CONNECTED SYSTEMS

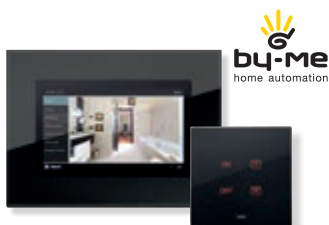

By-me home automation



Well-contact Plus building automation



Call-way hospital system



By-alarm burglar alarm system



Elvox Video Entryphones



Elvox CCTV



ELVOX Automations

CONNECTED PRODUCTS



ClimaCrono Wi-Fi touch timer-thermostat



ClimaPhone GSM timer-thermostat



Stand alone speaker system



Radio frequency controls



Wi-Fi video cameras

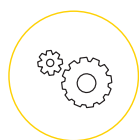

SOLUTIONS OFFERING COMFORT, SAFETY AND ENERGY EFFICIENCY

Effective, complete and suitable for all types of buildings, the solutions supported by View have been designed to provide maximum comfort and security. And all while ensuring the highest level of energy efficiency.



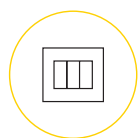

STYLISTICALLY MATCHING PRODUCTS AND USER INTERFACES

As with all Vimar products, View solutions are aesthetically coordinated right down to the last detail, in line with our philosophy that technology and style should always go hand-in-hand.

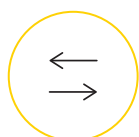

INTEGRATION BETWEEN VARIOUS SYSTEMS FOR A SINGLE USER EXPERIENCE

Smart products and interconnected systems also integrate seamlessly with products by other manufacturers, thus making life easier by providing a single user experience.



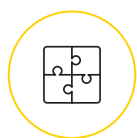

PARTNERSHIPS WITH STANDARD PROTOCOLS AND THIRD-PARTY SYSTEMS

In order to offer a comprehensive, fully integrated service, maximum synergy and partnership between Vimar protocols and those of leading brands in other production segments are guaranteed by specific international standards.

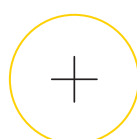

ADDED VALUE SERVICES

Vimar supports sector professionals through training courses, dedicated technical assistance, a toll-free phone number and personalised consultancy services. These activities are aimed at increasing the levels of expertise, safety and quality in their work.



General contents

SYSTEM SOLUTION GUIDE AND TYPICAL SYSTEMS

from page 30

DUE FILI PLUS TECHNOLOGY

- Video door entry and Door entry system kits from page 54
- Video door entry system and door entry system
entrance panels from page 56
- Video entryphones and entryphones from page 78
- System components from page 82



Quick guide to the right system solution

The first choice to make when renewing an existing system or creating a new one is to define the type of system, to identify the various components required.

Audio-only system (Due Fili Plus).

Basic system components:

- Entrance panel (external unit + mechanical media).
- Power supply and indoor unit (audio).
- The connection of all the devices in an “audio-only” system can be done from any point in the system, tapping off the Due Fili Elvox bus and connecting entrance panels, indoor units and the other components in the system.

With single entrance panel.

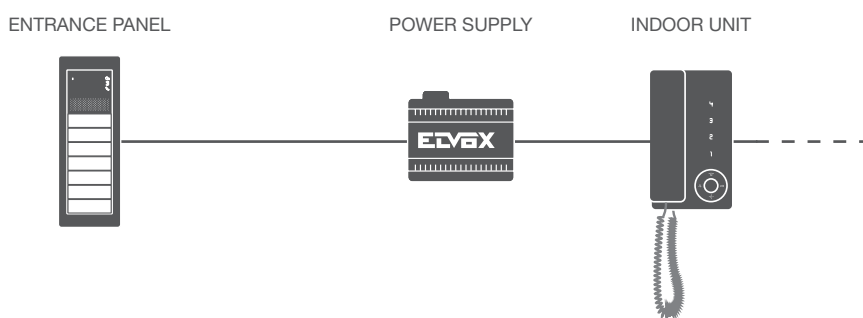

With multiple entrance panels.

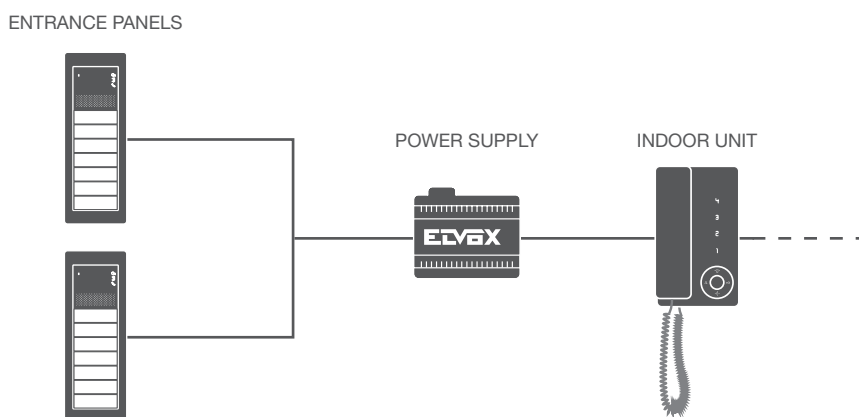

Quick guide to the right system solution

Mixed systems (Due Fili Plus).

Basic system components:

- Entrance panels (external units + mechanical media)
- Concentrator (combines multiple inputs)
- Power supply and indoor units (audio + video).

In mixed systems (audio+video), for solutions with multiple audio and video external units, the concentrator is required.

In the case of indoor units, on the other hand, installations may use:

- Linear wiring (enter-exit, no additional device needed).
- Wiring with floor distributor, allowing 4 outputs to be taken off the riser.

With single entrance panel.

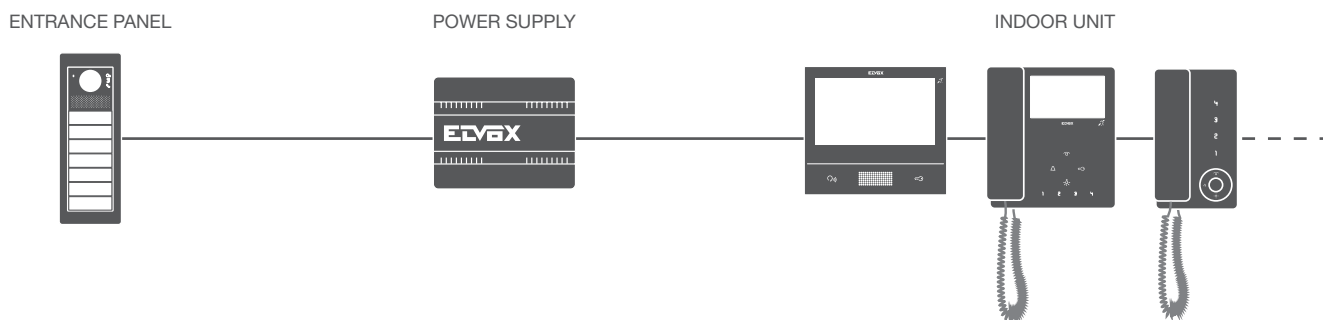

Quick guide to the right system solution

Mixed systems (Due Fili Plus).

With more than one entrance panel and enter-exit wiring.

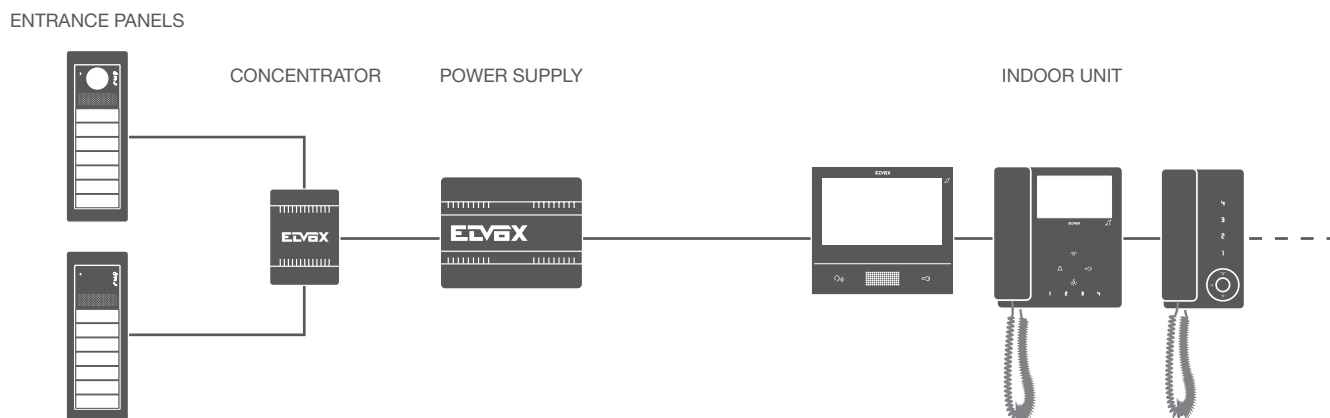

With more than one entrance panel and floor distributor.

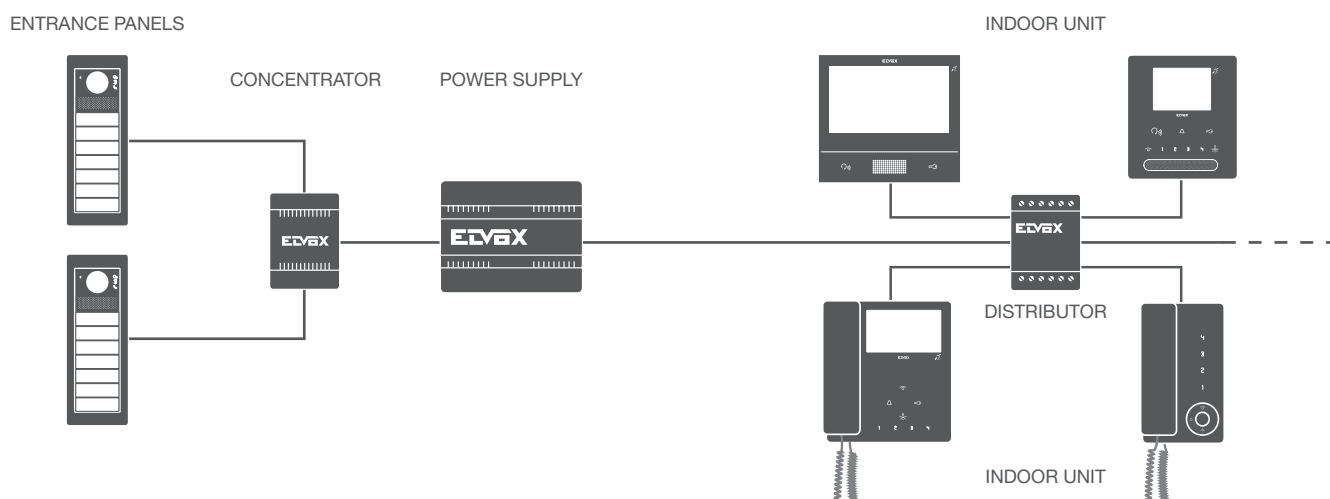

Quick guide to the right system solution

Mixed systems (Due Fili Plus).

- mixed wiring, where each of the outputs from the floor distributor can be used to connect a single indoor unit, or to connect multiple units (wired enter-exit) in the same apartment.

With more than one entrance panel and floor distributor.

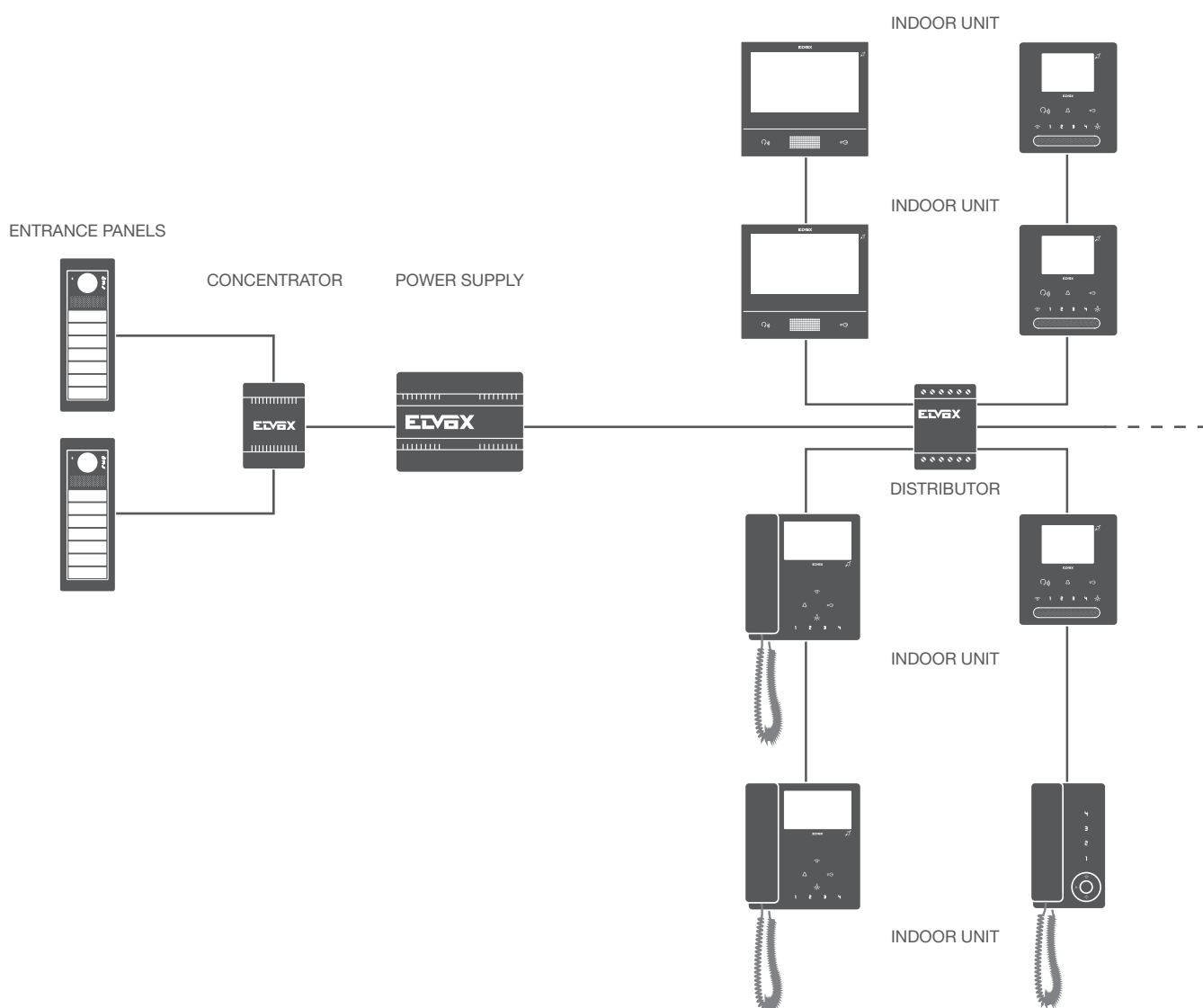

Due Fili Plus - Examples of standard systems

When creating new systems or updating existing systems, the system type must be defined in order to identify the various components required. The components for each type of system can be fitted within certain distances, as follows:

- system components:

- maximum distance between the indoor unit and the furthest entrance panel;
- maximum distance between the entrance panel and the power supply;

- type and length of the cable.

The diagrams below show various system types, each indicating the relevant thresholds to be observed.

Type of cable

CABLE	ARTICLE	UNDERGROUND	AUDIO SYSTEMS	MIXED SYSTEMS
Elvox - section 1 mm ²	732I.E.100, 732I.E.500	Yes	Recommended	Recommended
Elvox - section 1 mm ²	732H.E.100, 732H.E.500	No	Recommended	Recommended
Cat.5/6		No	Yes	Yes
Twisted phone 0.28 mm ²		No	Yes	Yes
Single > 0.2 mm ² *		No	Yes	Yes

* also refers to cables for alarm systems

Due Fili Plus - Examples of standard systems

Basic video door entry system.

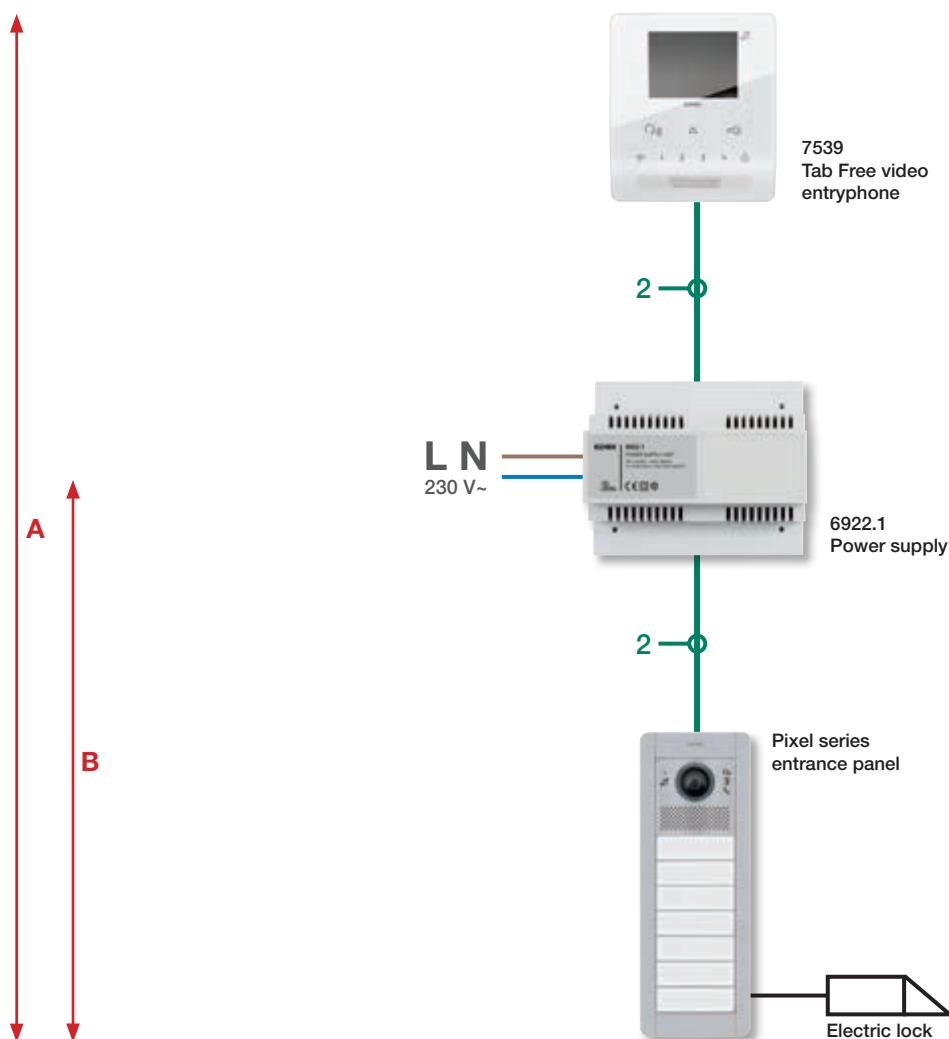

Type of cable	Max distance A	Max distance B	Max cable run
732L.E... or 732H.E...	700 m	250 m	2000 m
Cat.5 or Cat.6	570 m	200 m	2000 m
Twisted phone	120 m	40 m	2000 m
Single > 0.2 mm ²	50 m		100 m

Legend

- A** - Maximum distance between the indoor unit and the furthest entrance panels
B - Maximum distance between the entrance panel and the power supply

Type of cable	Video amplifiers	Max distance A	Max distance B	Max cable run
732L.E... or 732H.E...	2	1200 m	250 m	2000 m
Cat.5 or Cat.6	2	970 m	200 m	2000 m
Twisted phone	0	120 m	40 m	2000 m
Single > 0.2 mm ²	0	50 m		100 m

Table of configuration of a video door entry system with amplifiers

Due Fili Plus - Examples of standard systems

Villa with video door entry system.



Due Fili Plus - Examples of standard systems

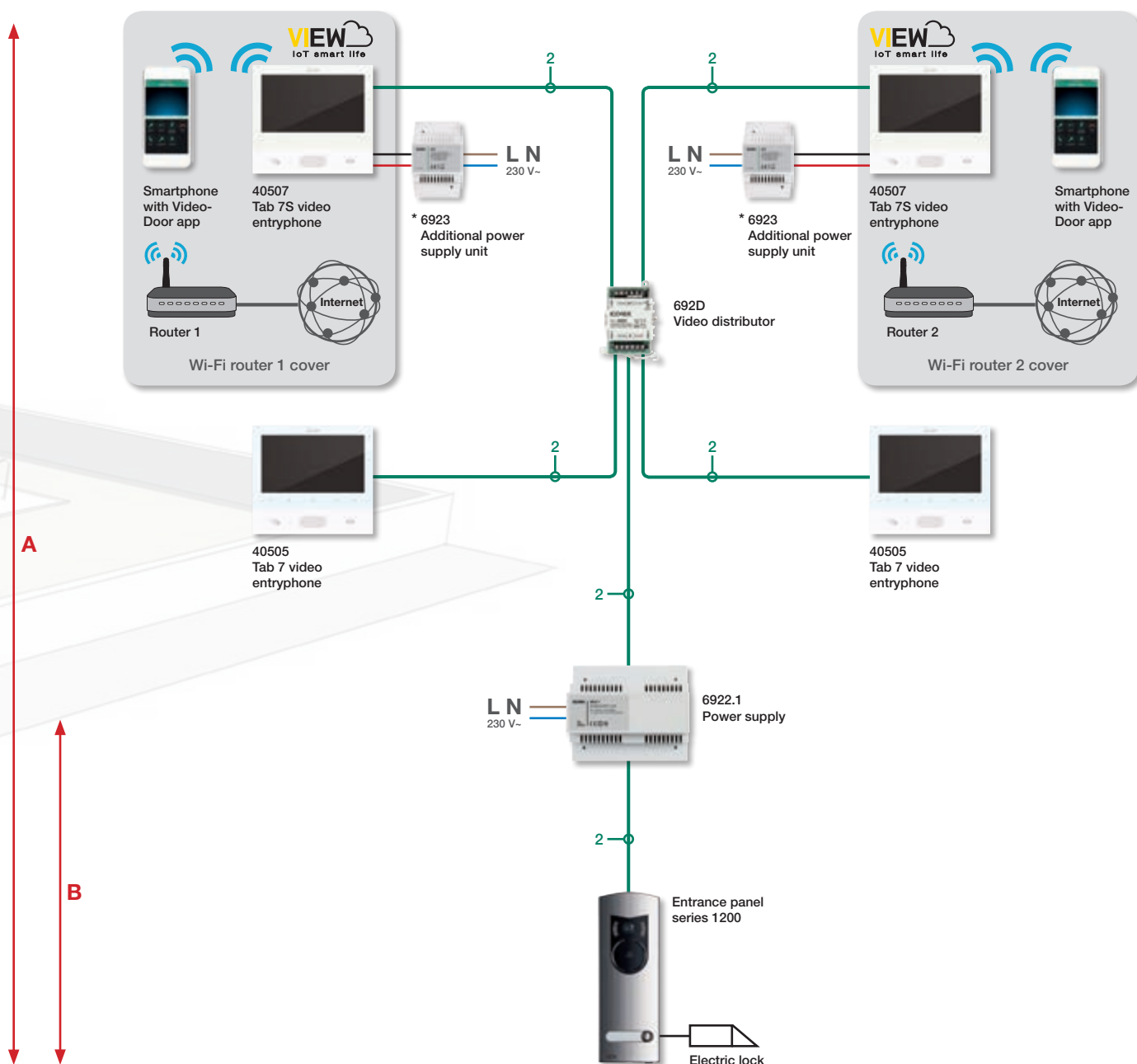

Type of cable	Max distance A	Max distance B	Max cable run
732L.E... or 732H.E...	320 m	250 m	2000 m
Cat.5 or Cat.6	250 m	200 m	2000 m
Twisted phone	100 m	40 m	2000 m
Single > 0,2 mm ²	50 m		100 m

Table relating to the diagram in configuration with 1 entrance panel, 4 individually activated indoor units, power supply and video distributor

Legend

- A - Maximum distance between the indoor unit and the furthest entrance panels
- B - Maximum distance between the entrance panel and the power supply

* Additional power supply 6923 for use always with each Tab 7S video entryphone.

Due Fili Plus - Examples of standard systems

Villa with video door entry system and extended cable runs

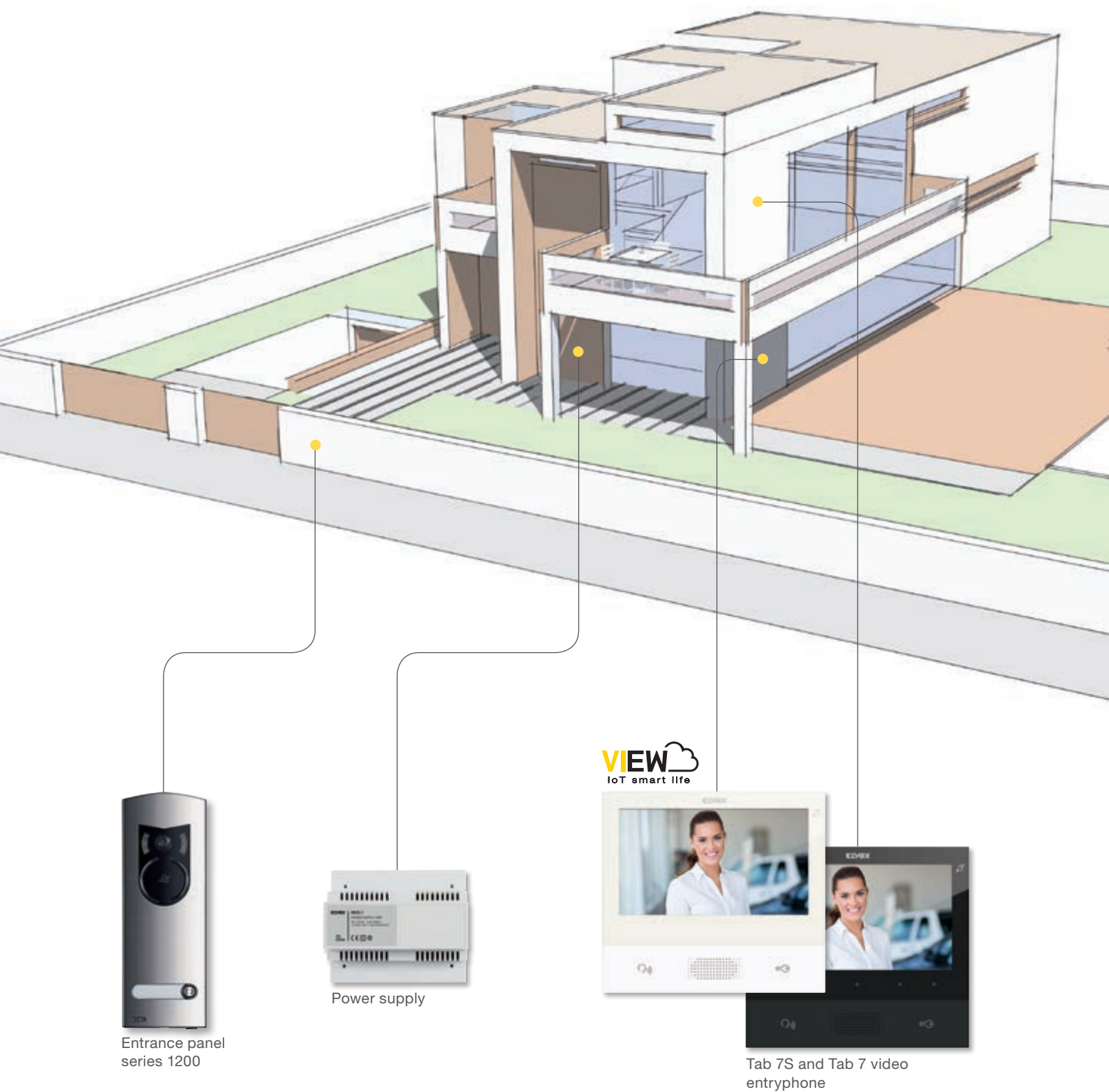

Due Fili Plus - Examples of standard systems

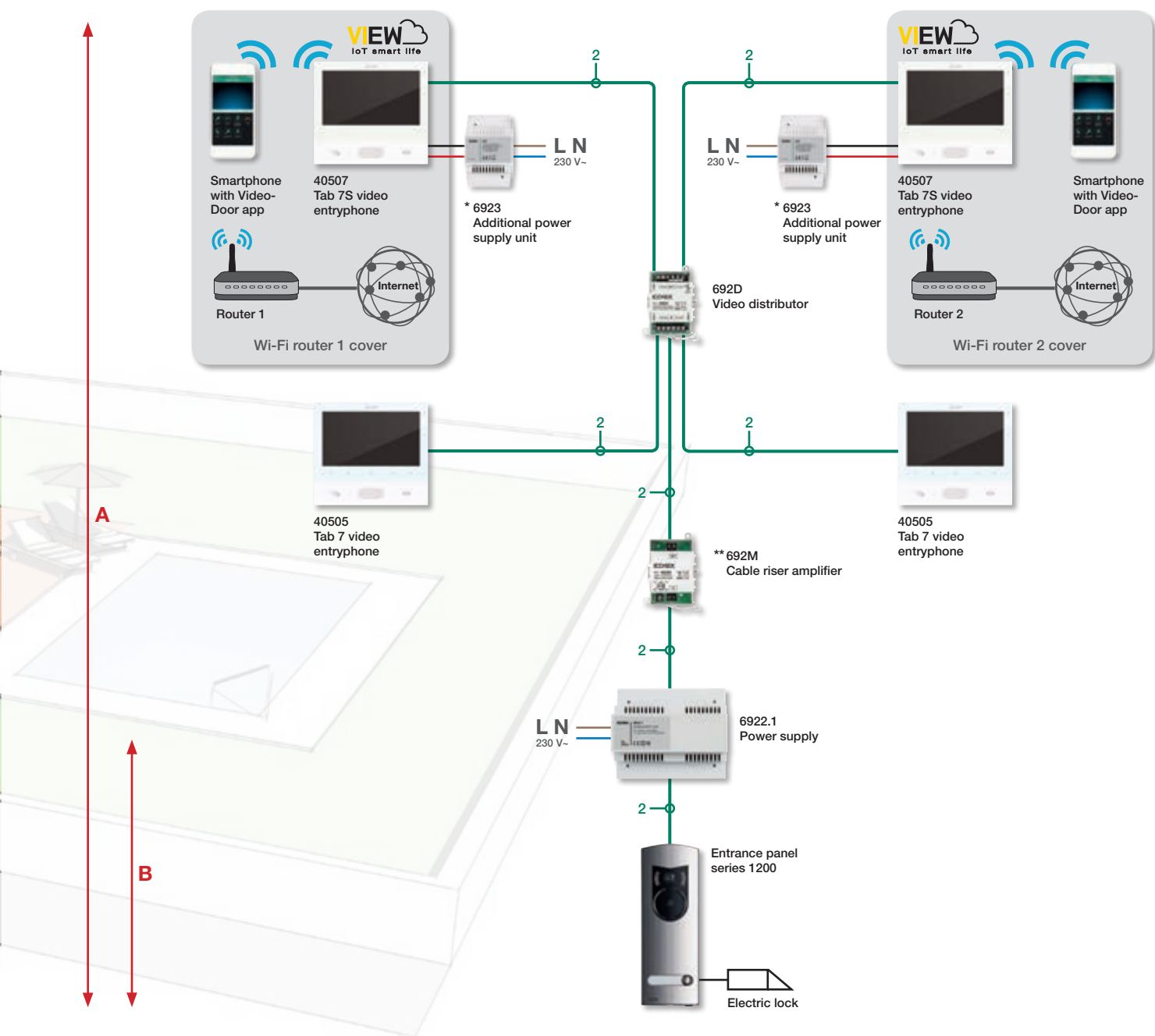

Type of cable	Video amplifiers	Max distance A	Max distance B	Max cable run
732L.E... or 732H.E...	1	600 m	250 m	2000 m
732L.E... or 732H.E...	2	900 m	250 m	2000 m
Cat.5 or Cat.6	1	510 m	210 m	2000 m
Cat.5 or Cat.6	2	770 m	210 m	2000 m
Twisted phone	0	100 m	40 m	2000 m
Single > 0,2 mm ²	0	50 m		100 m

Table relating to the diagram in configuration with 1 entrance panel, 4 individually activated indoor units, power supply and video distributor.

Legend

- A** - Maximum distance between the indoor unit and the furthest entrance panels
- B** - Maximum distance between the entrance panel and the power supply

* Additional power supply 6923 for use always with each Tab 7S video entryphone.

** Position the 692M amplifier at least 200 m from the entrance panel or previous 692M.

Due Fili Plus - Examples of standard systems

Semi-detached villa with video door entry system.

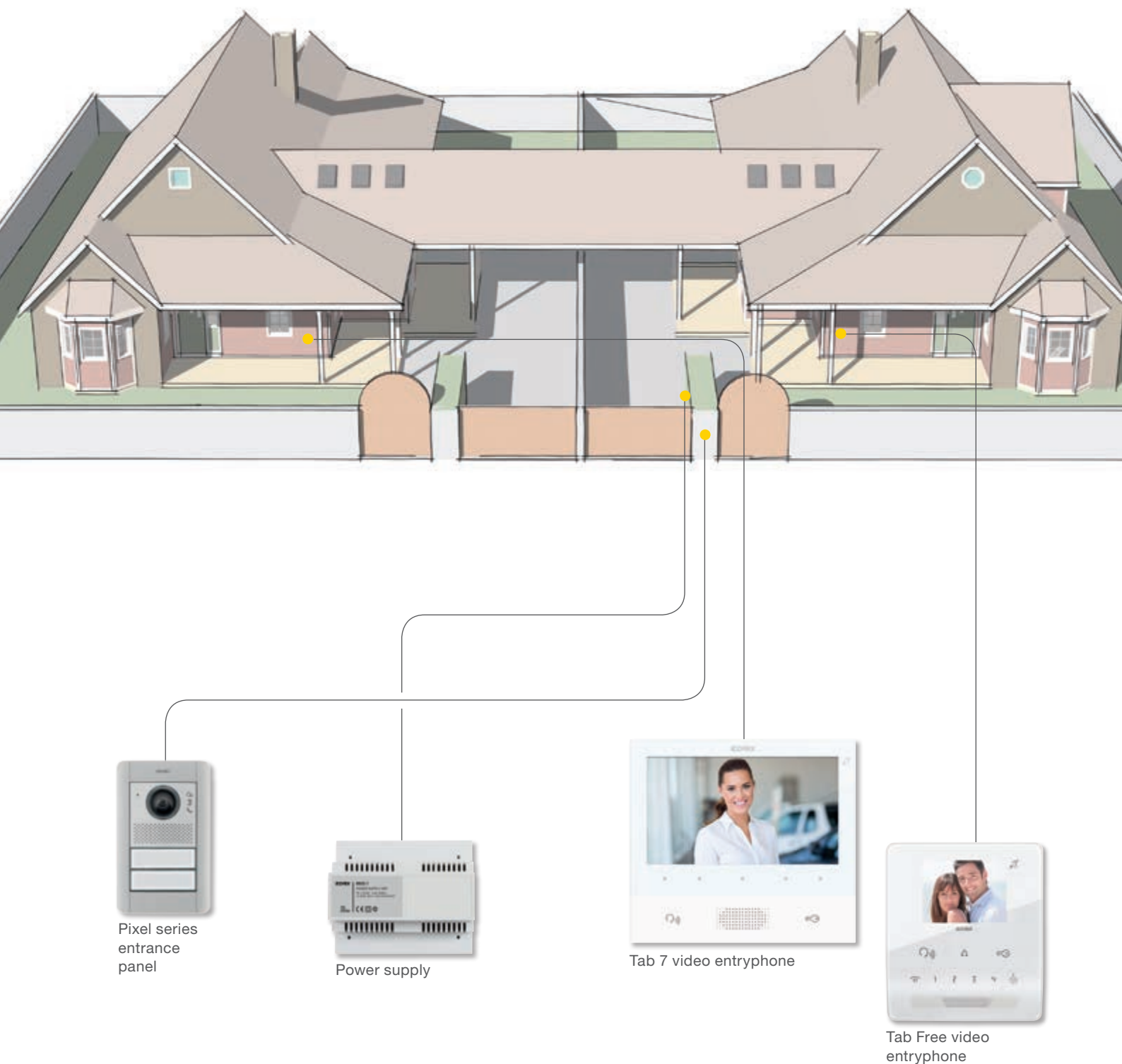

Due Fili Plus - Examples of standard systems

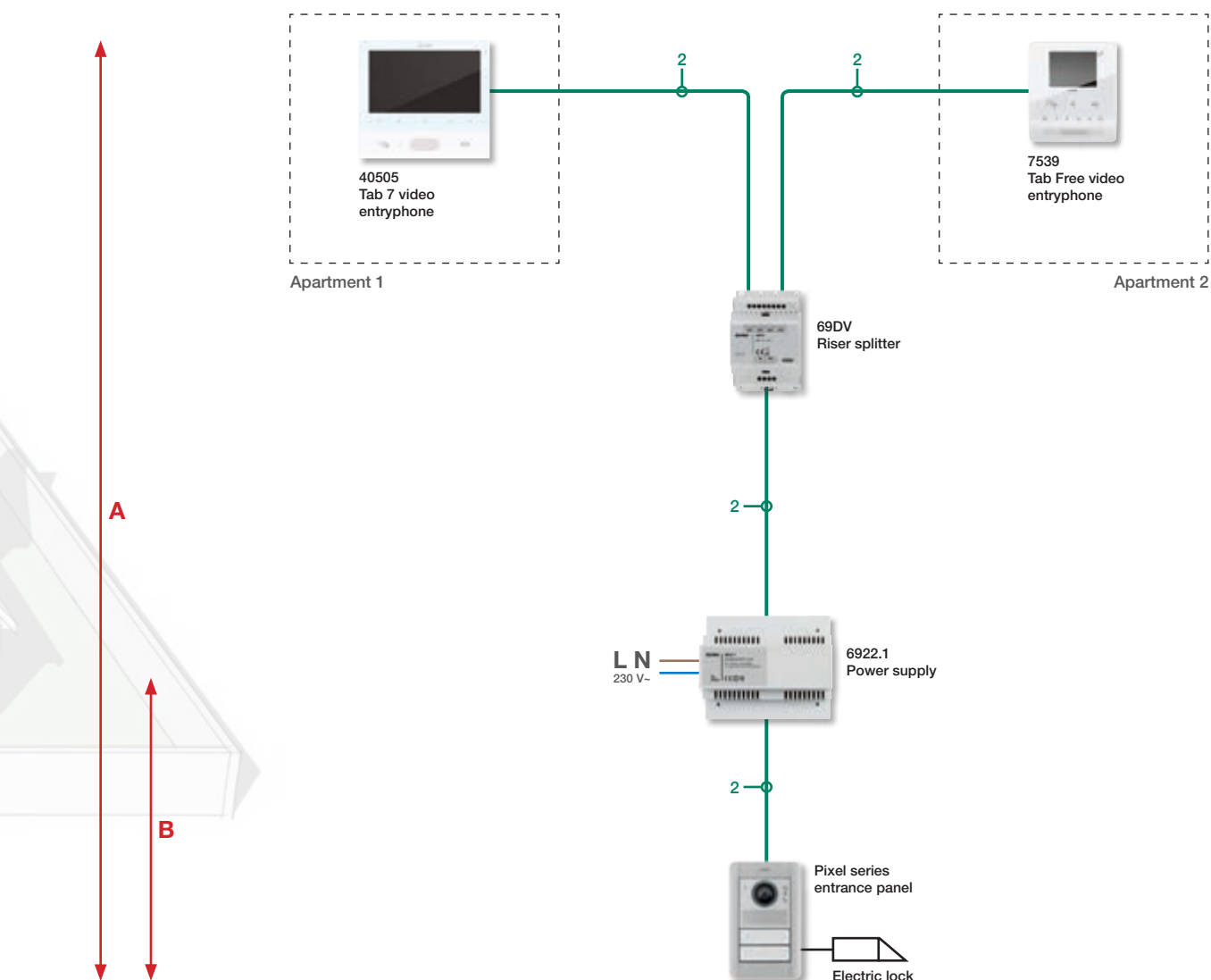

Type of cable	Max distance A	Max distance B	Max cable run
732L.E... or 732H.E...	600 m	250 m	2000 m
Cat.5 or Cat.6	500 m	200 m	2000 m
Twisted phone	100 m	40 m	2000 m
Single > 0,2 mm ²	50 m		100 m

Table relating to configuration with 1 entrance panel, 1 indoor unit per call, power supply and riser splitter

Legend

- A** - Maximum distance between the indoor unit and the furthest entrance panels
- B** - Maximum distance between the entrance panel and the power supply

Due Fili Plus - Examples of standard systems

Semi-detached villa with video door entry system and extended cable runs.

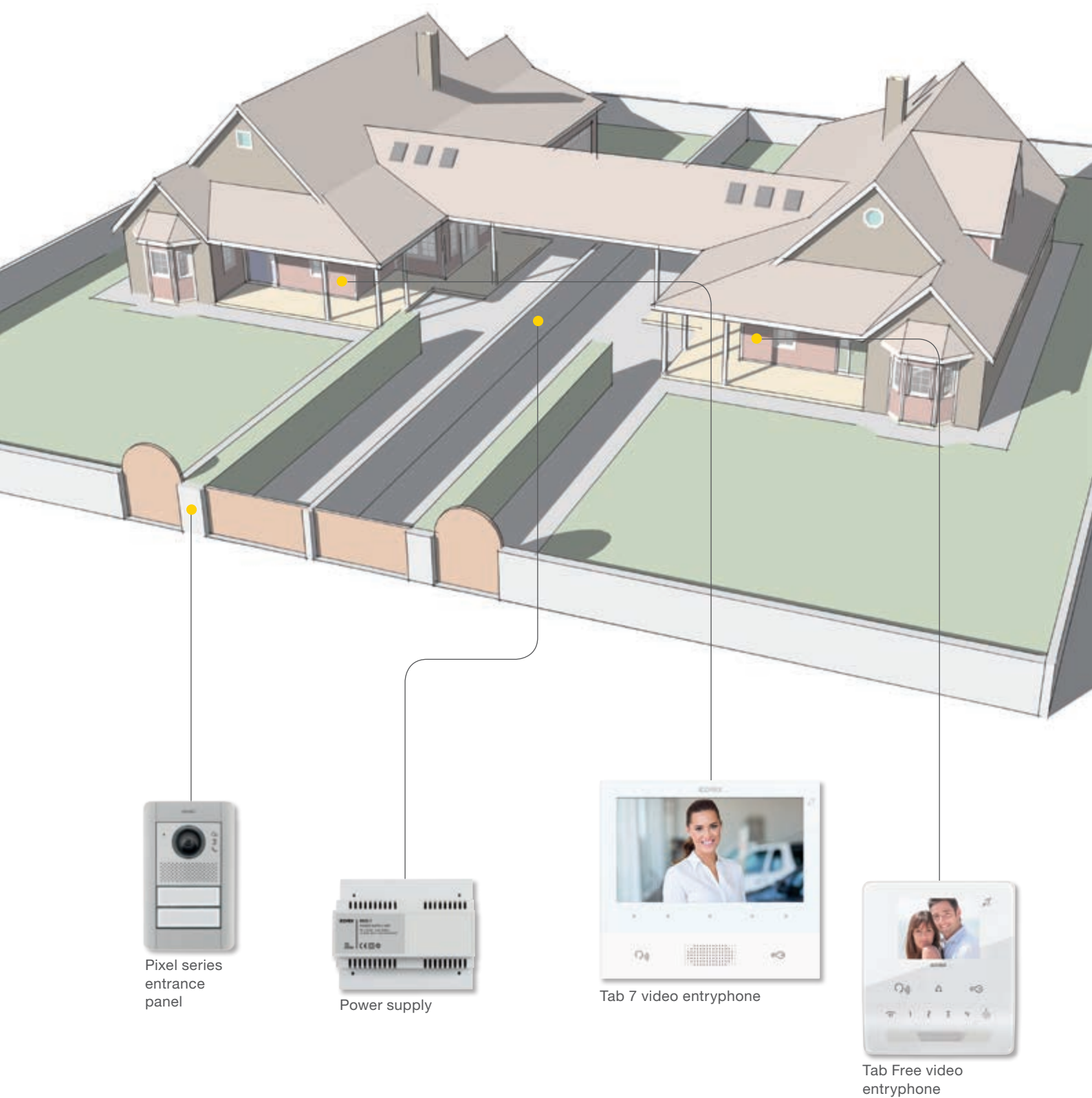

Due Fili Plus - Examples of standard systems

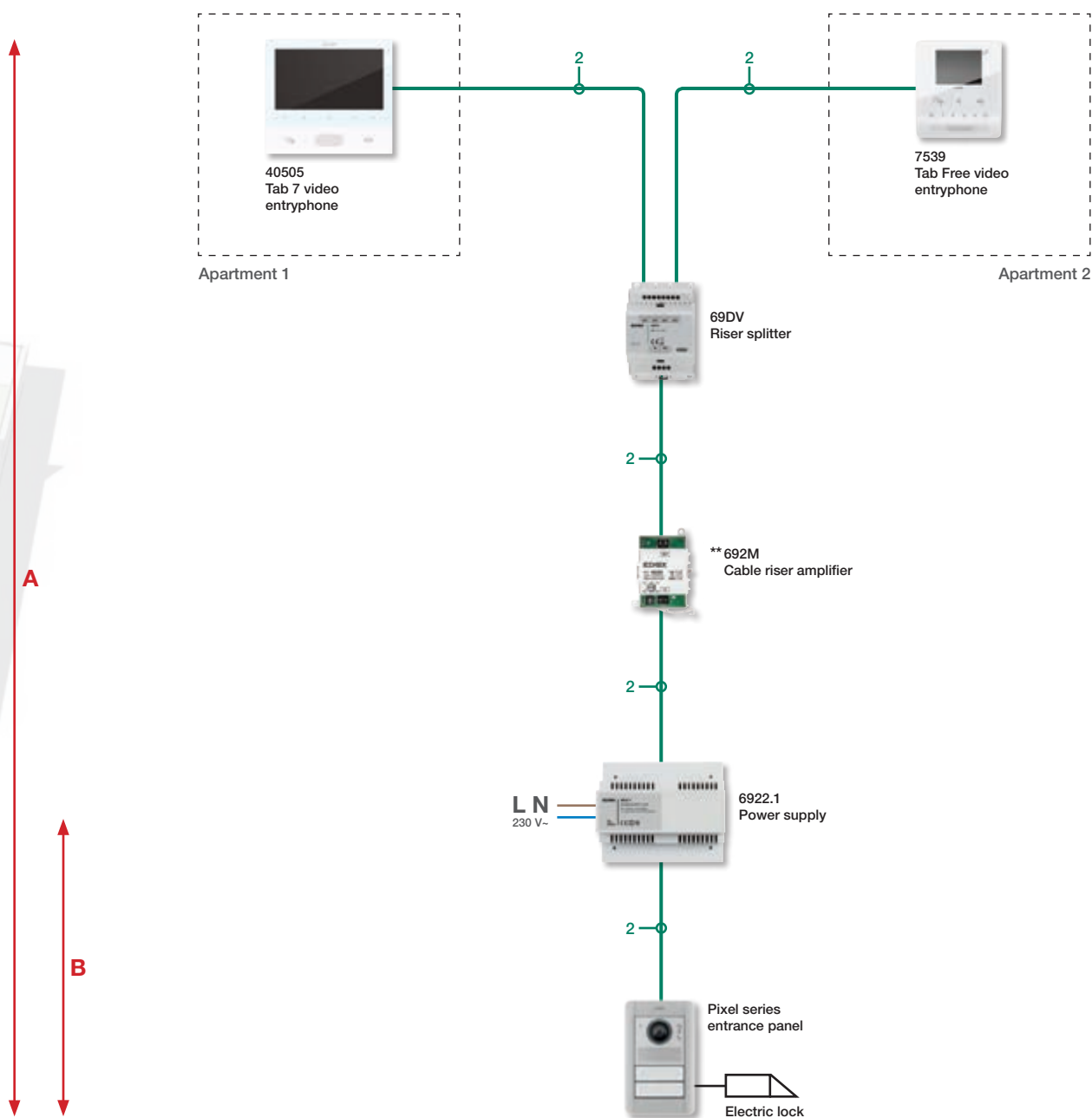

Type of cable	Video amplifiers	Max distance A	Max distance B	Max cable run
732L.E... or 732H.E...	1	970 m	250 m	2000 m
732L.E... or 732H.E...	2	1200 m	250 m	2000 m
Cat.5 or Cat.6	1	800 m	200 m	2000 m
Cat.5 or Cat.6	2	1000 m	200 m	2000 m
Twisted phone	0	120 m	40 m	2000 m
Single > 0,2 mm ²	0	50 m		100 m

Table relating to configuration with 1 entrance panel, 1 indoor unit per call, power supply and riser splitter

Legend

- A** - Maximum distance between the indoor unit and the furthest entrance panels
- B** - Maximum distance between the entrance panel and the power supply

****Position the 692M amplifier at least 200 m from the entrance panel or previous 692M.**

Due Fili Plus - Examples of standard systems

Apartment block with video door entry system serving up to 8 indoor units



Due Fili Plus - Examples of standard systems

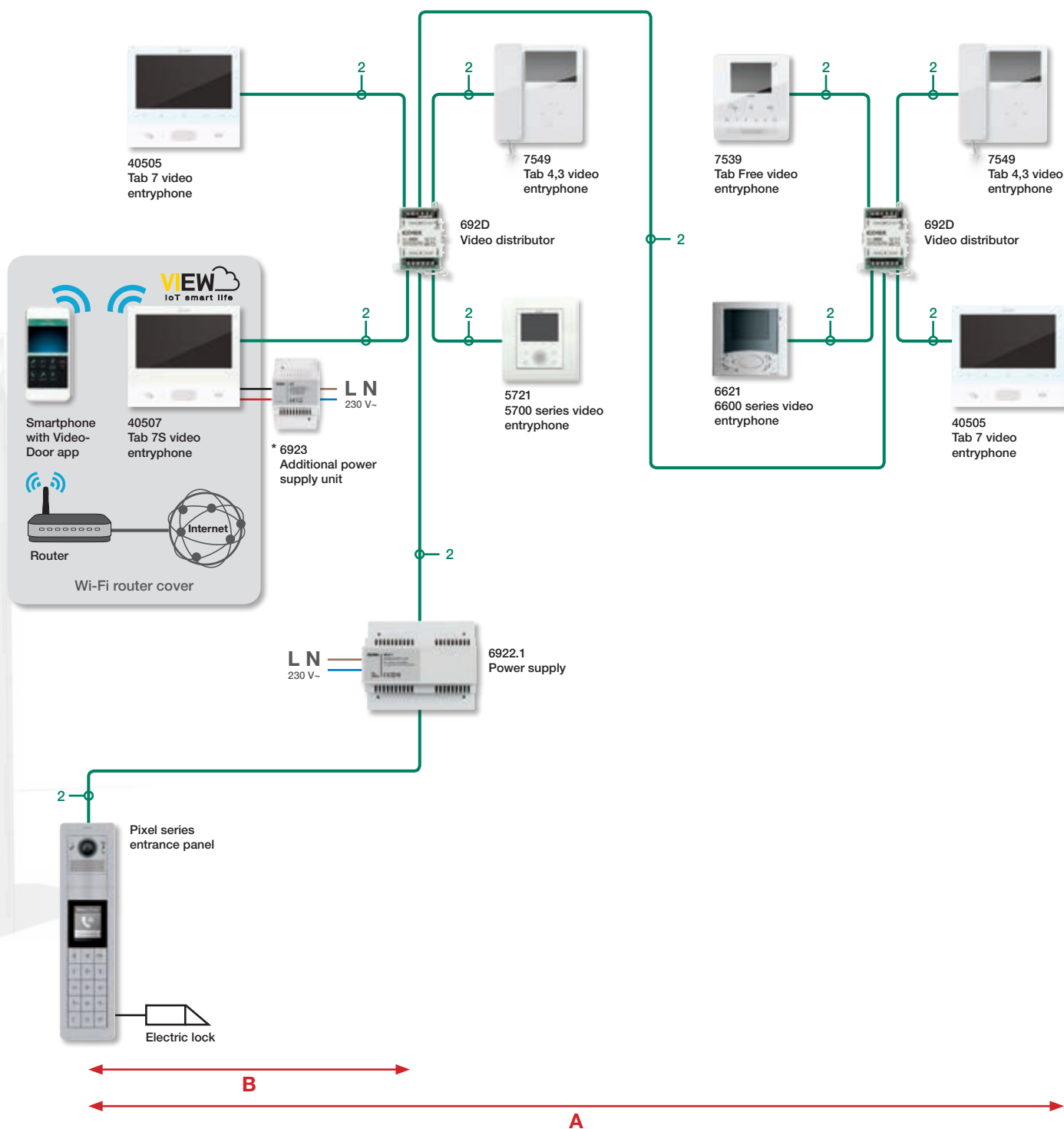

Type of cable	Max distance A	Max distance B	Max cable run
732L.E... or 732H.E...	320 m	250 m	2000 m
Cat.5 or Cat.6	260 m	200 m	2000 m
Twisted phone	100 m	40 m	2000 m
Single > 0,2 mm ²	50 m		100 m

Table relating to configuration with 1 entrance panel, 8 individually activated indoor units, power supply and video distributor

Legend

- A** - Maximum distance between the indoor unit and the furthest entrance panels
- B** - Maximum distance between the entrance panel and the power supply

* Additional power supply 6923 for use always with each Tab 7S video entryphone.

Due Fili Plus - Examples of standard systems

Apartment block with video door entry system and extended cable runs.



Due Fili Plus - Examples of standard systems

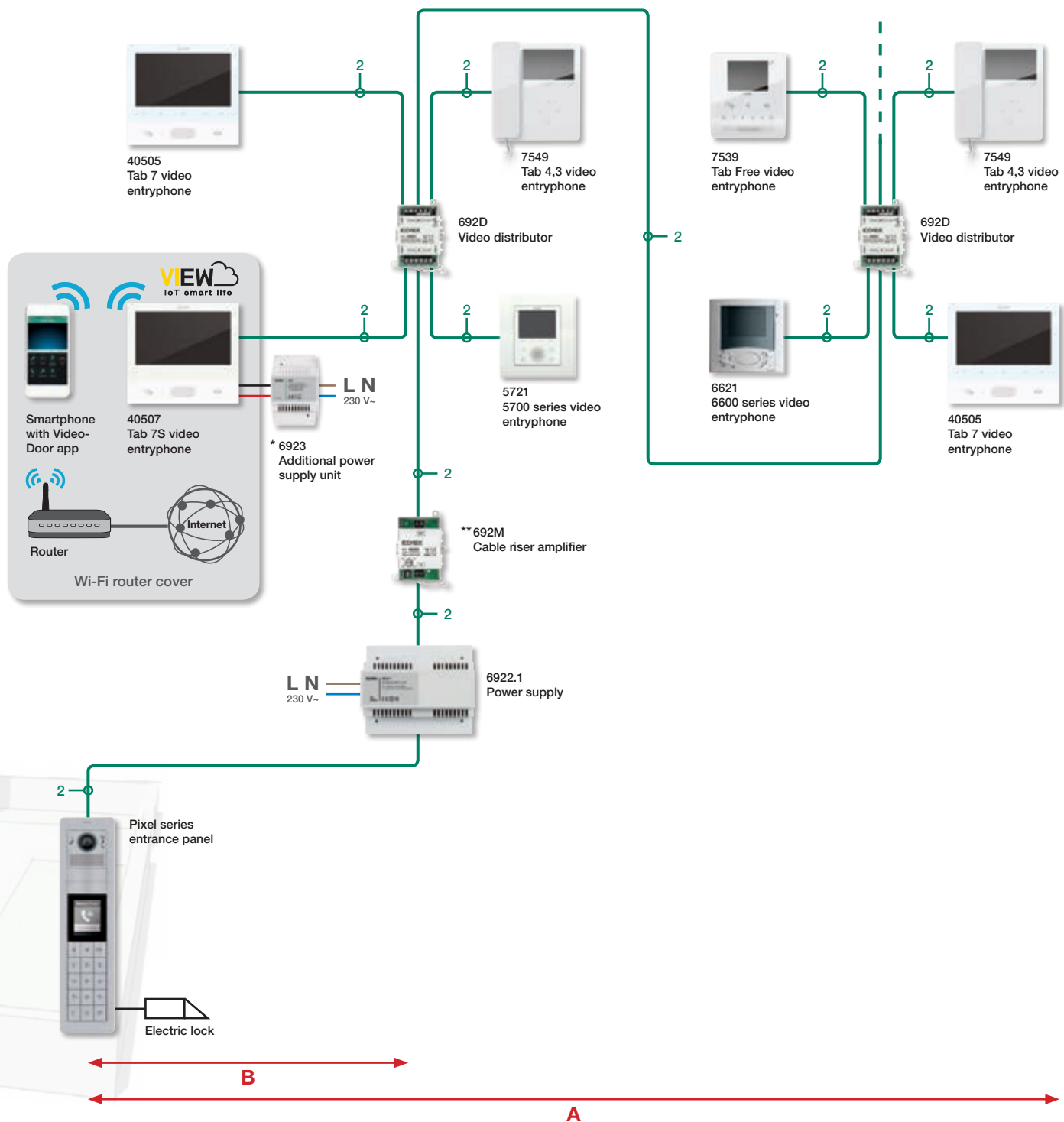

Type of cable	Video amplifiers	Max distance A	Max distance B	Max cable run
732L.E... or 732H.E...	1	550 m	250 m	2000 m
732L.E... or 732H.E...	2	800 m	250 m	2000 m
Cat.5 or Cat.6	1	450 m	200 m	2000 m
Cat.5 or Cat.6	2	650 m	200 m	2000 m
Twisted phone	0	100 m	40 m	2000 m
Single > 0,2 mm ²	0	50 m		100 m

Table relating to configuration with 1 entrance panel, 8 individually activated indoor units, power supply and video distributor.

Note: in a system with extended cable runs use only the cables indicated in the table.

Legend

- A** - Maximum distance between the indoor unit and the furthest entrance panels
- B** - Maximum distance between the entrance panel and the power supply

* Additional power supply 6923 for use always with each Tab 7S video entryphone.

** Position the 692M amplifier at least 200 m from the entrance panel or previous 692M.

Due Fili Plus - Examples of standard systems

Residential complex with video door entry system serving up to 200 indoor units.

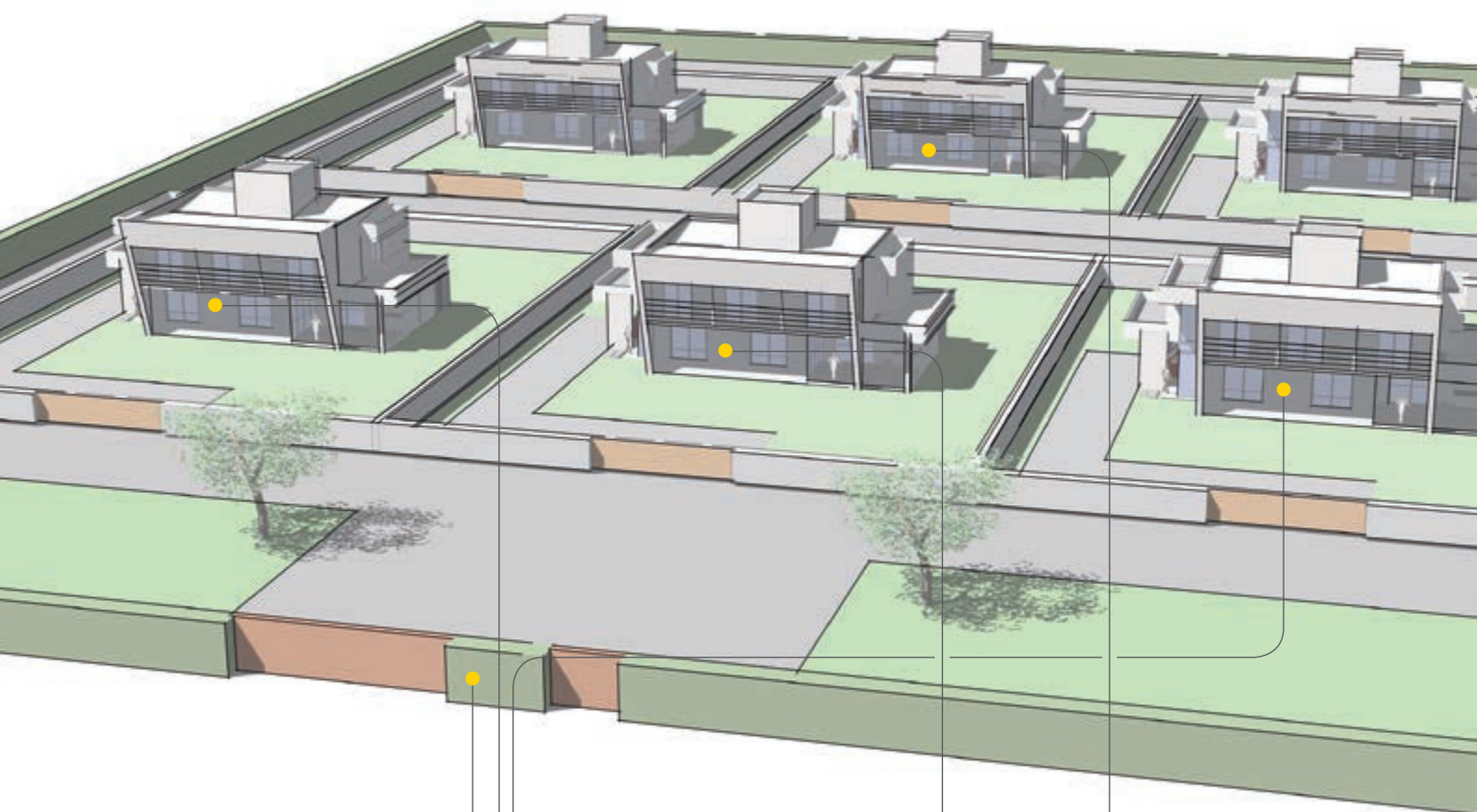

Pixel series
entrance panel



Tab 4,3 video
entryphone

VIEW 
IoT smart life



Tab 7S video
entryphone

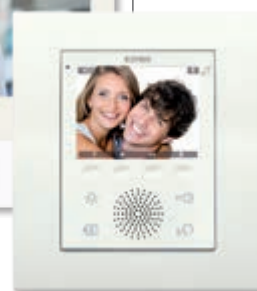

5700 series video
entryphone

Due Fili Plus - Examples of standard systems

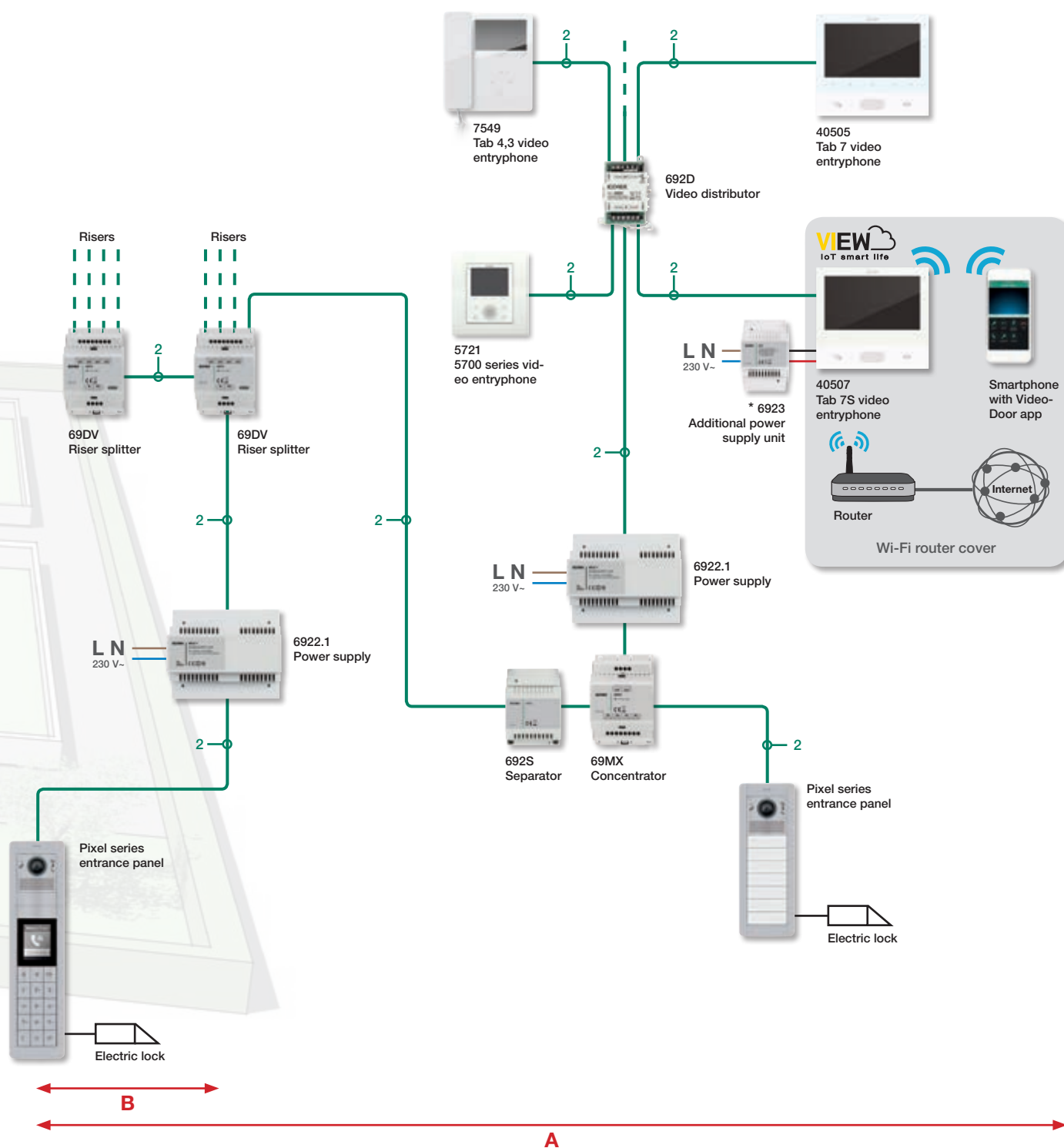

Type of cable	Max distance A	Max distance B	Max cable run
732L.E... or 732H.E...	570 m	250 m	2000 m
Cat.5 or Cat.6	470 m	200 m	2000 m

Maximum number of riser splitters: 2 devices in series for a maximum of 8 risers, or connect 4 riser splitters in cascade to the outputs of another splitter for a maximum of 16 risers. The maximum distance and the extended cable are taken into account for a single riser of the 69DV, from the entrance panel to the last device on the riser.

Note: In a system with 200 indoor units use only the cables indicated in the table.

Legend

- A - Maximum distance between the indoor unit and the furthest entrance panels
- B - Maximum distance between the entrance panel and the power supply

* Additional power supply 6923 for use always with each Tab 7S video entryphone.

Due Fili Plus - Examples of standard systems

Residential complex with video door entry system serving up to 200 indoor units, and porter switchboard.



Due Fili Plus - Examples of standard systems

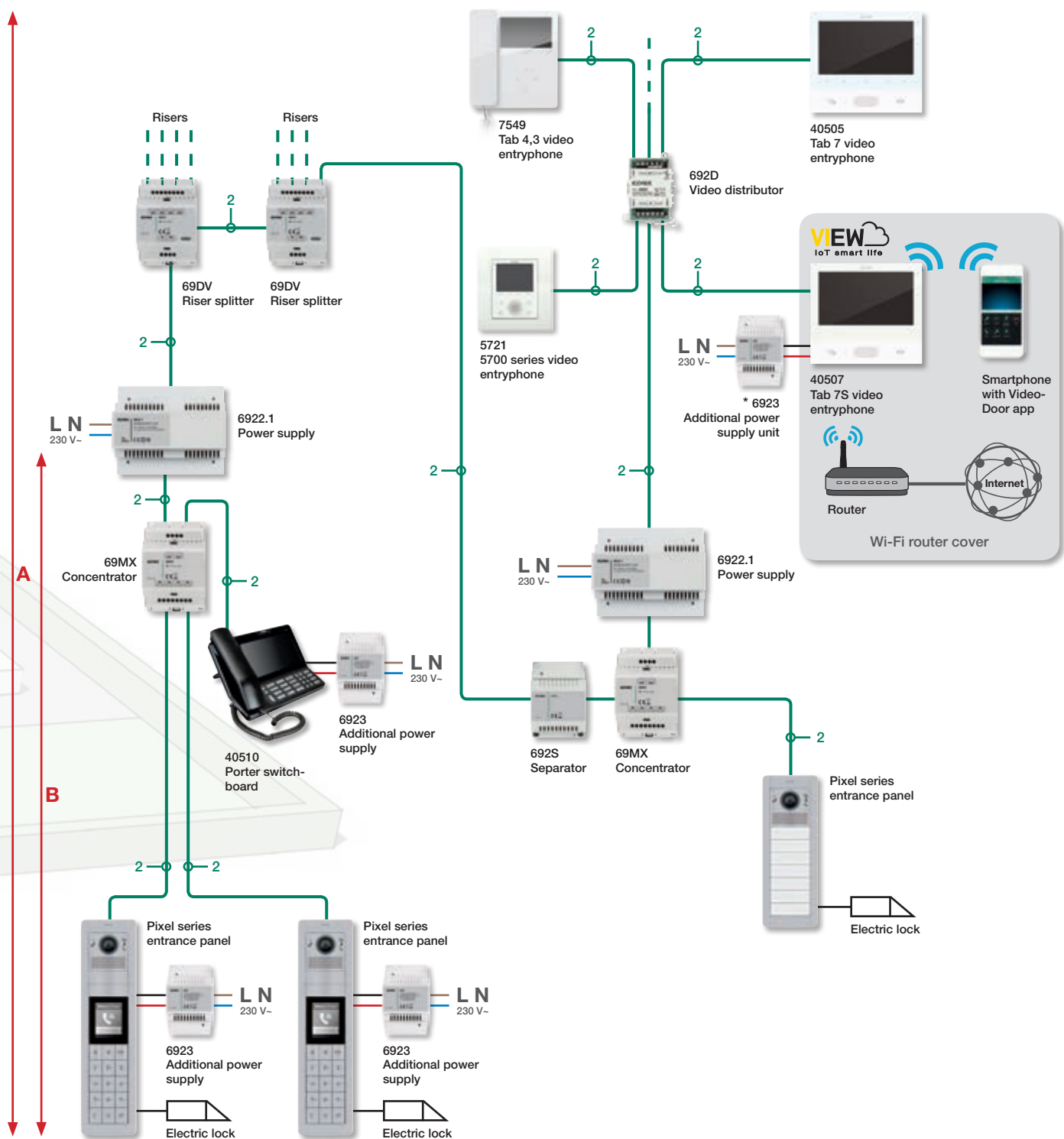

Type of cable	Max distance A	Max distance B	Max cable run
732L.E... or 732H.E...	840 m	520 m	2000 m
Cat.5 or Cat.6	710 m	440 m	2000 m

Maximum number of riser splitters: 2 devices in series. The maximum distance and the extended cable are taken into account for a single riser of the 69DV, from the entrance panel to the last device on the riser.

Note: In a system with 200 indoor units use only the cables indicated in the table.

Legend

- A** - Maximum distance between the indoor unit and the furthest entrance panels
- B** - Maximum distance between the entrance panel and the power supply

* Additional power supply 6923 for use always with each Tab 7S video entryphone.

Due Fili Plus - Examples of standard systems

Residential complex with video door entry system serving up to 500 indoor units.



Due Fili Plus - Examples of standard systems

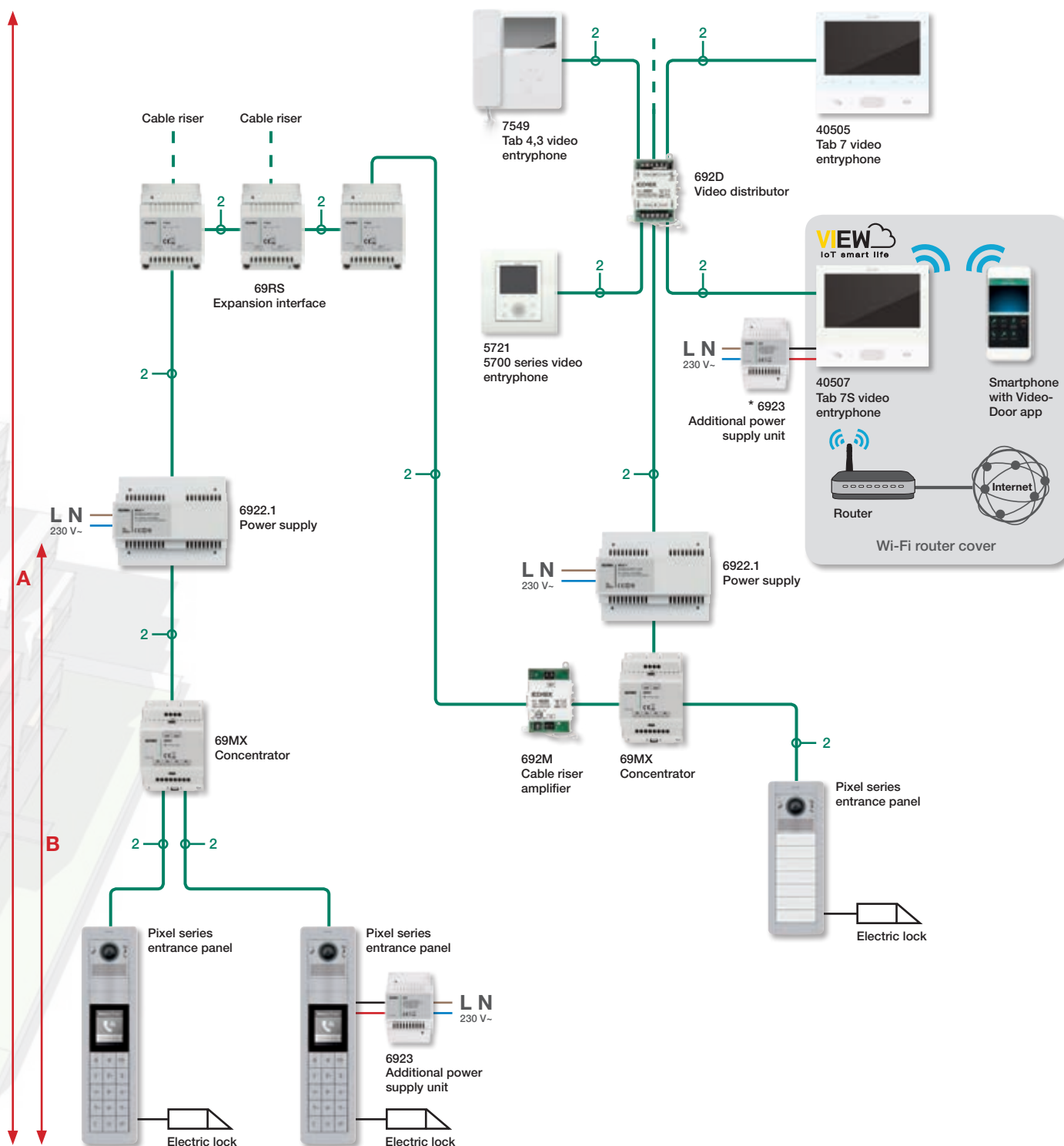

Type of cable	Video amplifiers	Max distance A	Max distance B	Max cable run
732L.E... or 732H.E...	1	840 m	520 m	2000 m
Cat.5 or Cat.6	1	710 m	440 m	2000 m

Table relating to configuration with 1 external unit and individually activated indoor units. In the system it is possible to connect up to a maximum of 32 69RS and maximum 10 connected in enter-exit together. The maximum distance and the extended cable are taken into account for a single riser of the 69DV, from the entrance panel to the last device on the riser.

Note: in a system with 500 indoor units use only the cables indicated in the table.

Legend

- A - Maximum distance between the indoor unit and the furthest entrance panels
- B - Maximum distance between the entrance panel and the power supply

* Additional power supply 6923 for use always with each Tab 7S video entryphone.

*** Connect a maximum of 8 enter-exit 69RS devices in the same electrical panel (max total length of the enter-exit cable: 7 m)

One-family expandable video entryphone kits

Pixel series + Tab



▲ K40507G.01

Video entryphone kit, with:

- 1 1-module entrance panel Pixel series (41131.01), grey, with mounting frame + 1 button;
- 1 audio/video colour electronic unit with teleloop and wide-angle camera (41005);
- 1 Tab 7S hands-free video door entryphone (40507), white, with integrated Wi-Fi for the remote control of the call on smartphone;
- 1 audio/video front module with teleloop (41105.01), grey;
- 1 flush mounting box (9191);
- 1 supply unit (6922.1)



Δ K40507.01

Video entryphone kit, with:

- 1 1-module entrance panel Pixel series (41131.01), grey, with mounting frame;
- 1 audio/video colour electronic unit (41003);
- 1 Tab 7S hands-free video door entryphone (40507), white, with integrated Wi-Fi for the remote control of the call on smartphone;
- 1 audio/video front module (41103.01), grey;
- 1 flush mounting box (9191);
- 1 supply unit (6922.1)



▲ K40505G.01

Video entryphone kit, with:

- 1 1-module entrance panel Pixel series (41131.01), grey, with mounting frame + 1 button;
- 1 audio/video colour electronic unit with teleloop and wide-angle camera (41005);
- 1 1 Tab 7 hands-free video door entryphone (40505), white;
- 1 audio/video front module with teleloop (41105.01), grey;
- 1 flush mounting box (9191);
- 1 supply unit (6922.1)



Δ K40505.01

Video entryphone kit, with:

- 1 1-module entrance panel Pixel series (41131.01), grey, with mounting frame;
- 1 audio/video colour electronic unit (41003);
- 1 Tab 7 hands-free video door entryphone (40505), white;
- 1 audio/video front module (41103.01), grey;
- 1 flush mounting box (9191);
- 1 supply unit (6922.1)



▲ K7539G.01

Video entryphone kit, with:

- 1 Pixel video entrance panel (41131.01) + 1 button;
- 1 audio/video electronic unit with teleloop and wide-angle camera (41005);
- 1 Tab hands-free video door entryphone (Tab Free 7539), white;
- 1 audio/video front module with teleloop (41105.01), grey;
- 1 flush mounting box (9191);
- 1 supply unit (6922.1)



Δ K7539.01

Video entryphone kit, with:

- 1 Pixel video entrance panel (41131.01+41103.01);
- 1 audio/video electronic unit (41003);
- 1 Tab hands-free video door entryphone (Tab Free 7539), white;
- 1 flush mounting box (9191);
- 1 supply unit (6922.1)



▲ K7549G.01

Video entryphone kit, with:

- 1 Pixel video entrance panel (41131.01) + 1 button;
- 1 audio/video electronic unit with teleloop and wide-angle camera (41005);
- Tab video door entryphone (Tab 4,3" 7549), white;
- 1 audio/video front module with teleloop (41105.01), grey;
- 1 flush mounting box (9191);
- 1 supply unit (6922.1)



Δ K7549.01

Video entryphone kit, with:

- 1 Pixel video entrance panel (41131.01+41103.01+41113.01+41110);
- 1 audio/video electronic unit (41003);
- Tab video door entryphone (Tab 4,3" 7549), white;
- 1 flush mounting box (9191);
- 1 supply unit (6922.1)

One-family expandable entryphone kits

Pixel series + Tab



K7509.01

Door entryphone kit, with:

- 1 entrance panel Pixel series (41131.01+41100.01+41113.01+41110);
- 1 audio electronic unit (41000);
- 1 Tab interphone (Tab jr. 7509), white;
- 1 flush mounting box (9191);
- 1 supply unit (40101)

One-family expandable video entryphone kits

1300 series + Tab



K40507/M

Video entryphone kit, with:

- 1 surface/flush mounting entrance panel 1300 series (13K1 with 1 additional button R131);
- 1 audio/video colour electronic unit (13F2);
- 1 Tab 7S hands-free video door entryphone (40507), white, with integrated Wi-Fi for the remote control of the call on smartphone;
- 1 supply unit (6922.1)



K40505/M

Video entryphone kit, with:

- 1 surface/flush mounting entrance panel 1300 series (13K1 with 1 additional button R131);
- 1 audio/video colour electronic unit (13F2);
- 1 Tab 7 video door entryphone (40505), white;
- 1 supply unit (6922.1)



7539/M

Video entryphone kit, with:

- 1 surface/flush mounting entrance panel 1300 series (13K1 with 1 additional button R131);
- 1 audio/video colour electronic unit (13F2);
- 1 Tab hands-free video door entryphone (Tab Free 7539), white;
- 1 supply unit (6922.1)



7549/M

Video entryphone kit, with:

- 1 surface/flush mounting entrance panel 1300 series (13K1 with 1 additional button R131);
- 1 audio/video colour electronic unit (13F2);
- 1 Tab video door entryphone (Tab 4,3" 7549), white;
- 1 supply unit (6922.1)



7539/K

Video entryphone kit, with:

- 1 1300 series entrance panel (1321);
- 1 audio/video electronic unit (13F5);
- 1 Tab hands-free video door entryphone (Tab Free 7539), white;
- 1 flush mounting box (9192);
- 1 supply unit (6922.1)



7549/K

Video entryphone kit, with:

- 1 1300 series entrance panel (1321);
- 1 audio/video electronic unit (13F5);
- 1 Tab video door entryphone (Tab 4,3" 7549), white;
- 1 flush mounting box (9192);
- 1 supply unit (6922.1)

1300 series



5721/K

Video entryphone kit, with:

- 1 1300 series entrance panel (1321);
- 1 audio/video electronic unit (13F5);
- 1 5700 video door entryphone (5721+6149), white;
- 1 flush mounting box (9192);
- 1 supply unit (6922.1)



6611/KA

Video entryphone kit, with:

- 1 1300 series entrance panel (1321);
- 1 audio/video electronic unit (13F5);
- 1 6600 video door entryphone (6611+6149), white;
- 1 flush mounting box (9192);
- 1 supply unit (6922.1)



6329/KAC

Video entryphone kit, with:

- 1 1300 series entrance panel (1321);
- 1 audio/video electronic unit (13F5);
- 1 Giotto video door entryphone (6329/C), white;
- 1 flush mounting box (9192);
- 1 supply unit (6922.1)

One-family expandable video entryphone kits

1200 series



6329/KCI

Video entryphone kit, with:

- 1 1200 series entrance panel (1221);
- 1 audio/video electronic unit (13F5);
- 1 Giotto video door entryphone (6329/C), white;
- 1 flush mounting box (9192);
- 1 supply unit (6922.1)

8000 series



Δ 6621/K

Video entryphone kit, with:

- 1 8000 series entrance panel (89F5/C1);
- 1 audio/video electronic unit;
- 1 6600 video door entryphone (6621+6149), white;
- 1 flush mounting box (9192);
- 1 supply unit (6922.1)



Δ 6611/K

Video entryphone kit, with:

- 1 8000 series entrance panel (89F5/C1);
- 1 audio/video electronic unit;
- 1 6600 video door entryphone (6611+6149), white;
- 1 flush mounting box (9192);
- 1 supply unit (6922.1)

One-family expandable video entryphone kits (up to 200 inner stations)

8000 and 8100 series



6209/K1

Door entryphone kit, with:

- 1 8000 series entrance panel (8010+8001+8082);
- 1 audio electronic unit (6931);
- 1 Petrarca video door entryphone (6209), white;
- 1 flush mounting box (9192);
- 1 supply unit (40101)



Δ 6209/KF

Door entryphone kit, with:

- 1 8100 series entrance panel (8101);
- 1 audio electronic unit (6931);
- 1 Petrarca video door entryphone (6209), white;
- 1 supply unit (40101)

Pixel and Pixel Heavy series: audio/video and audio entrance panels

Audio/video electronic units



Δ 41005

Audio/Video, 4 buttons, with teleloop and wide-angle colour camera



Δ 41003

Audio/Video, 4 buttons



Δ 41004

Audio/Video, 4 buttons, with teleloop and wide-angle colour camera



41000

Audio, 4 buttons



41002

Audio, 4 buttons, with teleloop and 1 camera input



Δ 41001

Audio, 4 buttons, with teleloop

Pixel and Pixel Heavy series: audio/video and audio entrance panels

Electronic expansion units for audio/video units and accessories



41010
10 buttons in 2 rows



41018
3,5" display and 3 buttons



41019
Alphanumeric keypad



41015
Name-plate



41016
Fingerprint reader



41017
Transponder reader

41020
Keypad for access control



41190
Cable for vertical and/or horizontal wiring of modules with integrated IP protection, length 485 mm



41191
Cable for internal connection of modules with integrated IP protection, length 245 mm

Pixel series: audio/video and audio entrance panels

Front modules



41100.01
Audio for 41000 unit, grey



41102.01
Audio for 41001 unit, with video camera input and teleloop function, grey



Δ 41101.01
Audio teleloop for 41001 unit, grey

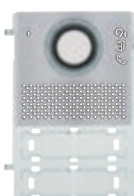

41103.01
Audio/Video for 41003 unit, grey

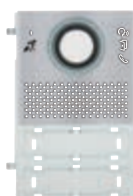

▲ 41105.01
Audio/Video teleloop for 41005 unit, grey

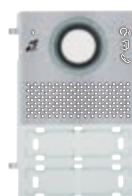

Δ 41104.01
Audio/Video teleloop for 41004 unit, grey

41100.02
As above, slate grey

41102.02
As above, slate grey

As above, slate grey

As above, slate grey

As above, slate grey

As above, slate grey

41100.03
As above, white

41102.03
As above, white

As above, white

As above, white

As above, white

As above, white



41118.01
Display for 41018 unit, grey

41118.02
As above, slate grey

41118.03
As above, white

Pixel series: audio/video and audio entrance panels

Front modules, buttons and blank buttons



41119.01
Keypad for 41019
and 41020 units,
grey



41115
Name-plate
for 41015 unit



41116.01
Fingerprint reader for
41016 unit, grey



41117
Transponder reader with
interchangeable labels in
grey, slate grey and white

41119.02
As above,
slate grey

41116.02
As above,
slate grey

41119.03
As above,
white

41116.03
As above,
white

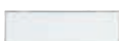

41110
Single axial button



41111
Single rocker button

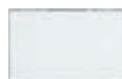

41112
Double axial button



41113.01
Single blank button,
grey



41114.01
Double blank button,
grey



41121.01
Blank module,
grey

41113.02
As above,
slate grey

41114.02
As above,
slate grey

41121.02
As above,
slate grey

41113.03
As above,
white

41114.03
As above,
white

41121.03
As above,
white

Frames and cover plates



41131.01
1 module,
grey



41132.01
2 modules,
grey



41133.01
3 modules,
grey

41131.02
As above,
slate grey

41132.02
As above,
slate grey

41133.02
As above,
slate grey

41131.03
As above,
white

41132.03
As above,
white

41133.03
As above,
white

41131.04
As above,
anodized grey

41132.04
As above,
anodized grey

41133.04
As above,
anodized grey

Mounting boxes



9191
1 module









9192
2 modules









9193
3 modules

Pixel series: audio/video and audio entrance panels



Rainproof cover

						
41141.01 1 module, grey	41142.01 2 modules, grey	41143.01 3 modules, grey	41144.01 4 modules (2x2), grey	41146.01 6 modules (2x3), grey	41147.01 6 modules (3x2), grey	41149.01 9 modules (3x3), grey
41141.02 As above, slate grey	41142.02 As above, slate grey	41143.02 As above, slate grey	41144.02 As above, slate grey	41146.02 As above, slate grey	41147.02 As above, slate grey	41149.02 As above, slate grey
41141.03 As above, white	41142.03 As above, white	41143.03 As above, white	41144.03 As above, white	41146.03 As above, white	41147.03 As above, white	41149.03 As above, white
41141.04 As above, anodized grey	41142.04 As above, anodized grey	41143.04 As above, anodized grey	41144.04 As above, anodized grey	41146.04 As above, anodized grey	41147.04 As above, anodized grey	41149.04 As above, anodized grey

Surface mounting boxes with built-in rainproof cover

						
41151.01 1 module, grey	41152.01 2 modules, grey	41153.01 3 modules, grey	41154.01 4 modules (2x2), grey	41156.01 6 modules (2x3), grey	41157.01 6 modules (3x2), grey	41159.01 9 modules (3x3), grey
41151.02 As above, slate grey	41152.02 As above, slate grey	41153.02 As above, slate grey	41154.02 As above, slate grey	41156.02 As above, slate grey	41157.02 As above, slate grey	41159.02 As above, slate grey
41151.03 As above, white	41152.03 As above, white	41153.03 As above, white	41154.03 As above, white	41156.03 As above, white	41157.03 As above, white	41159.03 As above, white
41151.04 As above, anodized grey	41152.04 As above, anodized grey	41153.04 As above, anodized grey	41154.04 As above, anodized grey	41156.04 As above, anodized grey	41157.04 As above, anodized grey	41159.04 As above, anodized grey

Universal adaptors

			
41135.01 1 module, grey	41135.03 1 module, white	41136.01 2 modules, grey	41136.03 2 modules, white
41135.02 As above, slate grey	41135.04 As above, anodized grey	41136.02 As above, slate grey	41136.04 As above, anodized grey

Due Fili Plus technology

Pixel Heavy series: audio/video and audio entrance panels

Front modules



41200
Audio for 41000 unit,
IK10 and IP54
protection



41201
Audio, 1-button, for
41000 unit, IK10 and
IP54 protection



41202
Audio, 1-button, for
41000 unit, IK10 and
IP54 protection



41204
Audio, 4-button in 2
rows, for 41000 unit,
IK10 and IP54
protection



41210
Audio for 41001 unit,
with teleloop, IK10 and
IP54 protection



41211
Audio, 1-button,
for 41001 unit, with
teleloop, IK10 and
IP54 protection



41212
Audio, 2-button, for
41001 unit, with tele-
loop, IK10 and IP54
protection



41214
Audio, 4-button, for
41001 unit, with tele-
loop, IK10 and IP54
protection



Δ 41260
Audio/Video for 41003
unit, no buttons, IK10
and IP54 protection



Δ 41261
Audio/Video, 1-button,
for 41003 unit, IK10
and IP54 protection



Δ 41262
Audio/Video, 2-button,
for 41003 unit, IK10
and IP54 protection



Δ 41264
Audio/Video, 4-button
in 2 rows, for 41003
unit, IK10 and IP54
protection



41270
Audio/Video for 41004
and 41005 unit, no
buttons, with teleloop,
IK10 and IP54 pro-
tection

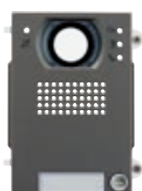

41271
Audio/Video for 41004
and 41005 unit, 1-but-
ton, with teleloop, IK10
and IP54 protection



41272
Audio/Video for 41004
and 41005 unit, 2-but-
ton, with teleloop, IK10
and IP54 protection



41274
Audio/Video for 41004
and 41005 unit, 4-but-
ton in 2 rows, with
teleloop, IK10 and IP54
protection



41223
For 41010 unit,
3-button, IK10 and
IP54 protection



41225
For 41010 unit,
5-button, IK10 and
IP54 protection



41230
For 41010 unit,
10-button in 2 rows,
IK10 and IP54 pro-
tection



41218
Display for 41018
unit, IK9 and IP54
protection



41219
Keypad for 41019
and 41020 unit, IK9
and IP54 protection



41215
Name-plate for 41015
unit, IK10 and IP54
protection



41221
Blank module, IK10
and IP54 protection

Pixel Heavy series: audio/video and audio entrance panels

Frames and cover plates

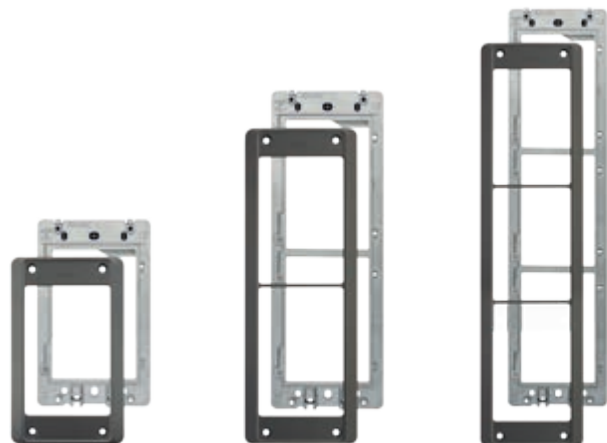

41231
1 module

41232
2 modules

41233
3 modules

Tearproof mounting boxes



40291
1 module,
stainless steel

40292
2 modules,
stainless steel

40293
3 modules,
stainless steel

1300, 1200, reinforced 1200 and 8000 series: audio/video and audio entrance panels

Audio/video electronic units



13F2
Audio/Video for
13K1 entrance
plate

13F5
Audio/Video,
8-button in
2 rows

13F7
Audio/Video, with
alphanumeric
keypad, stainless
steel buttons

13F7/43
As above,
gold finish button

Audio electronic units



13F1
Audio/Video for
13K1 entrance
plate

13F3
Audio,
8-button in
2 rows

13F4
Audio, with
alphanumeric
keypad, stainless
steel buttons

13F4/43
As above,
gold finish button
only for 1200 series



12TS
4-button
additional unit



12TD
8-button
additional unit

Δ 12TS/0
Expansion
module for
8 buttons

Due Fili Plus technology

1300 series: audio/video and audio entrance panels

2-module audio/video and additional entrance plates



1321
1-button and
3 blank covers,
electropolished
anodized aluminium



132D
Alphanumeric
keypad,
electropolished
anodized aluminium



1358
Additional,
8-button,
electropolished
anodized aluminium



132N
Additional,
with name-plate,
electropolished
anodized aluminium



1331
1-button and
7 blank covers,
electropolished
anodized aluminium



133D
Alphanumeric
keypad and
1 name-plate,
electropolished
anodized aluminium



133N
Additional,
with name-plate,
electropolished
anodized aluminium



1372
Additional,
12-button,
electropolished
anodized aluminium

Accessories



R130
Blank module for
1300 entrance plate



R131
Button for 1300
entrance plate



R200
Single button for
entrance panels

R200/50
As above,
in pack of 50 pieces



9192
2 modules



9193
3 modules

Mounting boxes

2- and 3-module rainproof covers



C321
2 modules,
electropolished
anodized aluminium



C331
3 modules,
electropolished
anodized aluminium

C322
2x2 modules,
electropolished
anodized aluminium

C332
3x2 modules,
electropolished
anodized aluminium



C323
2x3 modules,
electropolished
anodized aluminium

C333
3x3 modules,
electropolished
anodized aluminium



C324
2x4 modules,
electropolished
anodized aluminium

C334
3x4 modules,
electropolished
anodized aluminium

Due Fili Plus technology

1300 series: audio/video and audio entrance panels

Surface mounting boxes with built-in rainproof cover



S321
2 modules,
electropolished
anodized
aluminium



S331
3 modules,
electropolished
anodized
aluminium

S322
2x2 modules,
electropolished
anodized
aluminium

S332
3x2 modules,
electropolished
anodized
aluminium



S323
2x3 modules,
electropolished
anodized
aluminium

S333
3x3 modules,
electropolished
anodized
aluminium



S324
2x4 modules,
electropolished
anodized
aluminium

S334
3x4 modules,
electropolished
anodized
aluminium

Audio/video reduced module entrance panels



13K1
1-button, entrance plate for
surface and flush mounting,
electropolished anodized
aluminium



91K1
Flush mounting box
for 13K1

1200 series: audio/video and audio entrance panels

2-module audio/video entrance plates



1220
No buttons,
stainless steel



1221
1-button,
stainless steel



1222
2-button,
stainless steel



1223
3-button,
stainless steel



1224
4-button,
stainless steel



Δ 1222/D
2-button in 2 rows,
stainless steel



Δ 1224/D
4-button in 2 rows,
stainless steel

1200 series: audio/video and audio entrance panels

2-module audio/video entrance plates



Δ 1226/D
6-button in 2 rows,
stainless steel



Δ 1228/D
8-button in 2 rows,
stainless steel



122D
Alphanumeric
keypad,
stainless steel



Δ 12NN
Without buttons
+ name-plate,
stainless steel

1200 series: audio/video and audio entrance panels

2-module additional entrance plates



1251
1-button,
stainless steel



1252
2-button,
stainless steel



1253
3-button,
stainless steel



1254
4-button,
stainless steel



1255
5-button,
stainless steel



1256
6-button,
stainless steel



1257
7-button,
stainless steel



1258
8-button,
stainless steel



Δ 1252/D
2-button in 2 rows,
stainless steel



Δ 1254/D
4-button in 2 rows,
stainless steel



Δ 1256/D
6-button in 2 rows,
stainless steel



Δ 1258/D
8-button in 2 rows,
stainless steel



Δ 1280/D
10-button in 2 rows,
stainless steel



122N
With name-plate,
stainless steel

Due Fili Plus technology

1200 series: audio/video and audio entrance panels

3-module audio/video entrance plates



1230
No buttons,
stainless steel



1231
1-button,
stainless steel



1232
2-button,
stainless steel



1233
3-button,
stainless steel



1234
4-button,
stainless steel



1235
5-button,
stainless steel



1236
6-button,
stainless steel



1237
7-button,
stainless steel



1238
8-button,
stainless steel



12N1
1-button + name-plate,
stainless steel



12N2
2-button + name-plate,
stainless steel



12N3
3-button + name-plate,
stainless steel



12N4
4-button + name-plate,
stainless steel



12A1
1-button +
biometric sensor,
stainless steel



12A2
2-button +
biometric sensor,
stainless steel



12A3
3-button +
biometric sensor,
stainless steel



12A4
4-button +
biometric sensor,
stainless steel



Δ 1232/D
2-button in 2 rows,
stainless steel



Δ 1234/D
4-button in 2 rows,
stainless steel



Δ 1236/D
6-button in 2 rows,
stainless steel



Δ 1238/D
8-button in 2 rows,
stainless steel

Due Fili Plus technology

1200 series: audio/video and audio entrance panels

3-module audio/video entrance plates



Δ 1240/D
10-button in 2 rows,
stainless steel



Δ 1242/D
12-button in 2 rows,
stainless steel



Δ 1244/D
14-button in 2 rows,
stainless steel



Δ 1246/D
16-button in 2 rows,
stainless steel



Δ 12N2/D
2-button in 2 rows
+ name-plate,
stainless steel



Δ 12N4/D
4-button in 2 rows
+ name-plate,
stainless steel



Δ 12N6/D
6-button in 2 rows
+ name-plate,
stainless steel



Δ 12N8/D
8-button in 2 rows
+ name-plate,
stainless steel



123D
Alphanumerical
keypad + name-plate,
stainless steel



12AD
Alphanumerical
keypad + biometric
sensor,
stainless steel

3-module additional entrance plates



1261
1-button,
stainless steel



1262
2-button,
stainless steel



1263
3-button,
stainless steel



1264
4-button,
stainless steel



1265
5-button,
stainless steel



1266
6-button,
stainless steel



1267
7-button,
stainless steel

Due Fili Plus technology

1200 series: audio/video and audio entrance panels

3-module additional entrance plates



1268
8-button,
stainless steel



1269
9-button,
stainless steel



1270
10-button,
stainless steel



1271
11-button,
stainless steel



1272
12-button,
stainless steel



Δ 1262/D
2-button in 2 rows,
stainless steel



Δ 1264/D
4-button in 2 rows,
stainless steel



Δ 1266/D
6-button in 2 rows,
stainless steel



Δ 1268/D
8-button in 2 rows,
stainless steel



Δ 1270/D
10-button in 2 rows,
stainless steel



Δ 1272/D
12-button in 2 rows,
stainless steel



Δ 1274/D
14-button in 2 rows,
stainless steel



Δ 1276/D
16-button in 2 rows,
stainless steel



Δ 1278/D
18-button in 2 rows,
stainless steel



Δ 1290/D
20-button in 2 rows,
stainless steel



Δ 1292/D
22-button in 2 rows,
stainless steel



Δ 1294/D
24-button in 2 rows,
stainless steel



123N
With name-plates,
stainless steel

Due Fili Plus technology

1200 series: audio/video and audio entrance panels

2- and 3-module flush mounting and angular surface mounting boxes



9192
2 modules



9193
3 modules



1A21
Angular, 2 modules,
stainless steel



1A31
Angular, 3 modules,
stainless steel

2- and 3-module rainproof covers



1P21
2 modules,
stainless steel



1P31
3 modules,
stainless steel



1P22
2x2 modules,
stainless steel



1P32
3x2 modules,
stainless steel



1P23
2x3 modules,
stainless steel



1P33
3x3 modules,
stainless steel



1P24
2x4 modules,
stainless steel



1P34
3x4 modules,
stainless steel

2- and 3-module surface mounting boxes with built-in rainproof cover



1E21
2 modules,
stainless steel



1E31
3 modules,
stainless steel



1E22
2x2 modules,
stainless steel



1E32
3x2 modules,
stainless steel



1E23
2x3 modules,
stainless steel



1E33
3x3 modules,
stainless steel



1E24
2x4 modules,
stainless steel



1E34
3x4 modules,
stainless steel

Due Fili Plus technology

Reinforced 1200 series: audio/video and audio entrance panels

2-module audio/video and additional entrance plates



1220/35
No buttons,
IK10 protection,
sable grey



1221/35
1-button,
IK10 protection,
sable grey



1222/35
2-button,
IK10 protection,
sable grey



1223/35
3-button,
IK10 protection,
sable grey



1224/35
4-button,
IK10 protection,
sable grey



1258/35
Additional,
8-button,
IK10 protection,
sable grey



122D/35
Alphanumeric
keypad,
IK10 protection,
sable grey



122N/35
Additional,
name-plate,
IK10 protection,
sable grey

Flush mounting boxes



9192
2 modules

1200 series

Audio/video columns



12C...
With buttons,
height: 173 cm

12C../B
With buttons,
height: 147 cm



12CD
With alphanumeric keypad,
height: 173 cm

12CD/B
With alphanumeric keypad,
height: 147 cm

Column - height 173 cm

Code	Color	Button
12C1	stainless steel	1
12C2		2
Δ 12C3		3
Δ 12C4		4
Δ 12C8		8

Column - height 147 cm

Code	Color	Button
12C1/B	stainless steel	1
12C2/B		2
Δ 12C3/B		3
Δ 12C4/B		4
Δ 12C8/B		8

Due Fili Plus technology

8000 series: audio/video and audio entrance panels

Standard modules for audio/video entrance panels



RPC5
Audio/video, for
RPR1, RP00, RP01,
RP02, RP03,
light grey



RPR1
Keypad and display,
for RPC5, RPF3,
light grey



RP00
Without buttons,
with BUSY-WAIT,
light grey



RP01
1-button, with
BUSY-WAIT,
light grey



RP02
2-button, with
BUSY-WAIT,
light grey



RP03
3-button, with
BUSY-WAIT,
light grey

Standard modules for audio entrance panels



RPF3
Audio for
RPR1, RP00, RP01,
RP02, RP03,
light grey



RPR1
Keypad and display,
for RPC5, RPF3,
light grey



RP00
Without buttons,
with BUSY-WAIT,
light grey



RP01
1-button, with
BUSY-WAIT,
light grey



RP02
2-button, with
BUSY-WAIT,
light grey



RP03
3-button, with
BUSY-WAIT,
light grey

Additional modules



RPS1
1-button,
for 12TS,
light grey



RPS2
2-button,
for 12TS,
light grey



RPS3
3-button,
for 12TS,
light grey



RPS4
4-button,
for 12TS,
light grey



805N
Name-plate
for 13 names,
light grey



80PN
House number,
light grey



8000
Blank module,
light grey

Frames with cover plates



8082
Frame for 2 modules
and for additional
modules only,
light grey



8092
2 modules for
electronic units
13F3, 13F4,
13F5, 13F7,
12TS, 12TD,
light grey



8083
Frame for 3 modules
and for additional
modules only,
light grey



8093
3 modules for
electronic units
13F3, 13F4, 13F5,
13F7, 12TS, 12TD,
light grey

8000 series: audio/video and audio entrance panels

Flush mounting boxes



9192
2 modules



9193
3 modules



9312/A
Angular,
2 modules,
light grey

9313/A
Angular,
3 modules,
light grey



9322/A
Angular,
4 modules 2x2,
light grey

9323/A
Angular,
6 modules 2x3,
light grey

Rainproof covers



9212
2 modules,
light grey

9213
3 modules,
light grey



9222
2x2 modules,
light grey

9223
2x3 modules,
light grey



9232
3x2 modules,
light grey

9233
3x3 modules,
light grey



9242
4x2 modules,
light grey

9243
4x3 modules,
light grey

Surface mounting boxes



9312
2 modules,
light grey

9313
3 modules,
light grey



9322
2x2 modules,
light grey

9323
2x3 modules,
light grey



9332
3x2 modules,
light grey

9333
3x3 modules,
light grey



9342
4x2 modules,
light grey

9343
4x3 modules,
light grey

Due Fili Plus technology

8000 and 8100 series - Up to 200 internal units

Audio/video electronic units



692U
Due Fili unit for black and white audio/video entrance panel.
(8000 series: 8019, 8019/...+80P1; 8100 series: 81V1)



692U/C
Due Fili unit for colour audio/video entrance panel.
(8000 series: 8T19, 8T19/...+80P1)



6931
Due Fili electronic unit for audio entrance panel, up to 200 internal units

Standard modules for audio/video entrance panels with Due Fili technology



Δ 8019
Black and white standard audio/video module, light grey



8T19
Colour standard audio/video module, light grey



80PA
Standard audio module, light grey



80P1
1-button standard module with BUSY-WAIT indication, light grey

8100 series with "BUSY-WAIT" indication



Δ 81V1
Surface mounting cover plate for audio/video entrance panel with frame and rainproof trim, aluminium

Due Fili Plus technology

Patavium series: audio/video and audio entrance panels

Audio/video entrance panels with built-in electronic units



Δ 13T5/0
No buttons,
satin brass



Δ 13T5/1
1-button,
satin brass



Δ 13T5/2
2-button,
satin brass



Δ 13T5
3-button,
satin brass



Δ 13T7
With keypad
and display,
satin brass

Audio entrance panels with built-in electronic units



Δ 13T3/0
No buttons,
satin brass



Δ 13T3/1
1-button,
satin brass



Δ 13T3/2
2-button,
satin brass



Δ 13T3
3-button,
satin brass



Δ 13T4
With keypad
and display,
satin brass

Additional entrance panels with built-in electronic units



Δ 8054/T
Additional,
8-button,
satin brass



Δ 805N/T
Additional,
with 3 name-plates,
satin brass

Due Fili Plus technology

Inox Flat series: audio/video and audio entrance panels

Audio/video entrance panels with built-in electronic units



13I7
With keypad and display, 2 modules, stainless steel



13I7/K
With keypad and display, 3 modules, stainless steel



13I4
With keypad and display, 2 modules, stainless steel



13I4/K
With keypad and display, 3 modules, stainless steel

Letterboxes

Audio/video electronic units



13C5
Electronic unit for post box version of audio or video entrance panel, to complete with 2559 / 2930



2559
Electronic audio/video unit for post box, to complete with 13C5



13C5
Electronic unit for post box version of audio or video entrance panel, to complete with 2559 / 2930



2930
Audio electronic unit with loudspeaker/microphone, to complete with 13C5

Accessories for electronic audio/video and audio units



693P/M
Additional module for 8-button



693P
Expansion module for 8-button

Due Fili Plus technology

Letterboxes

Panels with hollow for post



Δ 2560/35
Blank panel
without hollow,
sable grey

Δ 2560/39
As above,
brushed aluminium

Δ 2560
As above,
light grey



Δ 2561/35
Panel with
hollow for post,
sable grey

Δ 2561/39
As above,
brushed aluminium

Δ 2561
As above,
light grey



Δ 256D/35
Pair of blank and
hollow for post
panels, sable grey

Δ 256D/39
As above,
brushed aluminium

Δ 256D
As above,
light grey

Audio/video panels with buttons



Δ 25V0/35
Audio/video,
no buttons,
sable grey

Δ 25V0/39
As above,
brushed aluminium

Δ 25V0
As above,
light grey



Δ 25V2/35
Audio/video, 2-button,
sable grey

Δ 25V2/39
As above,
brushed aluminium

Δ 25V2
As above,
light grey



Δ 25V4/35
Audio/video, 4-button,
sable grey

Δ 25V4/39
As above,
brushed aluminium

Δ 25V4
As above,
light grey



Δ 25V6/35
Audio/video, 6-button,
sable grey

Δ 25V6/39
As above,
brushed aluminium

Δ 25V6
As above,
light grey



Δ 25V8/35
Audio/video, 8-button,
sable grey

Δ 25V8/39
As above,
brushed aluminium

Δ 25V8
As above,
light grey

Additional panels with buttons



Δ 2504/35
Additional, 4-button,
sable grey

Δ 2504/39
As above,
brushed aluminium

Δ 2504
As above,
light grey



Δ 2508/35
Additional, 8-button,
sable grey

Δ 2508/39
As above,
brushed aluminium

Δ 2508
As above,
light grey



Δ 2512/35
Additional, 12-button,
sable grey

Δ 2512/39
As above,
brushed aluminium

Δ 2512
As above,
light grey



Δ 2516/35
Additional, 16-button,
sable grey

Δ 2516/39
As above,
brushed aluminium

Δ 2516
As above,
light grey

Letterboxes

Accessories for letterboxes

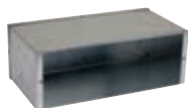

Δ 256S
Post box flush
mounting box



Δ 256I
Post box
anti-condensation
grille



Δ 25A3
Box with built-in
rainproof cover
for 3 panels

Δ 25C3
Box with built-in
rainproof cover
for 9 panels

Δ 25B3
As above,
for 6 panels

Δ 25D3
As above,
for 12 panels







Δ 256G
Post box side floor
support



Δ 256P
Post box central
floor support,
for 25A3

Letterboxes matching

Type	Number of calls	Power supply	Electronic unit	Audio panel 1-button	Additional button panel	Post hollow	Dimensions with flush box 256S	Floor support	Draws
25A3	2	6922.1	13C5 + 2559	25V2/35		2 x 2561/35	380x140 mm	2 x 256G 1 x 256P	
25B3	5	6922.1	13C5 + 2559	25V6/35		5 x 2561/35	777x454 mm	2 x 256G	
25C3	8	6922.1	13C5 + 2559	25V8/35		8 x 2561/35	1174x454 mm	2 x 256G	
25D3	10	6922.1	13C5 + 2559	25V2/35	2508/35	10 x 2561/35	1571x454 mm	2 x 256G	

Due Fili Plus technology

Letterbox entrance panels

Made of stainless steel with front and rear openings and built-in electronic unit - Up to 200 internal units



259F/P

Letterbox entrance panel with colour audio/video electronic unit

259F/P.EN

As above, English version

Audio/video, audio electronic units and accessories - Up to 200 internal units



6570

Black and white video electronic unit for use in conjunction with 6931

657C

Colour video electronic unit for use in conjunction with 6931



6931

Electronic unit for audio entrance panel, up to 200 internal units



693P

Expansion module for 8 buttons, for 6931



693T

CCTV-type camera interface

Front and rear opening letterbox entrance panels



2550/301

Front and rear opening letterbox entrance panel with 1 button, natural anodized aluminium

Δ 2550/301.35

As above, sable grey



2550/302

Front and rear opening letterbox entrance panel with 2 buttons, natural anodized aluminium

Δ 2550/302.35

As above, sable grey

Tab series: video entryphones and interphones

Video entryphones



40507
Surface mounting hands-free video entryphone, integrated Wi-Fi, 7" LCD display, teleloop facility for hearing aids, white



40507.04
Surface mounting hands-free video entryphone, integrated Wi-Fi, 7" LCD display, teleloop facility for hearing aids, black



40505
Surface mounting hands-free video entryphone, 7" LCD display, teleloop facility for hearing aids, white

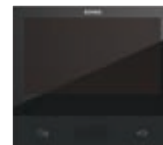

40505.04
Surface mounting hands-free video entryphone, 7" LCD display, teleloop facility for hearing aids, black



** App available free of charge for iOS and Android operating system



7539
Tab Free surface mounting hands-free video entryphone, 3,5" LCD display, teleloop facility for hearing aids, white



7539/04
Tab Free surface mounting hands-free video entryphone, 3,5" LCD display, teleloop facility for hearing aids, black



7549
Tab surface mounting video entryphone with handset, 4,3" LCD display, teleloop facility for hearing aids, white



7549/04
Tab surface mounting video entryphone with handset, 4,3" LCD display, teleloop facility for hearing aids, black

Interphones



7509
Surface mounting Tab jr. interphone with handset, white

7509/D
As above, facility for hard of hearing function



7509/04
Surface mounting Tab jr. interphone with handset, black

7509/D04
As above, facility for hard of hearing function

Due Fili Plus technology

Tab series: video entryphones and interphones

Accessories



40195
Table box for Tab 7 series
video entryphones



753S
8-module support (4+4)
for 7549 and 7529
surface mounting

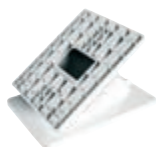

753A
Table mounting box,
white

753A/04
As above, black



753B
Interconnecting stud for
table mounting box

Wide Touch series: video entryphones

Video entryphones



Δ 7311
Speakerphone with 7" LCD
touch screen monitor, for
flush mounting, white



Δ 7249
Box for Wide Touch
flush mounting

5700 series: video entryphones

Video entryphones



5721
Flush mounting hands-free
video entryphone,
3,5" LCD display,
white

5721/D
As above, facility for
hard of hearing function



5721/04
Flush mounting hands-free
video entryphone,
3,5" LCD display,
black

Δ 5721/D04
As above, facility for
hard of hearing function



6149
8-module flush
mounting box

6600 series: video entryphones and interphones

Video entryphones



6621
Flush mounting video entryphone, 3,5" LCD display, vertical tilt movement, white

6721
As above, for surface mounting

6721/FD
As above, with function for hearing aid wearers

662C
As above, for desktop mounting



Δ 6621/21
Flush mounting video entryphone, 3,5" LCD display, vertical tilt movement, anthracite

Δ 6721/21
As above, for surface mounting

6721/FD21
As above, with function for hearing aid wearers



Δ 6621/37
Flush mounting video entryphone, 3,5" LCD display, vertical tilt movement, titanium

Δ 6721/37
As above, for surface mounting



6611
Flush mounting video entryphone, 3,5" LCD display, with 6 programmable buttons, white

6711
As above, for surface mounting

661C
As above, for desktop mounting



Δ 6611/21
Flush mounting video entryphone, 3,5" LCD display, with 6 programmable buttons, anthracite

Δ 6711/21
As above, for surface mounting

Δ 661C/21
As above, for desktop mounting



Δ 6611/37
Flush mounting video entryphone, 3,5" LCD display, with 6 programmable buttons, titanium

Δ 6711/37
As above, for surface mounting

Δ 661C/37
As above, for desktop mounting

Interphones



6601/AU
Flush mounting hands-free interphones, white

6701/AU
As above, for surface mounting

660C/AU
As above, for desktop mounting



6611/AU
Flush mounting hands-free interphones, with 6 programmable buttons, white

6711/AU
As above, for surface mounting

Δ 661C/AU
As above, for desktop mounting



6149
8-module flush mounting box

Giotto series: video entryphones

Video entryphones



6329
Surface mounting video entryphone, with 3,5" black/white monitor, with 3 buttons, white

6329/C
As above, with colour monitor

6329/CD
As above, with colour monitor and function for hearing aid wearers



661A
Desktop base for monitor, 2 m 13-conductor + 1 coaxial cable, white

661F
Desk base with 230 V~ power supply unit, for parallel mounting connection of monitor, white

Petrarca series: video entryphones and interphones

Video entryphones



6029
3,5" black/white
monitor, for surface
mounting, white

6029/C
As above,
with colour monitor



Δ 6029/21
3,5" black/white
monitor, for surface
mounting, anthracite

Δ 6029/C21
As above,
with colour monitor



Δ 6029/37
3,5" black/white
monitor, for surface
mounting, titanium

Δ 6029/C37
As above,
with colour monitor

Interphones



6209
Interphone supplied
with 3 buttons
extendable to 6,
white

6209/153
As above, with
switching module
6153/682



6209/N53
Interphone supplied
with 3 black buttons
extendable to 6,
white



Δ 6209/21
Interphone supplied
with 3 buttons
extendable to 6,
anthracite



Δ 6209/37
Interphone supplied
with 3 buttons
extendable to 6,
titanio



6152
8 NO additional
push buttons for
interphones



692P
Pair of NO buttons for
additional function



692P/M
Pair of NO buttons
for additional device

692P/R
Pair of NO buttons
for opening lock



6153/682
4-position switching
module for setting
the volume mode

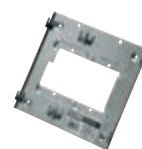

6145
Surface mounting
bracket for monitor
and interphone
mounting



6142
Desktop base for interphone
and monitor mounting,
2 m 13-conductor +
1 coaxial cable, white

Δ 6142/21
As above, anthracite



Δ 692T
Additional power supply
unit 230 V~ for parallel
desktop mounting
connection of monitor



6A92
Desktop base for
6029-6029/C, 2 m
of cable and socket
and plug, white

Δ 6A92/04
As above, black



6140
Desktop base for
interphone, 2 m
6-conductor cable
and terminal block,
white

Δ 6140/21
As above,
anthracite

Δ 6140/37
As above, titanium



6A40
Desktop base for
interphone, 2 m
16-conductor cable,
white

Δ 6A40/21
As above,
anthracite

Δ 6A40/37
As above, titanium

Due Fili Plus technology

8870 series: interphones

Interphones



8879
Interphone for surface mounting with 2 buttons, white



▲ **8879/D**
Interphone for surface mounting with 2 buttons, with teleloop, white

6900 series: interphones

Interphones



6901
2-channel hands-free interphone with 4 main and 6 additional buttons, white

6901/D
As above, with function for hearing aid wearers

Additional devices

Porter switchboard



40510
Porter switchboard with 7" LCD monitor, electronic contact list, calls and alarms displaying and management and services programmes

Due Fili Plus technology

Additional devices

Power supplies



40101
Entry system supply unit,
28 Vdc, 110-240 V~
50/60 Hz



6922.1
Video entry system supply
unit, 30 Vdc, 110-240 V~
50/60 Hz



6923
Additional video entry
system supply unit,
28 Vdc, 230 V~ 50 Hz
15 VA

6923/117
As above, 117 V~



6582
Additional supply unit
for LED and cameras,
10,5 Vdc, 13,5 Vdc
and 18 Vdc, 230 V~
50/60 Hz 35 VA

6582/240
As above, 240 V~



6982
Additional supply unit
for external cameras
230 V~ 50 Hz

Due Fili Plus + Digibus interface



69DM
Due Fili Plus pillar Digibus
back interface

69DM.EN
As above,
English version

Expansion interface



69RS
Expansion interface
to manage up to 200
inner stations

Separator



692S
Separator for dividing
conversation areas

Pillar divider



69DV
Pillar divider
for 4 pillar lines



69DV/5
Pillar divider for 4 pillar
lines for category 5
system

Video distributor



692D
Passive floor distributor
for adapting video signal
impedance

Due Fili Plus technology

Additional devices

Concentrators and selectors



69MX
Concentrator for up to 4 entrance panels parallel connection



69MX/5
Concentrator for up to 4 entrance panels parallel connection for category 5 system



69AM
Audio/video selector for connection of 4 cameras



69AM/4
Audio/video selector for 4 cameras, allows expansion of the number of cameras



69AM/T
Video selector for 4 cameras in the system



■ **69AM/T4**
Video selector for 4 cameras, allows expansion of the number of cameras

69AM/T.EN
As above,
English version

69AM/T.FR
As above,
French version

Amplifiers



692M
Video signal riser amplifier



692M/5
Video signal riser amplifier for category 5 system



69MD
Interface for Digital/audio-video signal change for users

69MD.EN
As above,
English version

Audio/video converter

Protection device



692E
Overvoltage protection device

Configurator



950C
Portable system configurator

Interfaces



692I
PC interface with RS232 connector and software for system configuration



692I/U
PC interface with USB port and software for system configuration



6120
Interface for 2 remote controls

Due Fili Plus technology

Additional devices

Relays



69PH
Programmable device
with 2 6 A 230 V~
change-over relays



69RH
Programmable device
with 2 NO 3 A 230 V~
relays for 2 independent
auxiliary controls



69RH/L
Programmable device
with 2 NO 3 A 230 V~
time-delay relays



0170/101
3 A 230 V~ change-over
relay for call repetition

Chime



860A
Electronic chime,
2 entrances, 230 V~

860A.240
As above, 240 V~

Cables



732H.E.100
Cable for internal
laying, PVC-sheath,
Eca, 100 m

732H.E.500
As above,
500 m

732I.E.100
Cable for external
laying, LSZH-sheath,
Eca, 100 m

732I.E.500
As above,
500 m



Viale Vicenza, 14
36063 Marostica VI - Italy
Tel. +39 0424 488 600
Fax +39 0424 488 709
www.vimar.com